

SprayMaster[®]

with Pro-Air System
575, 750 & 1000

OWNERS MANUAL



SealMaster[®]



Pavement Products & Equipment

PO Box 2277 • Sandusky, Ohio 44870 • 419-626-4375

sealmaster.net

SPRAY MASTER WITH PRO-AIR

Owner's Manual

Version 3.3

Issue Date: October 2024

Effective Date: January 2018

Version	Date	Changes	Approval
1.0		Original Issue	
2.0	4/19	New Format and Updates	DS
2.1	5/19	Corrected Part Num. A6	EK
2.2	6/19	Updated Wiring Diagrams	EK
2.3	1/22	Change Engine Oil – Note	JG
2.4	4/22	Added Paint Page	JG
2.5	5/22	Breakaway Kit Change	JG
2.6	7/22	Pilot Unloader Valve Location	JG
2.7	9/22	2" ARO Parts Updates	JG
	9/22	Water Tank Parts Added	JG
2.8	10/22	Ramp and Agitation Motor	JG
2.9	3/23	Pump & Compressor Info	JG
3.0	5/23	Pump Shaft Coupler H10	JG
3.1	7/23	Added Basket Strainer Items	JG
3.2	9/23	Added Axle Information	JG
3.3	10/24	Note: Pre-check all lug nuts	JG

Table of Contents

CORRESPONDENCE	3
SealMaster® LIMITED WARRANTY	4
SAFETY PRECAUTIONS AND CAUTIONS	5
PRECAUTIONS.....	5
CAUTIONS.....	5
AIR SPRAY TANK OPERATING INSTRUCTIONS	6
1-BEFORE STARTING THE ENGINE	6
2-STARTING THE ENGINE	7
3-TO AGITATE THE MATERIAL.....	8
4-ADDING SAND	9
5-WHEN YOU ARE TRANSPORTING	9
6-RECIRCULATION.....	10
7-SPRAY WAND.....	11
8-SPRAY BAR.....	14
9-FILLING THE TANK FROM A DRUM OR ANOTHER TANK	16
10-FILLING A BUCKET.....	17
11-CLEANING THE BASKET STRAINER.....	17
12-WATER FLUSH.....	19
AIR OPERATION INSTRUCTIONS	22
FILLING THE TANK USING THE DIAPHRAGM PUMP	22
AIR SPRAY TANK MACHINE MAINTENANCE	24
MAINTENANCE SCHEDULE.....	24
HOW TO WINTERIZE YOUR EQUIPMENT.....	25
TROUBLE SHOOTING GUIDE.....	26
WIRING DIAGRAMS.....	28
ELECTRIC BRAKES AND RUNNING LIGHTS	28

TANK CAPACITY CHART	29
MATERIAL DEPTH AND GALLON VOLUME.....	29
AIR SPRAY TANK PICTURES.....	31
PICTURE 1	31
PICTURE 2	32
PICTURE 3	33
PICTURE 4	34
PICTURE 5 HYDRAULIC SCHEMATIC	35
PICTURE 6 AIR SCHEMATIC	36
AIR SPRAY TANK PARTS LIST.....	37
PARTS LIST FOR TR 575-SK 575	37
PARTS LIST FOR TR 750-SK 750	39
PARTS LIST FOR TR 1000-SK 1000	41
PARTS LIST FOR ARO 1-1/2" PUMP	43
PARTS LIST FOR ARO 2" PUMP	46
PARTS LIST FOR PRO-AIR COMPRESSOR ASSEMBLY	49
PARTS LIST FOR MAXX-AIR COMPRESSOR ASSEMBLY	51
PARTS LIST: MATERIAL PUMP & COMPRESSOR/HYD. PUMP ASSEMBLY	53
MAINTENANCE AND STORAGE	54
MAINTENANCE	54
STORAGE	54

ThorWorks Industries, Inc.

Purchased by _____ Model NO. _____

Company Name _____ Serial NO. _____

Address _____ Acceptance Date _____

City _____ State _____ Zip _____

CORRESPONDENCE

All Correspondence regarding this equipment, as well as general correspondence should be addressed to:

ThorWorks Industries, Inc.

PO Box 2277

Sandusky, OH 44870

In referring to the equipment, kindly state the Model Number, Serial Number and any part number involved



SealMaster® LIMITED WARRANTY

SealMaster warrants that its products are of quality material and workmanship. SealMaster agrees to replace, within a period of one (1) year from date of delivery, or at its option, repair, without charge, any part of their manufacture which proved defective. The repair or replacement will be free of charge F.O.B. Sandusky, Ohio, providing the damaged part or parts are returned, freight prepaid, to SealMaster and investigation shows such repair or replacement is made necessary by an inherent defect of material or workmanship.

It is hereby understood that engines, motors, pumps, or other components purchased by SealMaster for use on its equipment are not warranted by SealMaster and are sold only with the standard warranty of the manufacturer of that component.

SealMaster will make no allowances for repairs or alterations completed by outside sources unless authorization is in writing and approved by an authorized SealMaster representative.

Any claims for defective material or workmanship must be made prior to the expiration of thirty (30) days from the date failure occurs, and in all cases prior to the expiration of the warranty period of one (1) year. It is the intent of this paragraph to limit SealMaster's liability solely to the cost of replacement parts, F.O.B. factory, or at the option of SealMaster to repair of the defective part or parts. No allowances for damages, lost time, or any other claim will be recognized.

This warranty is null and void if other than genuine SealMaster parts are used.

SealMaster is constantly striving to improve their products. Changes in design and improvement will be made whenever the manufacturer believes the efficiency of the product will be improved, without incurring any obligation to incorporate such improvements in any machines which have been shipped or are in service.

In an effort to continue to improve product quality, SealMaster reserves the right to change specifications without notice.

Any modification or alteration of this machine without prior approval of the manufacturer may void this warranty.

SAFETY PRECAUTIONS AND CAUTIONS

PRECAUTIONS

- Always wear **eye** and **ear** protection, and **gloves**.
- Be aware of all **CAUTION AND WARNING** signs on the machine.
- Read all Owners Manuals that come with this Machine.
- Daily check the Engine, Air Compressor, and Hydraulic oil levels.
- Refer to Owners Manuals for proper types of oils.
- Make sure the operator is familiar with machine operation.
- Shut down the compressor engine before refilling the gas tank.
- Replace any hoses that show signs of wear, fraying, or splitting.
- Be sure all fittings and joints are tight and leakproof.
- Tighten all bolts and screws after every 100 hours of operation.
- The machine should not be left unattended when running.

CAUTIONS

- Do not operate the machine in an enclosed building or confined area.
- Keep hands, feet, and clothing away from moving parts.
- Do not operate the machine without all guards in place.
- Do not point the spray nozzle at another person.
- Wear eye protection when operating the spray wand or spray bar.

PRE-CHECK ALL LUG NUTS

- Pre-Check all lug nuts, and fasteners to ensure they remain tight after transit.

After every 100 Miles of Machine operation and each wheel removal, all wheel lug nuts are to be re-torqued to 110-foot lbs.



Lug nuts are recommended to be installed in an alternating pattern, commonly referred to as a star pattern, which ensures a uniform distribution of load across the wheel mounting surface.

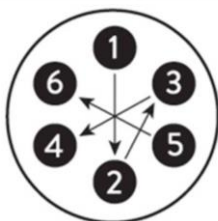

6 Lug Nut Wheel

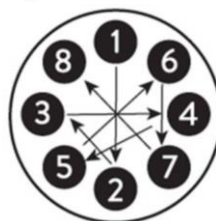

8 Lug Nut Wheel

SPRAY MASTER TANK TRAILER WITH PRO-AIR SYSTEM

APPLIES TO ALL PRO-AIR AND MAXX-AIR TRAILER AND SKID VERSIONS

AIR SPRAY TANK OPERATING INSTRUCTIONS

STARTUP

H1 HYDRAULIC OIL

H2 AGITATOR CONTROL

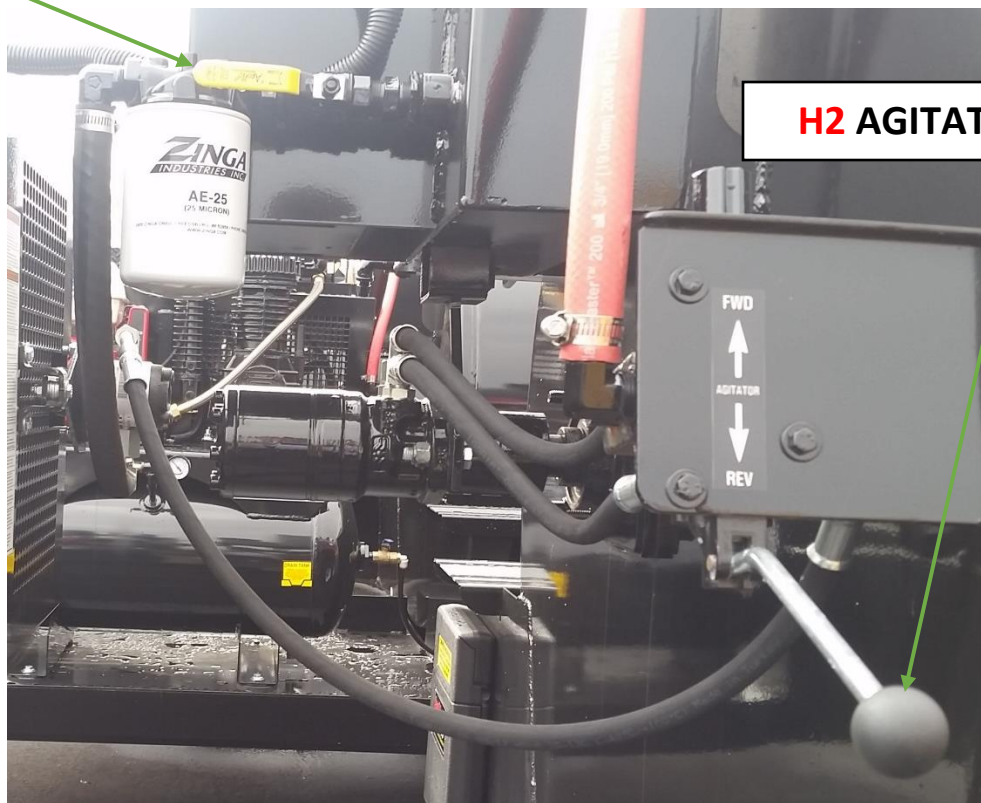

1-BEFORE STARTING THE ENGINE

- Make sure the agitator control valve **H2** is in the neutral position. Make sure hydraulic oil valve **H1** is open.

SPRAY MASTER TANK TRAILER WITH PRO-AIR SYSTEM

APPLIES TO ALL PRO-AIR AND MAXX-AIR TRAILER AND SKID VERSIONS

AIR SPRAY TANK OPERATING INSTRUCTIONS

STARTUP

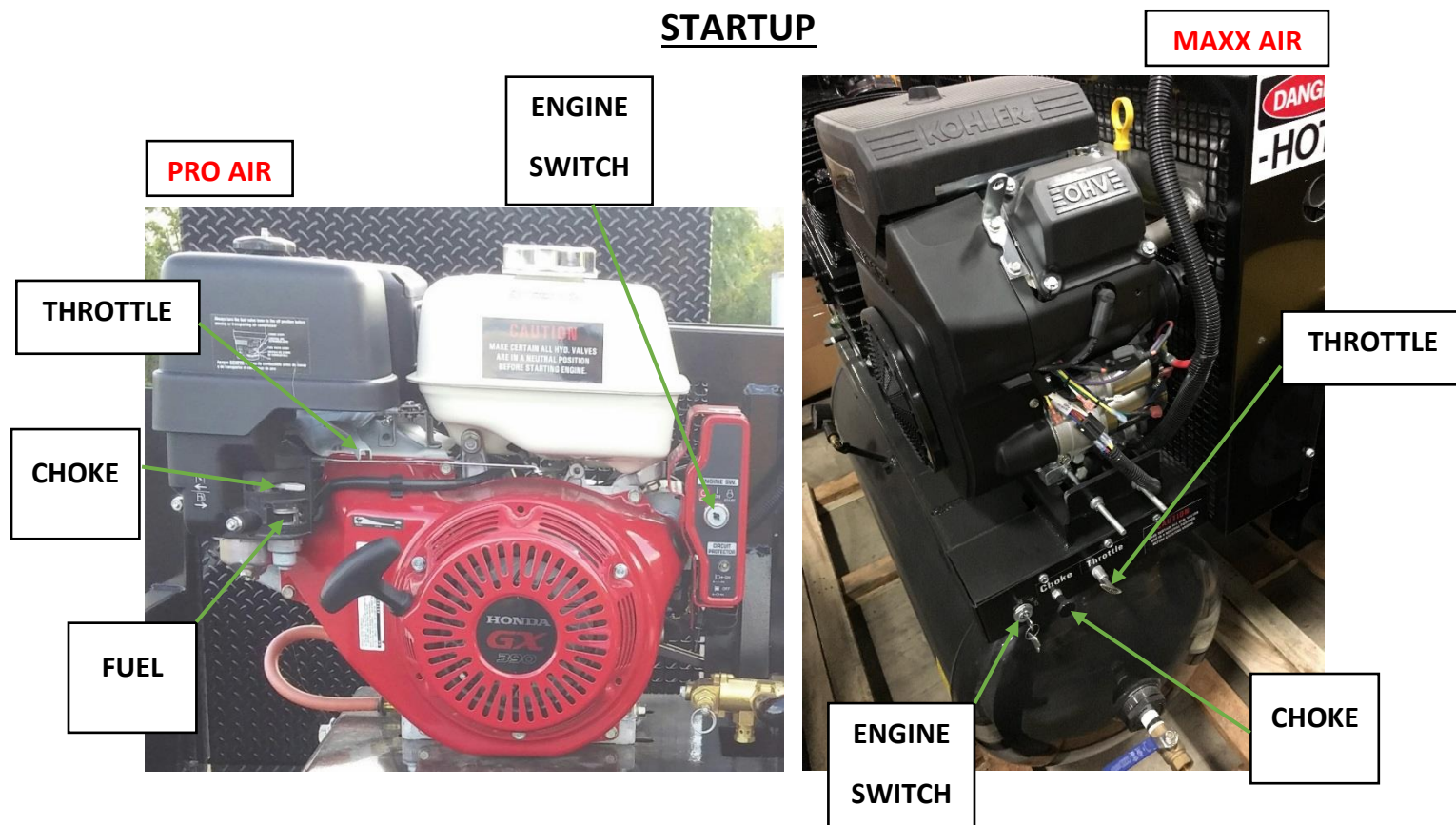

2-STARTING THE ENGINE

- Set the **fuel** shutoff and **choke** levers to the **on** position.
- Set the throttle lever at ½ open.
- Turn the **engine** switch to the start position.



- It is important that when you are done running the engine that the **fuel** shutoff lever is turned to the **off** position. This keeps gasoline from mixing with oil as you are driving.

Refer to the engine manual.

SPRAY MASTER TANK TRAILER WITH PRO-AIR SYSTEM

APPLIES TO ALL PRO-AIR AND MAXX-AIR TRAILER AND SKID VERSIONS

AIR SPRAY TANK OPERATING INSTRUCTIONS

MACHINE OPERATIONS

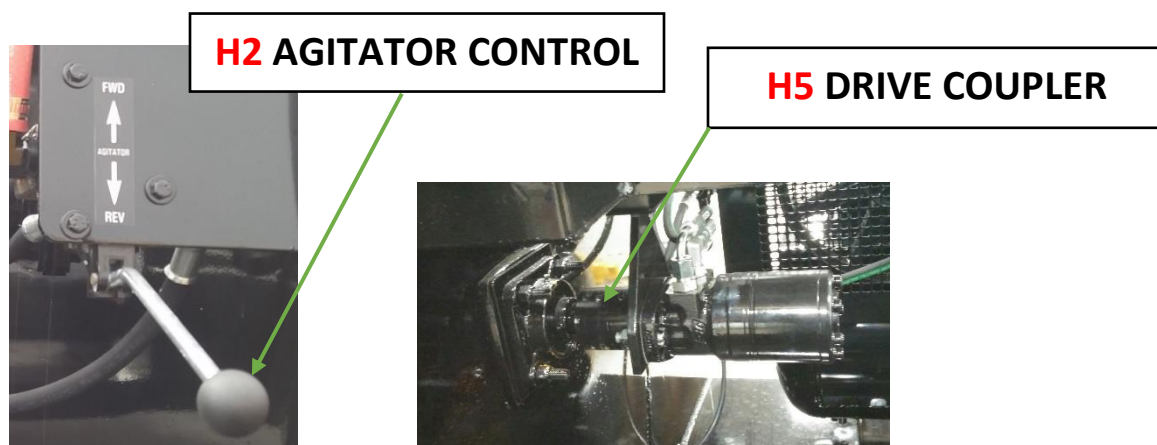

3-TO AGITATE THE MATERIAL

- Add the appropriate amount of sealer and water to the tank.
 - Slowly engage the agitator control valve H2 to the forward position.
 - If the agitator will not turn or bogs the engine down, move the lever to the neutral then the reverse position.
 - Repeat until the agitator makes a complete revolution.
 - For mixing purposes, rotation direction does not matter.
 - When you are standing on the fender and looking into the tank, set rotation toward you, to prevent splashing.
 - Before opening the lid, stop the agitator or at least slow down the speed. Speed is controlled by the valve lever.
- NEVER** change direction without first coming to a stop or you could **break** the drive coupler H5.

SPRAY MASTER TANK TRAILER WITH PRO-AIR SYSTEM

APPLIES TO ALL PRO-AIR AND MAXX-AIR TRAILER AND SKID VERSIONS

AIR SPRAY TANK OPERATING INSTRUCTIONS

MACHINE OPERATIONS

4-ADDING SAND

- When adding sand, the agitator must be rotating at a medium speed **SLOWLY** pour in the sand.
- If it stops rotating increase speed if that is not effective it needs to be cycled back and forth to get it going again.
- Once the sand is added, close the lid and let the agitator rotate at a medium to fast speed for a few minutes.
- Set to a slow speed when ready to start spraying.
- **WARNING** Never reach into the manhole with the agitator on.

5-WHEN YOU ARE TRANSPORTING

- When you are traveling from job to job and have a sand mix in the tank, it is important that you leave the **agitator ON**. If not, slowly the sand will settle to the bottom and pack. It is very difficult to get pack settled sand back into suspension.
- **NEVER** add sand without agitator running.

SPRAY MASTER TANK TRAILER WITH PRO-AIR SYSTEM

APPLIES TO ALL PRO-AIR AND MAXX-AIR TRAILER AND SKID VERSIONS

AIR SPRAY TANK OPERATING INSTRUCTIONS

6-RECIRCULATION

- This involves the pump drawing material out of the bottom of the tank and pumping it back in at the top.
- Be sure the product is mixed thoroughly before recirculating and before spraying the material.
- To recirculate, first open the main tank valve M1 and the recirculation valve M5.
- On the air diaphragm pump M9 is the air pressure regulator/water trap A5 and the pump air control valve A6.
- These valves turn the pump on and off, it's also used to adjust pump speed and volume.

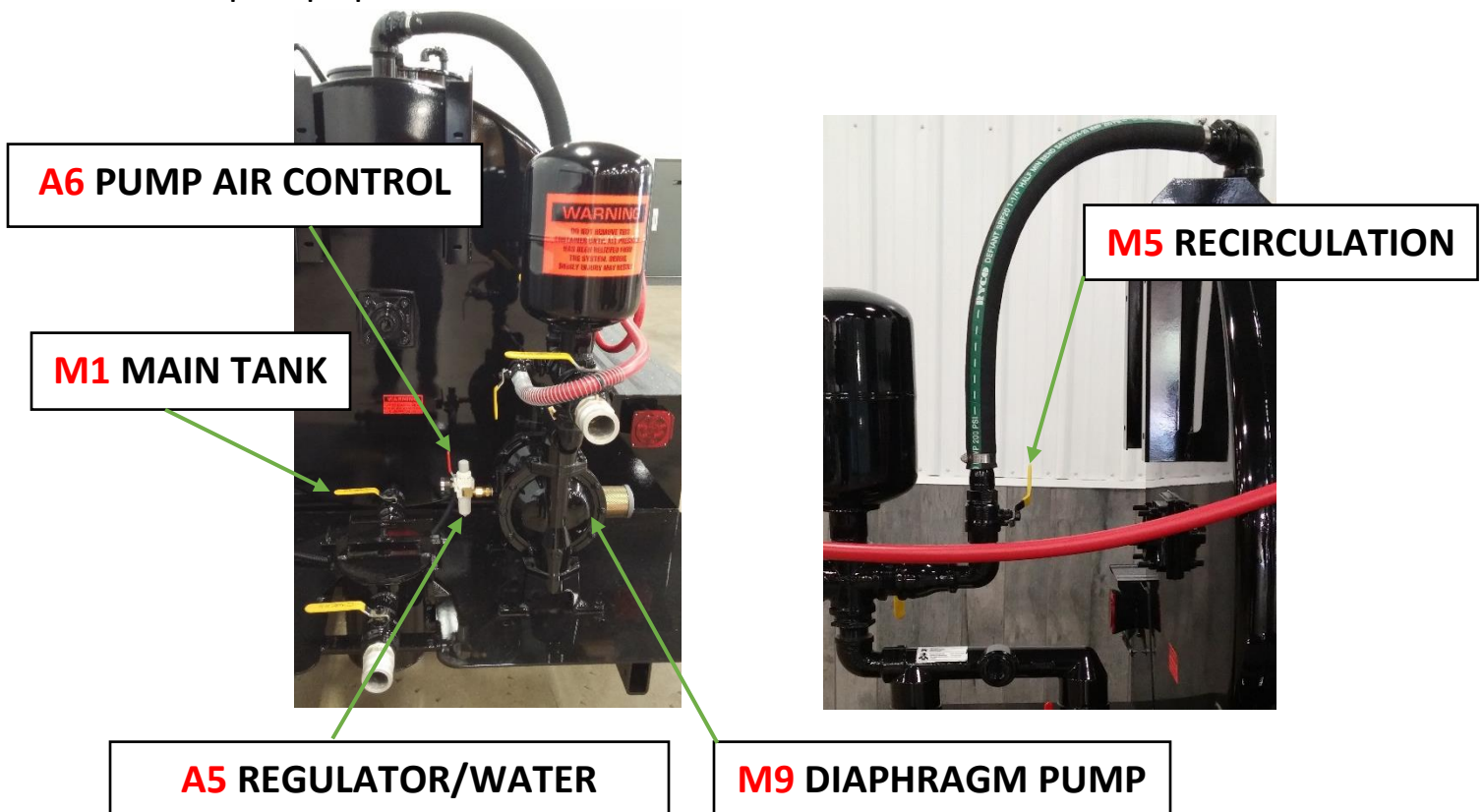

SPRAY MASTER TANK TRAILER WITH PRO-AIR SYSTEM

APPLIES TO ALL PRO-AIR AND MAXX-AIR TRAILER AND SKID VERSIONS

AIR SPRAY TANK OPERATING INSTRUCTIONS

MACHINE OPERATIONS

7-SPRAY WAND

- Once the recirculation process is done, close recirculation valve M5.
- The material diaphragm pump M9 will stop cycling and the pressure gauge regulator/water trap A5 will read the regulator setting.
- Start with 80 psi on the gauge.
- Remove the spray hose M11 from the side of the tank or hose reel and stretch it out, making sure there are no twists or kinks.
- Open spray hose feed valve M6 to pressurize the hose, then the spray wand valve M4. To start spraying. Hold the wand at waist level and overlap 50%. Walk side to side across the area to be sealed.
- When the material is coming out of the spray tip, you will feel the wand push up.
- The thickness of the material determines how much pressure is needed to properly atomize the material.
- Adjust the pressure setting on regulator/water trap A5 to get a proper spray pattern. To do this, turn the knob on top of regulator clockwise to increase pressure or counterclockwise to decrease.
- You may need to run the pressure at the maximum of 125 psi, depending on your material.

SPRAY MASTER TANK TRAILER WITH PRO-AIR SYSTEM

APPLIES TO ALL PRO-AIR AND MAXX-AIR TRAILER AND SKID VERSIONS

AIR SPRAY TANK OPERATING INSTRUCTIONS

MACHINE OPERATIONS

7-SPRAY WAND cont.

- Pump air control valve A6 determines how much air enters the diaphragm pump, and how fast it will cycle. Typically, this valve is open completely.
- The pump automatically slows down or speeds up depending on tip size or condition.
- When you close the spray wand valve M4, the pump will make a few cycles then stop.
- When the wand is opened, the pump will start pumping again. If it does not, bleed all of the air from the system and start over.
- If the pump still does not cycle, refer to the troubleshooting guide in the pump manual.
- Open spray wand valve M4 on the wand completely to make it last longer.
- The spray wand valve M4 and 80-70 spray tips M10 are wearing items and need to be replaced periodically.
- 80-70 or 80-100 spray tips M10 typically need to be replaced every 500 to 1000 gallons if using a sand mix.
- The center of the spray starts to get heavy as the tip wears. Using worn tips causes an inconstant spray pattern making it difficult to maintain a uniform coating.

SPRAY MASTER TANK TRAILER WITH PRO-AIR SYSTEM

APPLIES TO ALL PRO-AIR AND MAXX-AIR TRAILER AND SKID VERSIONS

AIR SPRAY TANK OPERATING INSTRUCTIONS

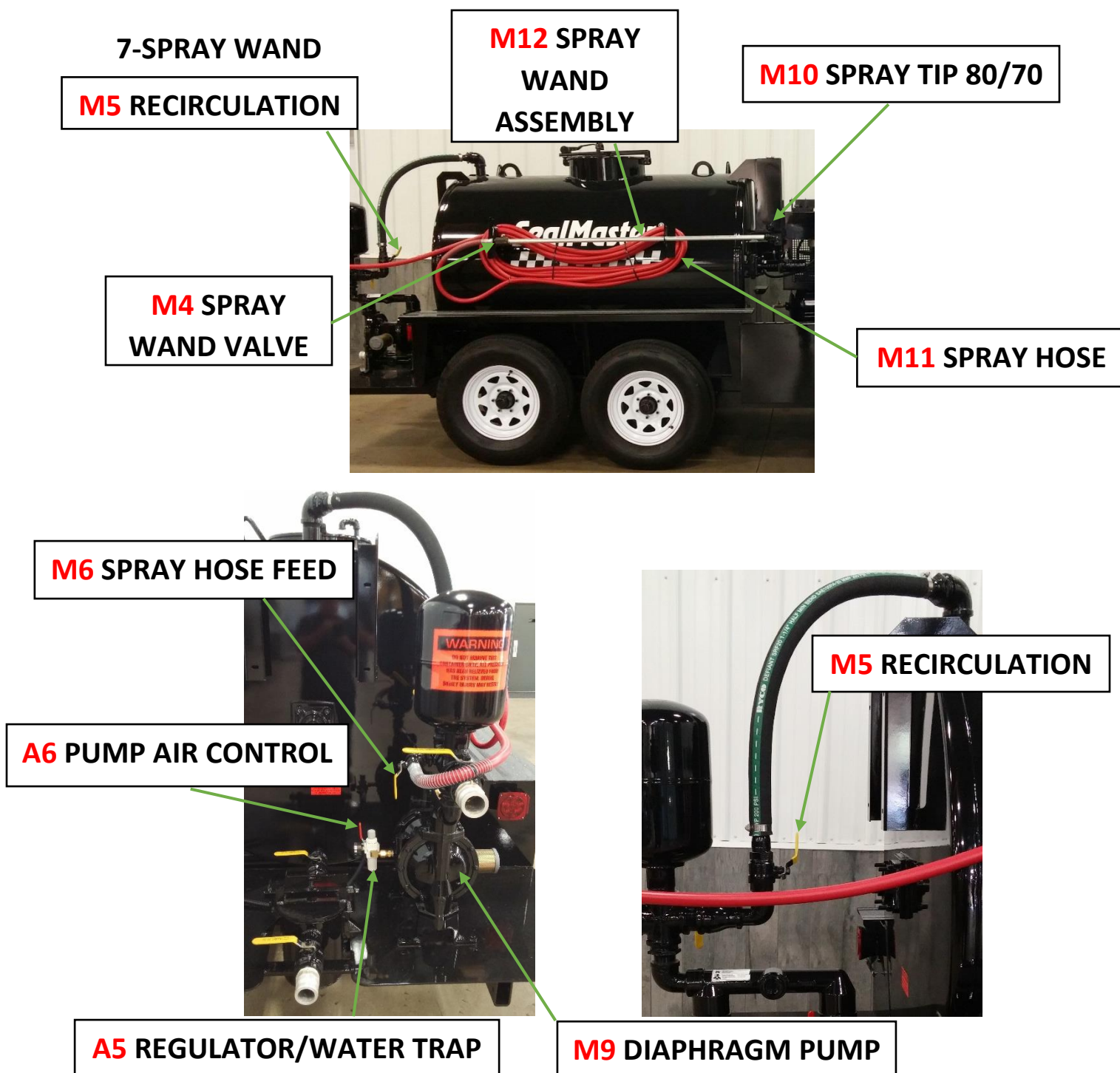

SPRAY MASTER TANK TRAILER WITH PRO-AIR SYSTEM

APPLIES TO ALL PRO-AIR AND MAXX-AIR TRAILER AND SKID VERSIONS

AIR SPRAY TANK OPERATING INSTRUCTIONS

8-SPRAY BAR

- The throttle on the compressor engine A1 needs to be set between 3/4 and full position to ensure there is enough air available for the diaphragm pump M9.
- Open spray tip valves M7 on the spray bar, after completing the recirculation process.
- Position the machine, motion for the driver to start forward at approx. 4mph, open spray bar feed valve M3, and also the (optional) spray bar lever, this opens all of the spray tip valves M7 at the same time, to start spraying.
- There will be a surge of material, the pump will cycle rapidly then slow to a regular cycle rate.
- To reduce the initial surge, move the spray bar lever slowly to control the flow.
- Control how fast the pump cycles by opening or closing the pump air control valve A6.
- Run the pump pressure at the lowest acceptable application pressure to reduce overspray.
- Control pressure by using the regulator/water trap A5.

Close spray bar feed valve M3 or the spray bar lever (optional) when you reach the end of your pass, leave all of the pump controls set. The pump will come back on when you open the spray bar valves. Position the tires right next to the previous pass, this will give you the proper overlap.

SPRAY MASTER TANK TRAILER WITH PRO-AIR SYSTEM

APPLIES TO ALL PRO-AIR AND MAXX-AIR TRAILER AND SKID VERSIONS

AIR SPRAY TANK OPERATING INSTRUCTIONS

MACHINE OPERATIONS

8-SPRAY BAR



M3 SPRAY BAR FEED

A1 COMPRESSOR ENGINE

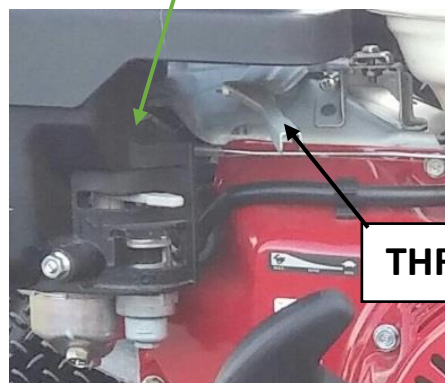

THROTTLE

A6 PUMP AIR CONTROL

M9 DIAPHRAGM PUMP

A5 REGULATOR/WATER TRAP

SPRAY MASTER TANK TRAILER WITH PRO-AIR SYSTEM

APPLIES TO ALL PRO-AIR AND MAXX-AIR TRAILER AND SKID VERSIONS

AIR SPRAY TANK OPERATING INSTRUCTIONS

9-FILLING THE TANK FROM A DRUM OR ANOTHER TANK

- Close the main tank valve **M1** and connect a 2" hose to gravity valve **M2** located on the basket strainer **M13**.
- Put the end of the hose into your drum or connect to the other tank.
- Open recirculation valve **M5** open pump air control valve **A6** located on material diaphragm pump **M9**.
- The material will go thru the basket strainer and be pumped up into the top of the tank.
- Reverse the steps when done.

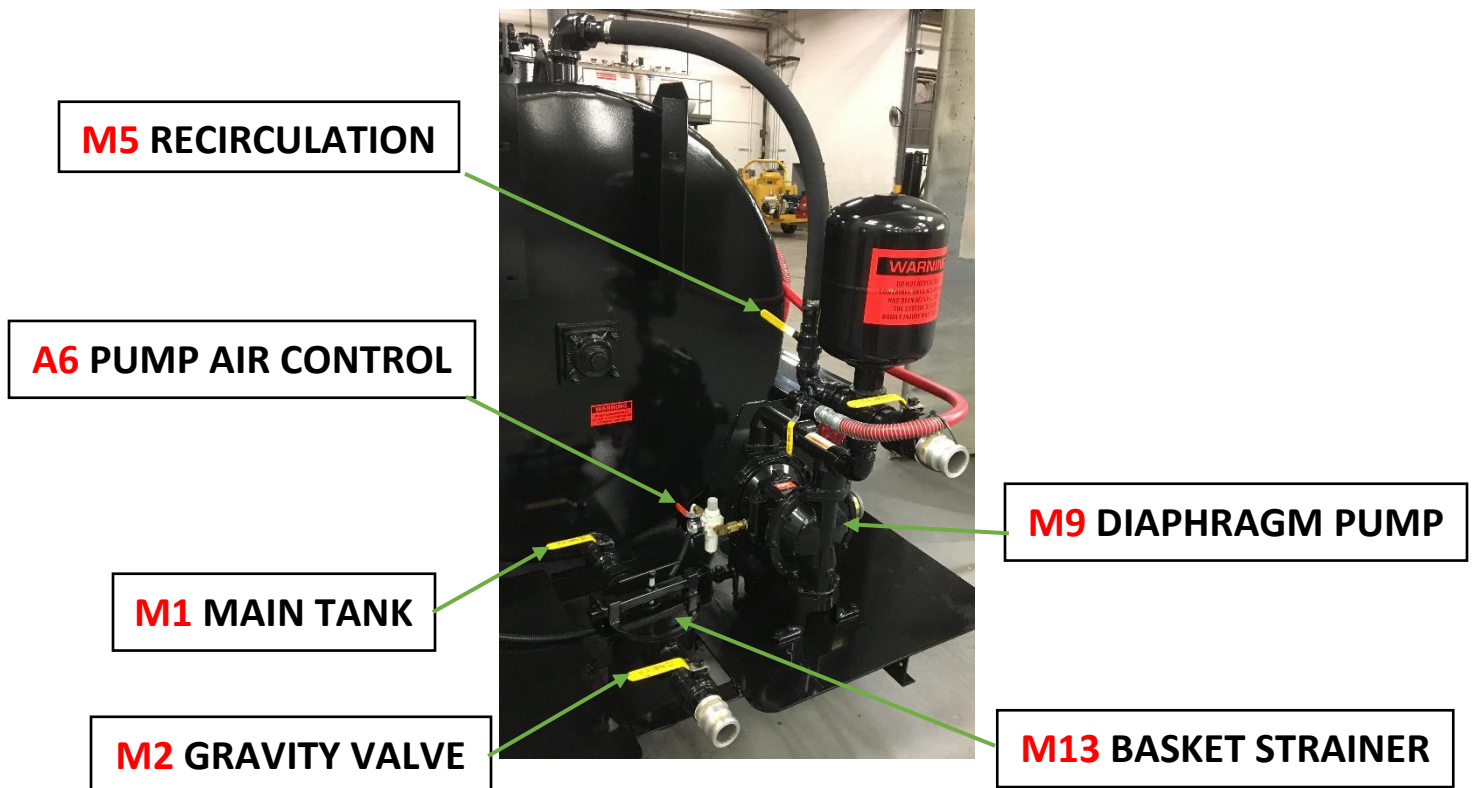

SPRAY MASTER TANK TRAILER WITH PRO-AIR SYSTEM

APPLIES TO ALL PRO-AIR AND MAXX-AIR TRAILER AND SKID VERSIONS

AIR SPRAY TANK OPERATING INSTRUCTIONS

MACHINE OPERATIONS

10-FILLING THE BUCKET

- You can fill a bucket for edging purposes by opening main tank valves M1 and gravity valve M2.

11-CLEANING THE BASKET STRAINER

- When you notice the spray pattern has started to decrease, or it is taking longer for the pump to stop when you close the spray wand or spray bar valves, the basket strainer M13 needs to be cleaned.
- It requires cleaning at least once a day and sometimes several times a day.
- Close main tank valve M1 and remove the lid assembly, it may be necessary to open gravity valve M2 to release vacuum or pry off the lid as the rubber gasket adheres to the housing.
- Reach in and pull the strainer basket P14 out and put it in a bucket of water.
- If the material is hard packed or dry, you will have to scrape with a screwdriver.
- It is advised to have a 2nd basket on hand. It can be replaced and returned to spraying while the first is being cleaned.

SPRAY MASTER TANK TRAILER WITH PRO-AIR SYSTEM

APPLIES TO ALL PRO-AIR AND MAXX-AIR TRAILER AND SKID VERSIONS

AIR SPRAY TANK OPERATING INSTRUCTIONS

12-WATER FLUSH

- It is not necessary to flush the system every day. We suggest removing the spray tip and plugging the wand.
- If the machine is going to be out of service for a week or more, then water flush the system.
- If outfitted with the water option, close main tank valve M1 and open the small water flush valve P15 that is on the basket strainer M13.
- Make sure the recirculation valve M5 is closed or you will pump water into your tank.
- Open pump air control valve A6 and either your spray wand valve M4 or spray bar feed valve M3. Pump until water runs clear.
- On basket strainer M13 is a water check valve P6, this keeps sealer from flowing into the water tank if you leave the valve open. Do not rely on this check valve to always operate properly, always close the water flush valve P15.
- If you do not have the water option, close main tank valve M1. Remove the lid assembly from the basket strainer M13.
- Open pump air control valve A6 and pour water in as it is being pumped to the spray wand or spray bar.

Note: Skid tank configuration is different from the trailer, but the operation is the same.

SPRAY MASTER TANK TRAILER WITH PRO-AIR SYSTEM

APPLIES TO ALL PRO-AIR AND MAXX-AIR TRAILER AND SKID VERSIONS

AIR SPRAY TANK OPERATING INSTRUCTIONS

MACHINE OPERATIONS

12-WATER FLUSH

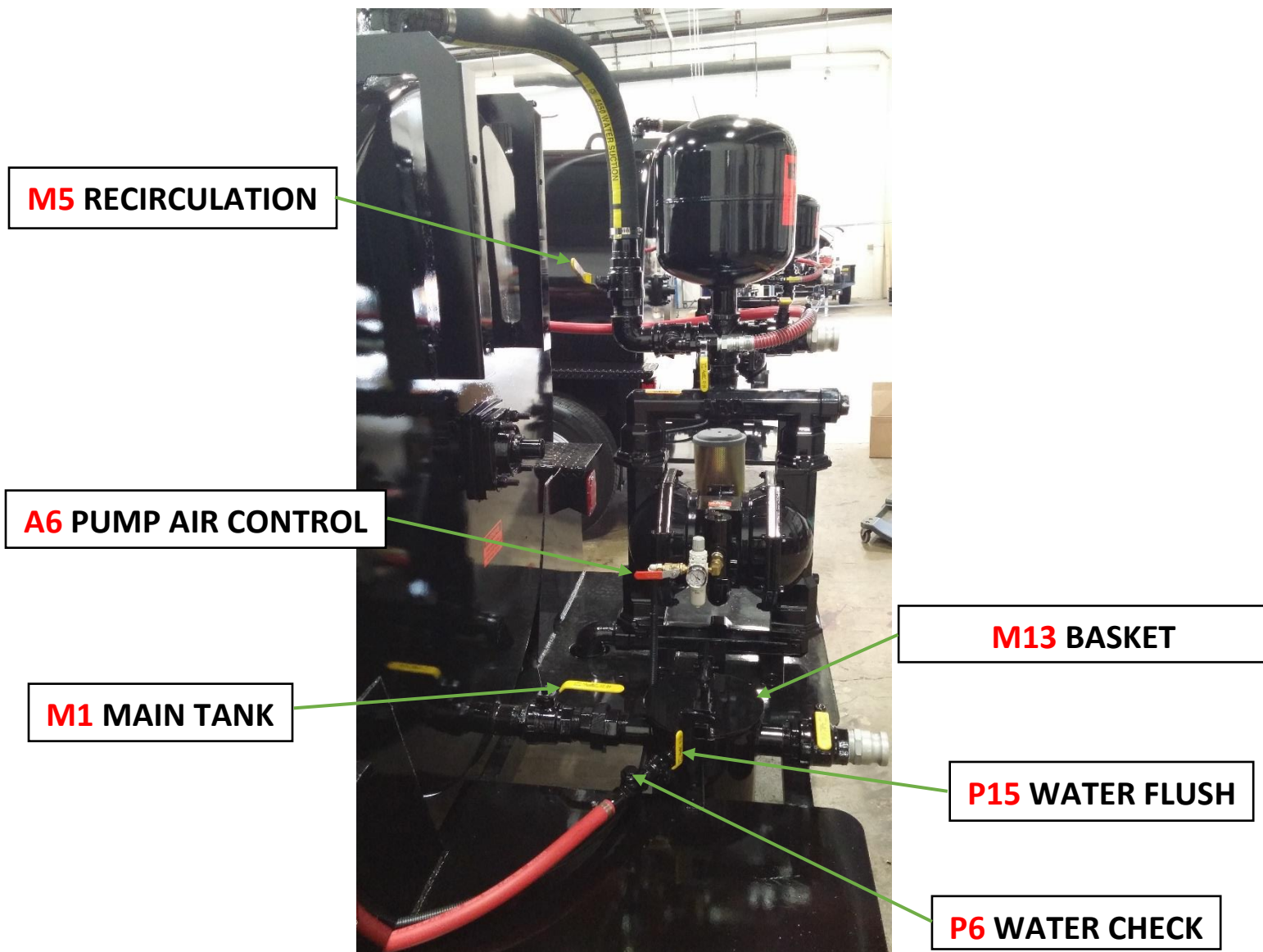

SPRAY MASTER TANK TRAILER WITH PRO-AIR SYSTEM

APPLIES TO ALL PRO-AIR AND MAXX-AIR TRAILER AND SKID VERSIONS

AIR SPRAY TANK OPERATING INSTRUCTIONS

MACHINE OPERATIONS

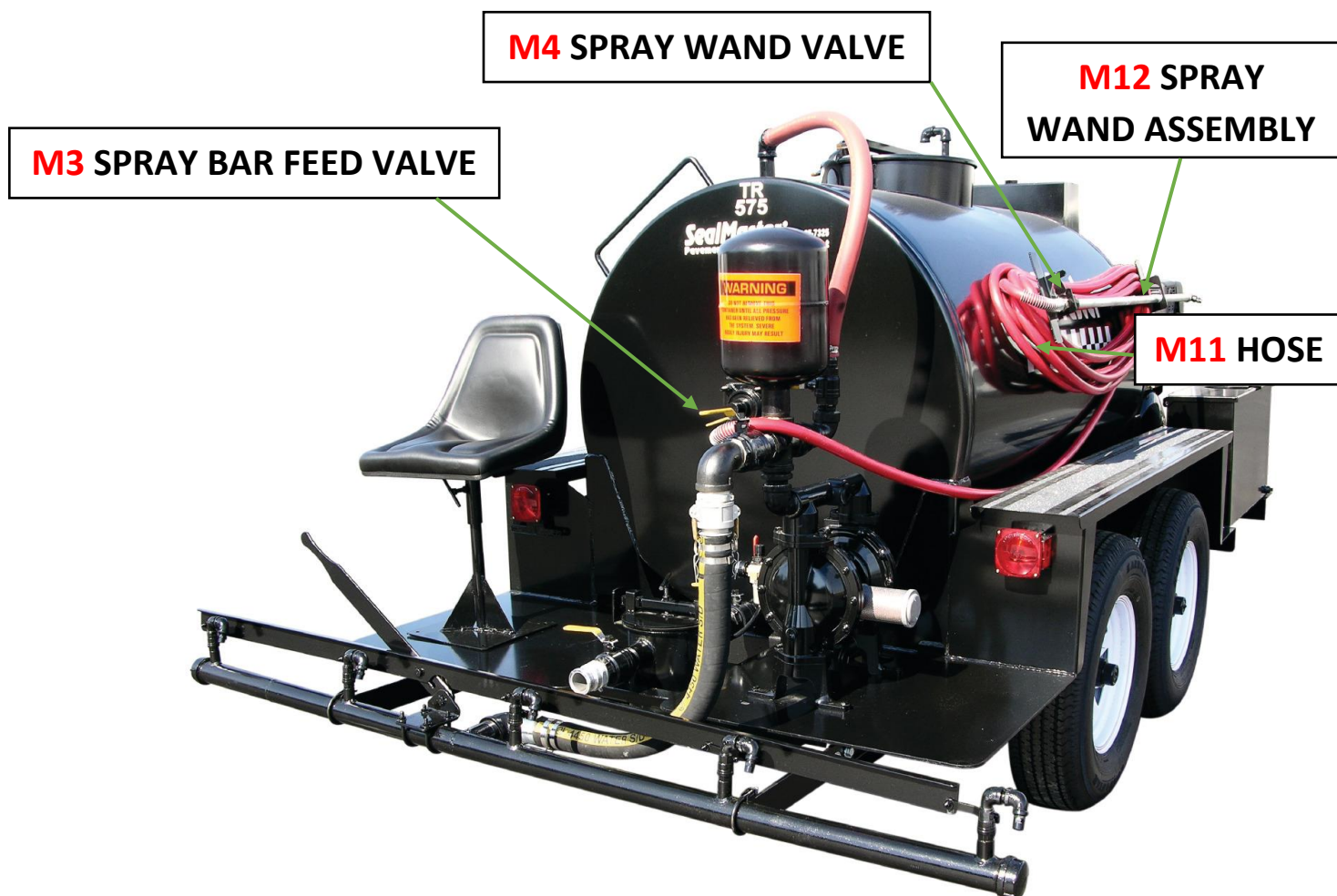

SPRAY MASTER TANK TRAILER WITH PRO-AIR SYSTEM

APPLIES TO ALL PRO-AIR AND MAXX-AIR TRAILER AND SKID VERSIONS

AIR SPRAY TANK OPERATING INSTRUCTIONS

AIR OPERATION INSTRUCTIONS

1. Completely read the air compressor owner's manual before attempting to start the engine.
2. Add gasoline to the engine. Check the oil levels in the engine and air compressor. Use only oil recommended for the air compressor.
3. Be sure the agitator control valve H2, is in **NEUTRAL** when starting the compressor.
4. Follow the start-up procedure listed in the air compressor manual.

FILLING THE TANK USING THE DIAPHRAGM PUMP

1. Connect your hose to gravity valve M2 and your source of material. Close main tank valve M1, spray bar feed valve M3 and spray hose feed valve M6.
2. Open gravity valve M2 and recirculation valve M5.
3. Start the compressor engine A1, and open pump control valve A6. The diaphragm pump M9 will now draw material into the basket filter. It will then enter the pump and be pushed up the return line attached to the top of the tank. When the tank is full, close gravity valve M2. Then close recirculation valve M5.
Add water and engage agitator control valve H2. It is a metering valve. (The farther the lever is moved, the faster the agitator will rotate). After the water has been blended in add sand and additives. Keep agitator rotating slowly.

SPRAY MASTER TANK TRAILER WITH PRO-AIR SYSTEM

APPLIES TO ALL PRO-AIR AND MAXX-AIR TRAILER AND SKID VERSIONS

MACHINE OPERATIONS

M5 RECIRCULATION

**A6 PUMP
CONTROL VALVE**

M1 MAIN TANK

M2 GRAVITY VALVE

M3 SPRAY BAR FEED

M6 SPRAY HOSE FEED

M9 DIAPHRAGM PUMP

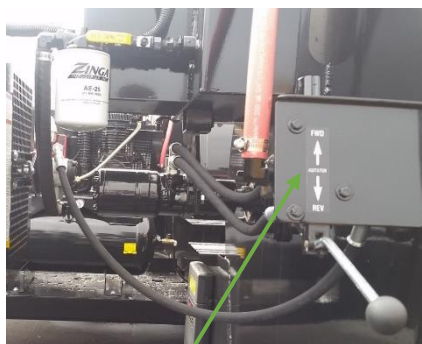

H2 AGITATOR CONTROL



A1 COMPRESSOR ENGINE

SPRAY MASTER TANK TRAILER WITH PRO-AIR SYSTEM

APPLIES TO ALL PRO-AIR AND MAXX-AIR TRAILER AND SKID VERSIONS

AIR SPRAY TANK MACHINE MAINTENANCE MAINTENANCE SCHEDULE

Follow maintenance procedures listed in the engine and compressor manuals.

MAINTAIN	8 HRS	1 WEEK	1 MONTH	6 MONTHS	1 YEAR	2 YEARS
CHECK ENGINE OIL LEVELS	✓					
CHECK COMPRESSOR OIL LEVELS	✓					
CHECK HYDRAULIC OIL LEVELS	✓					
CHANGE COMPRESSOR OIL *2				See Note*		
TIGHTEN V-BELT	✓	✓	✓			
REPLACE V-BELT					✓	
CHANGE ENGINE OIL *1				See Note*		
CHANGE HYDRAULIC. OIL FILTER					✓	
CHANGE HYDRAULIC. OIL *						✓
GREASE AGITATOR BEARINGS				✓		
DRAIN WATER FROM COMPRESSOR		✓				
DRAIN WATER FROM REGULATOR	✓					
CHECK TIRE PRESSURE CHECK TIRE LUG NUTS			✓	100 Miles		
GREASE PIVOT BRACKET					✓	
GREASE WHEEL BEARINGS					✓	
INSPECT ALL HOSES	✓					

* Use a good quality AW68 hydraulic oil with a rating of 352 SUS @100 F. Do not use a 150 rated hydraulic oil as it is too light.

CHANGE ENGINE OIL*1 OIL SPECIFICATIONS / REFER TO ENGINE MANUAL Honda Recommends 20hrs Initial Start / every 100hrs or 6 mons. After

***2 CHANGE COMPRESSOR OIL - OIL SPECIFICATIONS** / REFER TO COMPRESSOR MANUAL
Rol air Recommends **50hrs Initial Start** / every 200hrs - 400hrs After

SPRAY MASTER TANK TRAILER WITH PRO-AIR SYSTEM

APPLIES TO ALL PRO-AIR AND MAXX-AIR TRAILER AND SKID VERSIONS

AIR SPRAY TANK MACHINE MAINTENANCE

HOW TO WINTERIZE YOUR EQUIPMENT

1. Add water to the tank and let it agitate at a high speed for 30 minutes. Pump this water through the spray wand and or spray bar. When the tank is empty, make a 50/50 mixture of antifreeze and water approx. 4-gals, pour this into the tank. Turn on the material pump and open the spray wand and spray bar until the mixture starts to come out. Open the recirculation valve for a brief moment, then close it. The entire pumping system is now protected from freezing.
2. If you have a water tank and pump, run antifreeze through this also.
3. Disconnect the battery and take it inside. A battery charging maintainer will ensure that it lasts through the offseason.
4. Cover the engine and compressor with a plastic bag.
5. Cover the cap on top of the hydraulic tank.
6. In the spring flush all antifreeze from the system. When the temperature is below freezing in the winter, get inside the tank with proper hearing protection and an air chipping gun with a 1" spade bit and chip off all remaining sealer from the walls and paddles.

NOTE: If you do not do this, the dried material will come off all during the season causing the basket strainer and spray tips to plug.

SPRAY MASTER TANK TRAILER WITH PRO-AIR SYSTEM

APPLIES TO ALL PRO-AIR AND MAXX-AIR TRAILER AND SKID VERSIONS

AIR SPRAY TANK MACHINE MAINTENANCE

TROUBLE SHOOTING GUIDE

PROBLEM	POSSIBLE CAUSES/SOLUTIONS
AGITATOR DOES NOT ROTATE	SHUTOFF VALVE IS CLOSED / OPEN
	HYDRAULIC OIL LOW / OIL LEVEL 4" FROM TOP OF TANK
	COUPLER / REPLACE THE SHEARED KEY
	HYDRAULIC PUMP / HAVE TESTED OR REPLACED
AIR COMPRESSOR NOT PRODUCING ENOUGH AIR OR PRESSURE	BELTS LOOSE / TIGHTEN THE BELTS
	PILOT UNLOADER VALVE / REFER TO OWNER'S MANUAL
	AIR COMPRESSOR / DRAIN OUT WATER WEEKLY
ENGINE	OIL SPECIFICATIONS / REFER TO OWNER'S MANUAL
	OPERATING INSTRUCTIONS / REFER TO OWNER'S MANUAL
	FUEL IN OIL CRANKCASE / FUEL SHUT-OFF VALVE IN OFF POSITION WHEN FINISHED
MATERIAL PUMP MATERIAL FLOW IS REDUCED	BASKET STRAINER IS PLUGGED / UNPLUG
	PLUMBING LEADING TO PUMP IS PLUGGED / UNPLUG
	PUMP WORN / NEEDS NEW BALLS AND BALL SEATS REPLACED
	MATERIAL TOO THICK/ THIN WITH WATER
MATERIAL PUMP WILL NOT CYCLE	AIR VALVE IS PLUGGED / CLEAN AND LUBRICATE
MATERIAL PUMP AIR COMING OUT OF SPRAY TIP	DIAPHRAGM HAS TEAR / REPLACE ONE OR BOTH
	LOOSE FITTINGS ON SUCTION LINE / TIGHTEN
	BASKET STRAINER LID GASKET / SEAT PROPERLY
MATERIAL PUMP SEALER COMING OUT	DIAPHRAGM IS LOOSE / REPLACE ONE OR BOTH
MATERIAL PUMP AIR COMING OUT OF PUMP	AIR VALVE WORN / REPLACE VALVE
	CHECK VALVE WORN / REPLACE VALVE
MATERIAL PUMP DOES NOT STALL WHEN SPRAY WAND IS CLOSED	BASKET STRAINER IS PLUGGED / UNPLUG
	PLUMBING LEADING TO PUMP IS PLUGGED / UNPLUG

SPRAY MASTER TANK TRAILER WITH PRO-AIR SYSTEM

APPLIES TO ALL PRO-AIR AND MAXX-AIR TRAILER AND SKID VERSIONS

AIR SPRAY TANK MACHINE MAINTENANCE

TROUBLE SHOOTING GUIDE

PROBLEM	POSSIBLE CAUSES/SOLUTIONS
AIR REGULATOR DROPS PRESSURE	MATERIAL TOO THICK/ THIN WITH WATER
	CHECK VALVE IS DAMAGED / INSPECT BALLS AND BALL SEATS
SURGE TANK - NOTE EXCESSIVE PULSATION	TANK PLUGGED / CLEAN OUT TANK
BASKET STRAINER EXCESSIVE PLUGGING	MATERIAL CHUNKS/ EMPTY TANK-FLUSH WITH WATER
	EXCESSIVE SAND / LACK OF SEALER VISCOSITY MODIFIER
	MATERIAL / TOO MUCH WATER HAS BEEN ADDED
WATER TANK - OPTIONAL EXCESSIVE PULSATION	CHECK VALVE OPEN / CLOSE CHECK VALVE

SURGE TANK – **NOTE**

WEARING OF A FACE SHIELD IS RECOMMENDED

PRESSURE CAN BE RELIEVED FROM SYSTEM BY OPENING THE SPRAY WAND AND RECIRCULATION VALVES, ALSO IF THERE IS A (**OPTIONAL**) SPRAY BAR, OPEN THE SPRAY BAR FEED VALVE.

KEEP IN MIND THE PLUMBING CONNECTING THE PUMP TO THE SURGE TANK COULD ALSO BE PLUGGED, AND THERE MAY BE RESIDUAL PRESSURE STILL IN THE SYSTEM.

WIRING DIAGRAMS

ELECTRIC BRAKES AND RUNNING LIGHTS

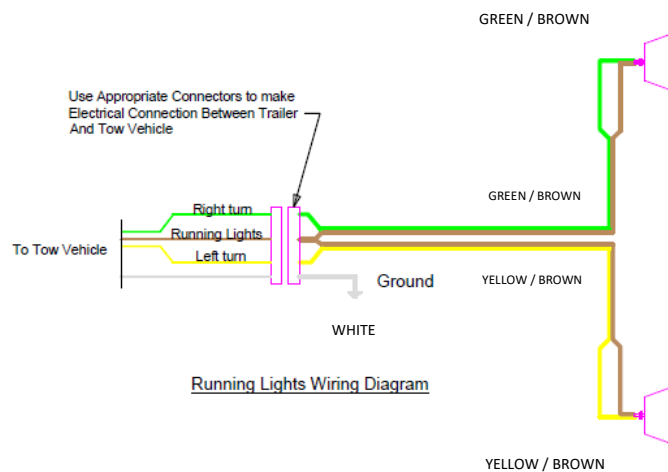
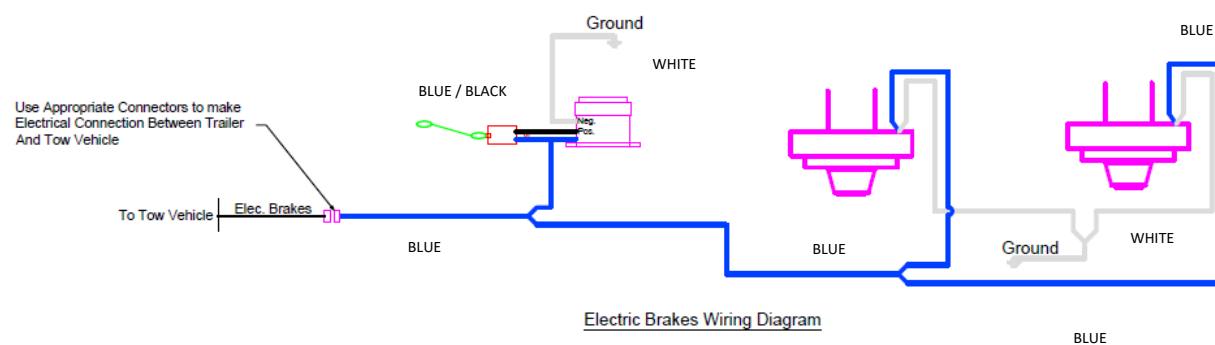

TANK CAPACITY CHART					
GALLONS ARE APPROXIMATE AND MAY VARY SLIGHTLY TANK TO TANK					
MATERIAL DEPTH AND GALLON VOLUME					
MATERIAL DEPTH	300 GALLONS 41"x54"	575 GALLONS 48"x74"	750 GALLONS 56"x74"	1000 GALLONS 48"x132"	1000 GALLONS 64"x74"
INCHES	GALLONS	GALLONS	GALLONS	GALLONS	GALLONS
1	2	3	3	5	3
2	6	8	9	15	10
3	10	15	16	27	18
4	15	23	25	41	27
5	21	32	35	57	37
6	28	42	45	75	49
7	35	52	57	93	61
8	42	64	69	113	74
9	50	75	82	134	88
10	58	87	95	156	103
11	67	100	109	179	118
12	75	113	124	202	134
13	84	127	139	226	150
14	93	141	154	251	167
15	102	155	170	276	184
16	112	169	186	302	201
17	121	184	202	328	219
18	130	199	219	354	238
19	140	214	236	381	256
20	150	229	253	408	275
21	159	244	270	435	294
22	169	259	288	462	314
23	178	274	305	490	333
24	188	290	323	517	353
25	197	305	341	544	373
26	206	321	359	572	393
27	216	336	377	599	413
28	225	351	395	626	433
29	233	366	412	653	454
30	242	381	430	680	474
31	250	396	448	706	495
32	258	411	466	732	515
33	266	425	484	758	536

MATERIAL DEPTH	300 GALLONS 41"x54"	575 GALLONS 48"x74"	750 GALLONS 56"x74"	1000 GALLONS 48"x132"	1000 GALLONS 64"x74"
INCHES	GALLONS	GALLONS	GALLONS	GALLONS	GALLONS
34	274	439	501	783	556
35	281	453	519	808	577
36	287	466	536	832	597
37	293	479	553	855	617
38	298	492	570	878	638
39	303	504	587	900	658
40	307	516	603	921	678
41	309	527	619	941	697
42		538	635	959	717
43		548	650	977	736
44		557	665	993	755
45		565	680	1007	774
46		571	694	1019	793
47		577	707	1029	811
48		580	720	1034	829
49			732		847
50			744		864
51			754		881
52			764		897
53			773		913
54			780		928
55			786		942
56			789		956
57					969
58					982
59					993
60					1004
61					1013
62					1021
63					1027
64					1031

SPRAY MASTER TANK TRAILER WITH PRO-AIR SYSTEM

APPLIES TO ALL PRO-AIR AND MAXX-AIR TRAILER AND SKID VERSION

AIR SPRAY TANK PICTURES

PARTS LIST

PICTURE 1

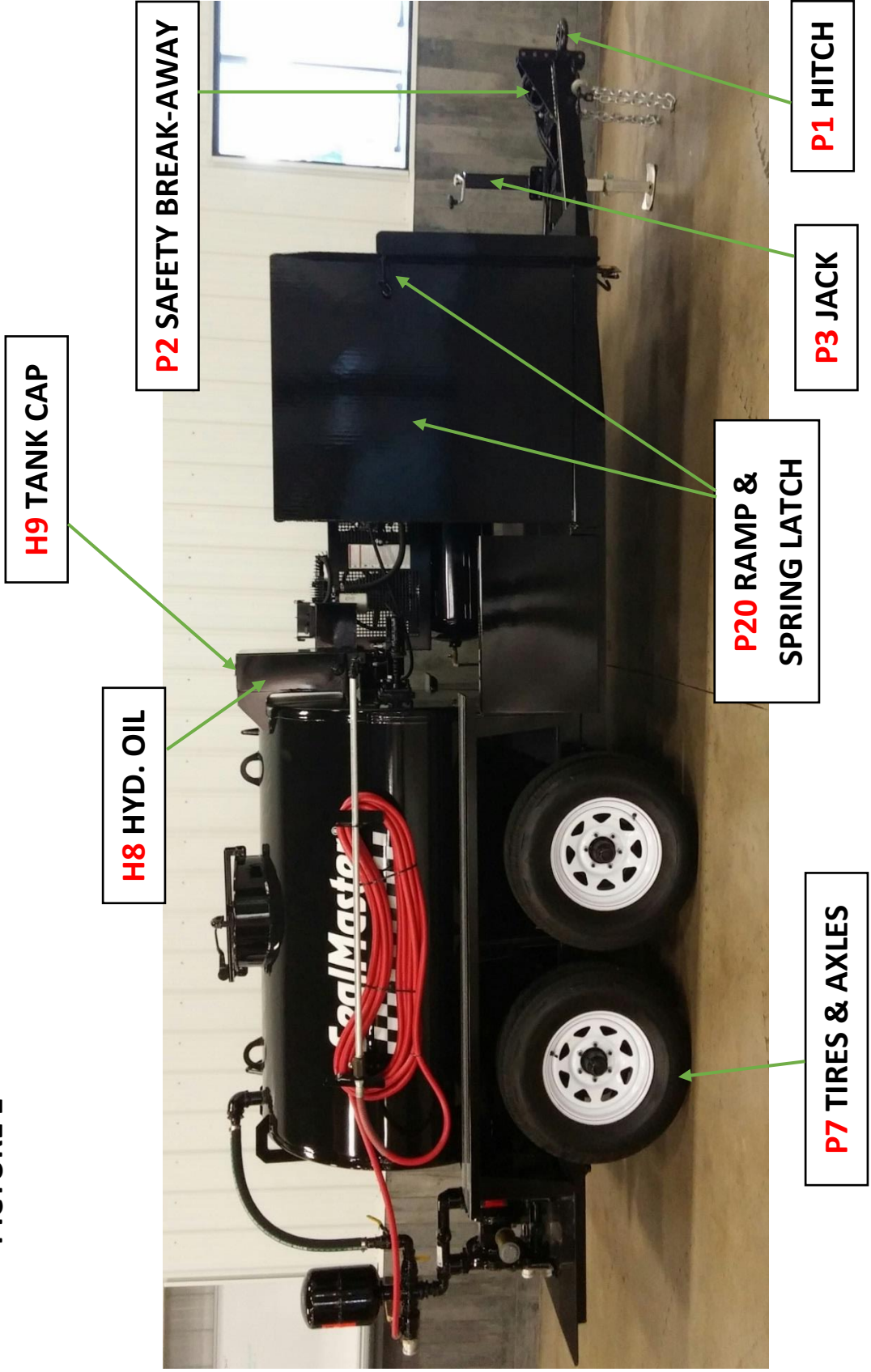

SPRAY MASTER TANK TRAILER WITH PRO-AIR SYSTEM

APPLIES TO ALL PRO-AIR AND MAXX-AIR TRAILER AND SKID VERSION

PARTS LIST

P5 WATER TANK

P16 RATCHET STRAP

P17 SUPPORT ANGLE

P4 WATER PUMP

P18 CAP

H4 HYD. DRIVE

H3 HYD. PUMP

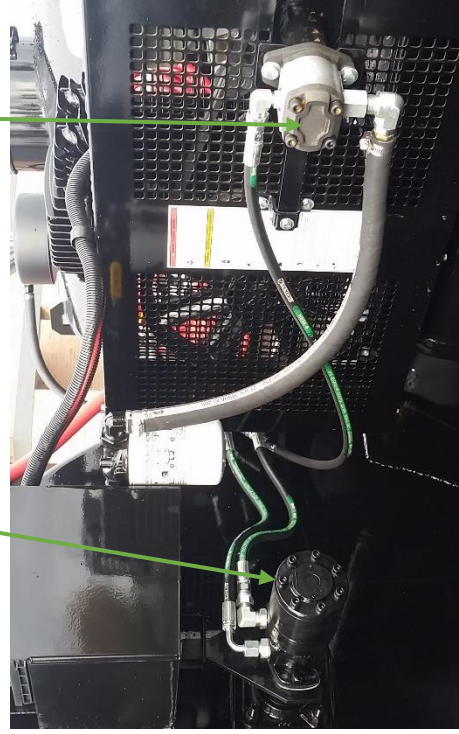
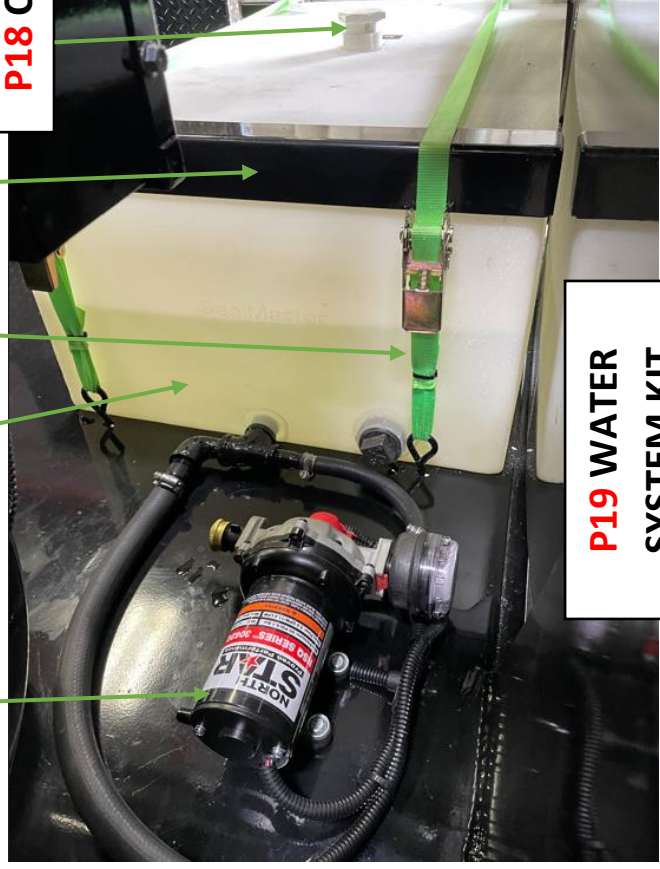

P19 WATER
SYSTEM KIT
COMPLETE

PICTURE 2

SPRAY MASTER TANK TRAILER WITH PRO-AIR SYSTEM

APPLIES TO ALL PRO-AIR AND MAXX-AIR TRAILER AND SKID VERSIONS

PARTS LIST

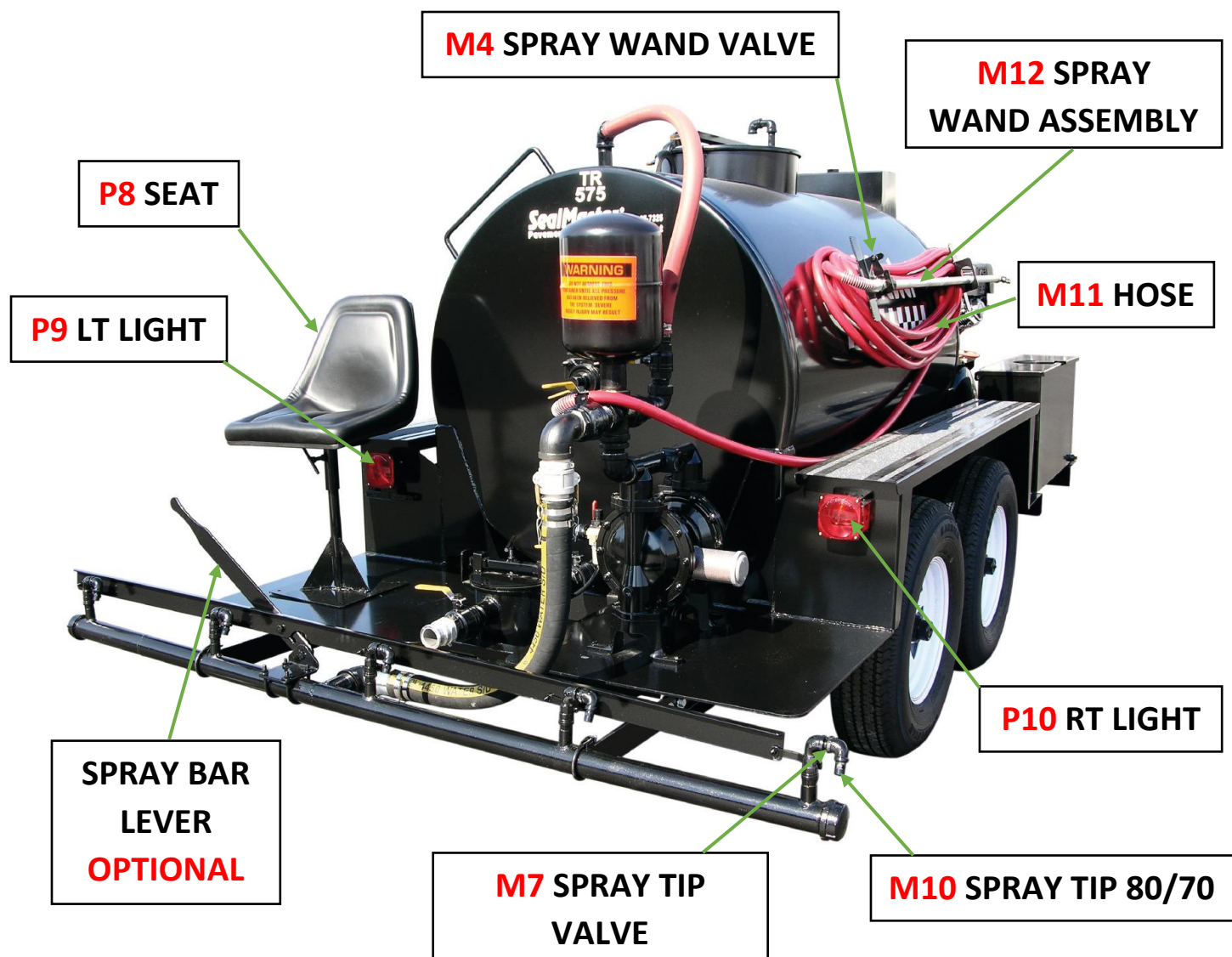

M11 HOSE REEL

PICTURE 3

SPRAY MASTER TANK TRAILER WITH PRO-AIR SYSTEM

APPLIES TO ALL PRO-AIR AND MAXX-AIR TRAILER AND SKID VERSIONS

PARTS LIST

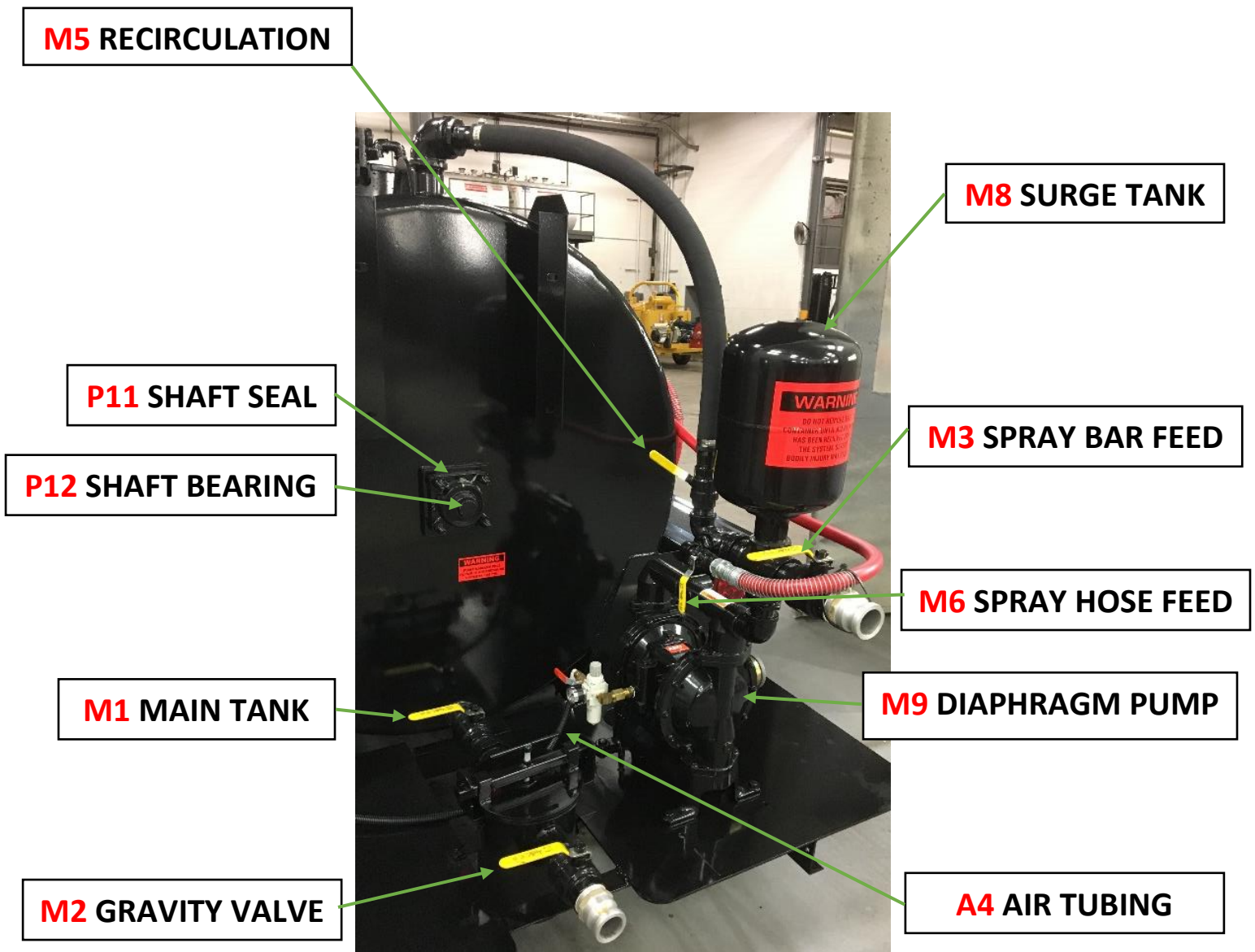

PICTURE 4

SPRAY MASTER TANK TRAILER WITH PRO-AIR SYSTEM

APPLIES TO ALL PRO-AIR AND MAXX-AIR TRAILER AND SKID VERSIONS

PICTURE 5 HYDRAULIC SCHEMATIC

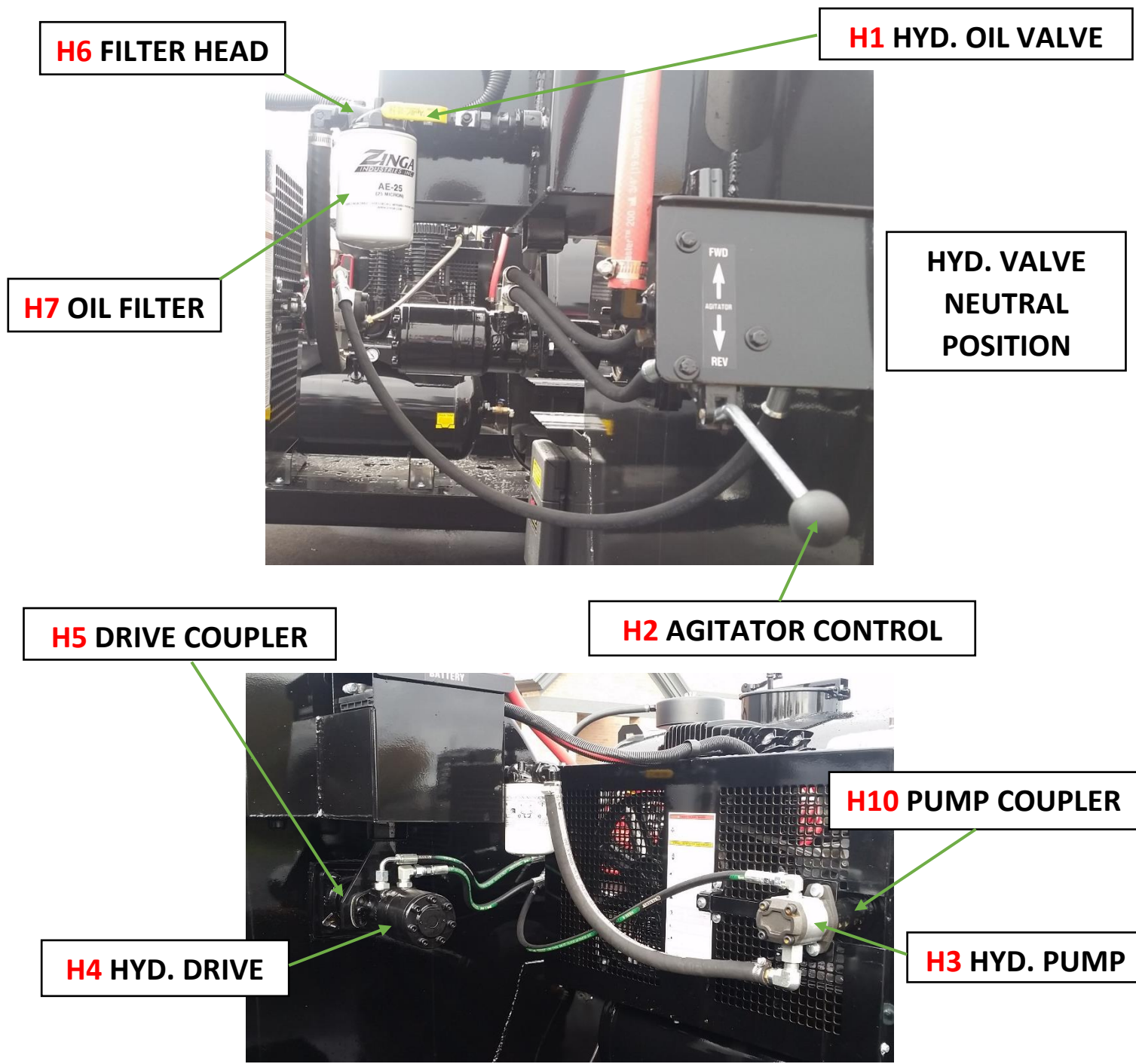

SPRAY MASTER TANK TRAILER WITH PRO-AIR SYSTEM

APPLIES TO ALL PRO-AIR AND MAXX-AIR TRAILER AND SKID VERSIONS

PARTS LIST

PICTURE 6 AIR SCHEMATIC

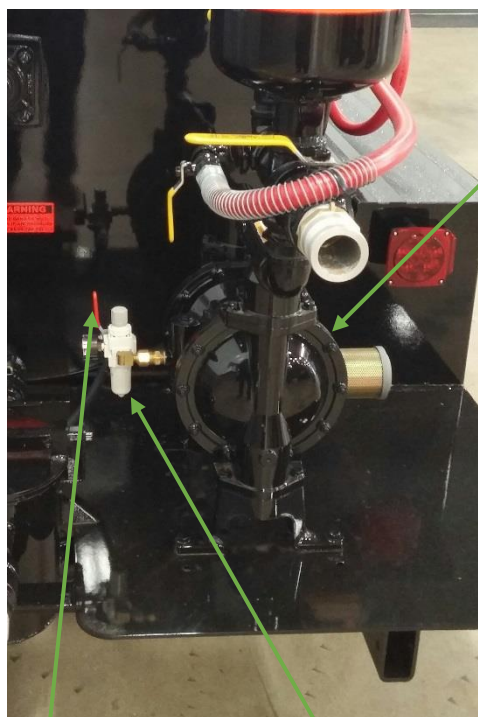

M9 DIAPHRAGM PUMP

A1 COMPRESSOR ENGINE



A6 PUMP CONTROL

A3 PRESSURE GAUGE

A5 REGULATOR/FILTER TRAP

A2 PILOT UNLOADER

H4 HYD. DRIVE

H11 SPROCKET 1-1/4" BORE

H12 SPROCKET 2" BORE

H13 #60 CHAIN

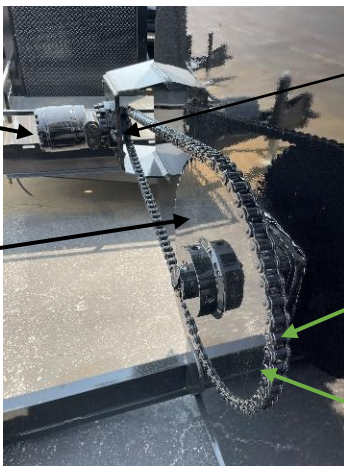

H14 CHAIN LINK
SPRING COUPLER #60

SPRAY MASTER TRAILER & SKID MOUNTED WITH PRO-AIR SYSTEM

APPLIES TO **TR 575 & SK 575** PRO-AIR AND **TR 575** PRO-AIR EXTENDED DECK

NOTE: WITH **MAXX-AIR** SYSTEM- SEE OPTIONAL PARTS LIST

AIR SPRAY TANK PARTS LIST

PARTS LIST FOR TR 575-SK 575

ITEM #	PART#	QTY.	DESCRIPTION
A1	P458A044	1	AIR COMPRESSOR ENGINE 13 HP
A2	P458C086	1	PILOT UNLOADER VALVE
A3	P458C063	1	PRESSURE GAUGE
A4	P709C000		POLY AIR TUBING "SOLD BY THE FOOT"
A5	P735A047	1	REGULATOR/WATER TRAP FILTER
A6	P397A033	1	PUMP CONTROL VALVE-1/4" BALL BRASS
M1	P397A002	1	MAIN TANK VALVE-2" BALL BRASS
M2	P397A002	1	GRAVITY VALVE-2" BALL BRASS
M3	P397A002	1	SPRAY BAR FEED VALVE-2" BALL BRASS
M4	P397A010	1	SPRAY WAND VALVE 3/4" BALL CARBON STEEL
M5	P397A012	1	RECIRCULATION VALVE-1-1/4" BALL BRASS
M6	P397A001	1	SPRAY HOSE FEED VALVE 3/4" BALL
M7	P397A009	5	SPRAY TIP VALVE-1/2" BALL BRASS
M8	P30003J	1	SURGE TANK
M9	P640A061	1	DIAPHRAGM PUMP-MATERIAL 1-1/2" ARO
M10	P449A004	6	SPRAY TIP 80/70 - 3/8" NPT STEEL
M11	P754B026	1	75' SPRAY HOSE ASSEMBLY
	P901A001	1	HOSE REEL – MANUAL - OPTIONAL
	P901A002	1	HOSE REEL – ELECTRIC - OPTIONAL
M12	P50273B	1	SPRAY WAND ASSEMBLY
M13	P50147B010	1	BASKET STRAINER ASSEMBLY
	P50147C009	1	1 GAL. HOUSING
M14	P482A007	1	2" HOSE ASSEMBLY - OPTIONAL
P4	P593A051	1	WATER PUMP 12V DC - OPTIONAL
P5	P596A002	1	WATER TANK - OPTIONAL
P6	P398A003	1	WATER CHECK VALVE - OPTIONAL
P8	P602A003	1	SEAT - OPTIONAL
P16	P422A006	2	RATCHET STRAP 1'x10' - OPTIONAL
P17	P72000C104	1	SUPPORT ANGLE - OPTIONAL
P18	P1008A012	1	CAP – WATER TANK - OPTIONAL
P19	P50330K	1	WATER SYSTEM KIT STANDARD - OPTIONAL
	P50330KED	1	WATER SYSTEM KIT EXTENDED DECK - OPTIONAL
P11	P50137B002	2	SHAFT SEAL 1-1/2" BORE
P12	P434A003	2	SHAFT BEARING 1-1/2" BORE
P13	P50119A	1	BASKET STRAINER SEAL

SPRAY MASTER TRAILER & SKID MOUNTED WITH PRO-AIR SYSTEM

APPLIES TO **TR 575 & SK 575** PRO-AIR AND **TR 575** PRO-AIR EXTENDED DECK

NOTE: WITH **MAXX-AIR** SYSTEM- SEE OPTIONAL PARTS LIST

PARTS LIST

ITEM #	PART#	QTY.	DESCRIPTION
P14	P50313A	1	STRAINER BASKET
	P50147D	1	1 & 3 GAL. LID ASSEMBLY
P15	P397A001	1	WATER FLUSH VALVE 3/4" BALL
H1	P397A001	1	HYD. OIL VALVE 3/4" BALL
H2	P472A016	1	AGITATOR CONTROL VALVE
	P939A025	1	HYD. VALVE – SEAL KIT (Brand M)
H3	P601A041	1	HYDRAULIC PUMP
H4	P474A095	1	HYDRAULIC DRIVE MOTOR
H5	P498A008	1	DRIVE COUPLER
H6	P909A002	1	OIL FILTER HEAD-SMALL 3/4"
H7	P908A003	1	OIL FILTER
H8	P938A009	7 GAL	HYDRAULIC OIL
H9	P464A002	1	TANK CAP
H10	P498A010	1	PUMP SHAFT COUPLER 1/2" BORE

PARTS LIST – **TRAILERS ONLY**

* DENOTES YOUR CHOICE

ITEM #	PART#	QTY.	DESCRIPTION
P1	P553A008	*	2-5/16" BALL COUPLER
P1	P646A003	*	PINTLE EYE COUPLER
P2	P518A008	1	BREAKAWAY KIT – 4BOLT
	P518A004	1	BREAKAWAY KIT BEFORE 10/2019
P3	P551A008	1	JACK ASSEMBLY
P7	P514A022	4	TIRE ASSEMBLY 235/80R16
	P511A013	2	TR 575/750 BRAKE AXLE
P9	P516A025	1	LEFT SIDE TAIL LIGHT
P10	P516A024	1	RIGHT SIDE TAIL LIGHT
P20	P72000D073	1	RAMP
	P953A008	1	SPRING LATCH

SPRAY MASTER TRAILER & SKID MOUNTED WITH PRO-AIR SYSTEM

APPLIES TO **TR 750 & SK 750** PRO-AIR AND **TR 750** PRO-AIR EXTENDED DECK

NOTE: WITH **MAXX-AIR** SYSTEM- SEE OPTIONAL PARTS LIST

PARTS LIST FOR TR 750-SK 750

ITEM #	PART#	QTY.	DESCRIPTION
A1	P458A044	1	AIR COMPRESSOR ENGINE 13 HP
A2	P458C086	1	PILOT UNLOADER VALVE
A3	P458C063	1	PRESSURE GAUGE
A4	P709C000		POLY AIR TUBING "SOLD BY THE FOOT"
A5	P735A047	1	REGULATOR/WATER TRAP FILTER
A6	P397A033	1	PUMP CONTROL VALVE-1/4" BALL BRASS
M1	P397A002	1	MAIN TANK VALVE-2" BALL BRASS
M2	P397A002	1	GRAVITY VALVE-2" BALL BRASS
M3	P397A002	1	SPRAY BAR FEED VALVE-2" BALL BRASS
M4	P397A010	1	SPRAY WAND VALVE 3/4" BALL CARBON STEEL
M5	P397A012	1	RECIRCULATION VALVE-1-1/4" BALL BRASS
M6	P397A001	1	SPRAY HOSE FEED VALVE 3/4" BALL
M7	P397A009	5	SPRAY TIP VALVE-1/2" BALL BRASS
M8	P30003J	1	SURGE TANK
M9	P640A061	1	DIAPHRAGM PUMP-MATERIAL 1-1/2" ARO
M10	P449A004	6	SPRAY TIP 80/70 - 3/8" NPT STEEL
M11	P754B026	1	75' SPRAY HOSE ASSEMBLY
	P901A001	1	HOSE REEL – MANUAL - OPTIONAL
	P901A002	1	HOSE REEL – ELECTRIC - OPTIONAL
M12	P50273B	1	SPRAY WAND ASSEMBLY
M13	P50147B010	1	BASKET STRAINER ASSEMBLY
	P50147C009	1	1 GAL. HOUSING
M14	P482A007	1	2" HOSE ASSEMBLY - OPTIONAL
P4	P593A051	1	WATER PUMP 12V DC - OPTIONAL
P5	P596A002	1	WATER TANK - OPTIONAL
P6	P398A003	1	WATER CHECK VALVE - OPTIONAL
P8	P602A003	1	SEAT - OPTIONAL
P16	P422A006	2	RATCHET STRAP 1'x10' - OPTIONAL
P17	P72000C104	1	SUPPORT ANGLE - OPTIONAL
P18	P1008A012	1	CAP – WATER TANK - OPTIONAL
P19	P50330K	1	WATER SYSTEM KIT STANDARD - OPTIONAL
	P50330KED	1	WATER SYSTEM KIT EXTENDED DECK - OPTIONAL
P11	P50137B007	2	SHAFT SEAL 2" BORE
P12	P434A004	2	SHAFT BEARING 2" BORE
P13	P50119A	1	BASKET STRAINER SEAL

SPRAY MASTER TRAILER & SKID MOUNTED WITH PRO-AIR SYSTEM

APPLIES TO **TR 750 & SK 750** PRO-AIR AND **TR 750** PRO-AIR EXTENDED DECK

NOTE: WITH **MAXX-AIR** SYSTEM- SEE OPTIONAL PARTS LIST

ITEM #	PART#	QTY.	DESCRIPTION
P14	P50313A	1	STRAINER BASKET
	P50147D	1	1 & 3 GAL. LID ASSEMBLY
P15	P397A001	1	WATER FLUSH VALVE 3/4" BALL
H1	P397A013	1	HYD. OIL VALVE 1" BALL
H2	P472A016	1	AGITATOR CONTROL VALVE
	P939A025	1	HYD. VALVE – SEAL KIT (Brand M)
H3	P601A014	1	HYDRAULIC PUMP
H4	P474A017	1	HYDRAULIC DRIVE MOTOR
H6	P909A008	1	OIL FILTER HEAD-SMALL 1"
H7	P908A003	1	OIL FILTER
H8	P938A009	7 GAL	HYDRAULIC OIL
H9	P464A002	1	TANK CAP
H10	P498A011	1	PUMP SHAFT COUPLER 5/8" BORE
H11	P428A001	1	SPROCKET 1-1/4" BORE
H12	P428A003	1	SPROCKET 2" BORE
H13	P1040A077	1	CHAIN 77" LONG
H14	P1035A003	1	LINK

PARTS LIST – TRAILERS ONLY

* DENOTES YOUR CHOICE

ITEM #	PART#	QTY.	DESCRIPTION
P1	P553A008	*	2-5/16" BALL COUPLER
P1	P646A003	*	PINTLE EYE COUPLER
P2	P518A008	1	BREAKAWAY KIT – 4BOLT
	P518A004	1	BREAKAWAY KIT BEFORE 10/2019
P3	P551A008	1	JACK ASSEMBLY
P7	P514A022	4	TIRE ASSEMBLY 235/80R16
	P511A013	2	TR 575/750 BRAKE AXLE
P9	P516A025	1	LEFT SIDE TAIL LIGHT
P10	P516A024	1	RIGHT SIDE TAIL LIGHT
P20	P72000D073	1	RAMP
	P953A008	1	SPRING LATCH

SPRAY MASTER TRAILER & SKID MOUNTED WITH PRO-AIR SYSTEM

APPLIES TO **TR 1000 & SK 1000** PRO-AIR AND **TR 1000** PRO-AIR EXTENDED DECK

NOTE: WITH **MAXX-AIR** SYSTEM- SEE OPTIONAL PARTS LIST

PARTS LIST

PARTS LIST FOR TR 1000-SK 1000

ITEM #	PART#	QTY.	DESCRIPTION
A1	P458A044	1	AIR COMPRESSOR ENGINE 13 HP
A2	P458C086	1	PILOT UNLOADER VALVE
A3	P458C063	1	PRESSURE GAUGE
A4	P709C000		POLY AIR TUBING "SOLD BY THE FOOT"
A5	P735A047	1	REGULATOR/WATER TRAP FILTER
A6	P397A033	1	PUMP CONTROL VALVE-1/4" BALL BRASS
M1	P397A002	1	MAIN TANK VALVE-2" BALL BRASS
M2	P397A002	1	GRAVITY VALVE-2" BALL BRASS
M3	P397A002	1	SPRAY BAR FEED VALVE-2" BALL BRASS
M4	P397A010	1	SPRAY WAND VALVE 3/4" BALL CARBON STEEL
M5	P397A012	1	RECIRCULATION VALVE-1-1/4" BALL BRASS
M6	P397A001	1	SPRAY HOSE FEED VALVE 3/4" BALL
M7	P397A009	5	SPRAY TIP VALVE-1/2" BALL BRASS
M8	P30003J	1	SURGE TANK
M9	P640A061	1	DIAPHRAGM PUMP-MATERIAL 1-1/2" ARO
M10	P449A004	6	SPRAY TIP 80/70 - 3/8" NPT STEEL
M11	P754B026	1	75' SPRAY HOSE ASSEMBLY
	P901A001	1	HOSE REEL – MANUAL - OPTIONAL
	P901A002	1	HOSE REEL – ELECTRIC - OPTIONAL
M12	P50273B	1	SPRAY WAND ASSEMBLY
M13	P50147B010	1	BASKET STRAINER ASSEMBLY
	P50147C009	1	1 GAL. HOUSING
M14	P482A007	1	2" HOSE ASSEMBLY - OPTIONAL
P4	P593A051	1	WATER PUMP 12V DC - OPTIONAL
P5	P596A002	1	WATER TANK - OPTIONAL
P6	P398A003	1	WATER CHECK VALVE - OPTIONAL
P8	P602A003	1	SEAT - OPTIONAL
P16	P422A006	2	RATCHET STRAP 1'x10' - OPTIONAL
P17	P72000C104	1	SUPPORT ANGLE - OPTIONAL
P18	P1008A012	1	CAP – WATER TANK - OPTIONAL
P19	P50330K	1	WATER SYSTEM KIT STANDARD - OPTIONAL
	P50330KED	1	WATER SYSTEM KIT EXTENDED DECK - OPTIONAL
P11	P50137B007	2	SHAFT SEAL 2" BORE
P12	P434A004	2	SHAFT BEARING 2" BORE
P13	P50119A	1	BASKET STRAINER SEAL

SPRAY MASTER TRAILER & SKID MOUNTED WITH PRO-AIR SYSTEM

APPLIES TO **TR 1000 & SK 1000** PRO-AIR AND **TR 1000** PRO-AIR EXTENDED DECK

NOTE: WITH **MAXX-AIR** SYSTEM- SEE OPTIONAL PARTS LIST

ITEM #	PART#	QTY.	DESCRIPTION
P14	P50313A	1	STRAINER BASKET
	P50147D	1	1 & 3 GAL. LID ASSEMBLY
P15	P397A001	1	WATER FLUSH VALVE 3/4" BALL
H1	P397A013	1	HYD. OIL VALVE 1" BALL
H2	P472A016	1	AGITATOR CONTROL VALVE
	P939A025	1	HYD. VALVE – SEAL KIT (Brand M)
H3	P601A014	1	HYDRAULIC PUMP
H4	P474A017	1	HYDRAULIC DRIVE MOTOR
H6	P909A008	1	OIL FILTER HEAD-SMALL 1"
H7	P908A003	1	OIL FILTER
H8	P938A009	7 GAL	HYDRAULIC OIL
H9	P464A002	1	TANK CAP
H10	P498A014	1	PUMP SHAFT COUPLER 5/8" BORE
H11	P428A001	1	SPROCKET 1-1/4" BORE
H12	P428A003	1	SPROCKET 2" BORE
H13	P1040A085	1	CHAIN 85" LONG
H14	P1035A003	1	LINK

PARTS LIST – **TRAILERS ONLY**

* DENOTES YOUR CHOICE

ITEM #	PART#	QTY.	DESCRIPTION
P1	P553A008	*	2-5/16" BALL COUPLER
P1	P646A003	*	PINTLE EYE COUPLER
P2	P518A008	1	BREAKAWAY KIT – 4BOLT
	P518A004	1	BREAKAWAY KIT BEFORE 10/2019
P3	P551A008	1	JACK ASSEMBLY
P7	P514A023	4	TIRE ASSEMBLY 235/85R16 LRG
	P511A040	2	TR 1000 BRAKE AXLE
P9	P516A025	1	LEFT SIDE TAIL LIGHT
P10	P516A024	1	RIGHT SIDE TAIL LIGHT
P20	P72000D073	1	RAMP
	P953A008	1	SPRING LATCH

SPRAY MASTER TANK TRAILER & SKID-MOUNTED

TR 575 – TR 750 – TR 1000 PRO-AIR & PRO-AIR EXTENDED DECK

SK 575 – SK 750 – SK 1000 PRO-AIR

NOTE: WITH **MAXX-AIR** SYSTEM - SEE OPTIONAL PARTS LIST

PARTS LIST FOR ARO 1-1/2" PUMP

DESCRIPTION	S/M PART #	QTY.
DIAPHRAGM MAT'L. PUMP 1-1/2" ARO	P640A061	
ROD	P976A001	1
BACKUP WASHER	P976A002	2
DIAPHRAGM WASHER	P976A003	2
WASHER	P976A004	2
SCREW M14 X 2-6G X 45MM	P976A005	2
FLUID CAP OUTER CHAMBER	P976A006	2
SEAT	P976A007	4
BALL	P976A008	4
SCREW M10 X 1.5-6G X 30MM	P976A009	8
BOLT M8 X 1.25-6G X 40MM	P976A010	20
HEX FLANGE NUT M8 X 1.25-6H	P976A011	20
GROUND LUG	P976A012	1
INLET MANIFOLD	P976A013	1
OUTLET MANIFOLD	P976A014	1
PIPE PLUG 1-1/2" N.P.T.	P976A015	2
AIR CAP INNER CHAMBER	P976A016	1
AIR CAP INNER CHAMBER	P976A017	1
GASKET	P976A018	2
SCREW M10 X 1.5-6G X 100MM	P976A019	4
U CUP 3/16" X 1-1/4" O.D.	P976A020	2
O-RING 3/32" X 13/16" O.D.	P976A021	2
WASHER .406 I.D. X .031" THICK	P976A022	4

SPRAY MASTER TANK TRAILER & SKID-MOUNTED

TR 575 – TR 750 – TR 1000 PRO-AIR & PRO-AIR EXTENDED DECK

SK 575 – SK 750 – SK 1000 PRO-AIR

NOTE: WITH **MAXX-AIR** SYSTEM - SEE OPTIONAL PARTS LIST

PARTS LIST FOR ARO 1-1/2" PUMP

DESCRIPTION	S/M PART #	QTY.
DIAPHRAGM MAT'L. PUMP 1-1/2" ARO	P640A061	
NUT M10 X 1.5-6H	P976A023	4
CENTER BODY	P976A024	1
BUSHING	P976A025	1
SCREW M6 X 1- 6G X 16MM LONG	P976A026	4
SPOOL	P976A027	1
ACTUATOR PIN	P976A028	2
SLEEVE	P976A029	2
PIPE PLUG 1/8-27 N.P.T. X .27"	P976A030	1
GASKET	P976A031	1
WASHER	P976A032	3
SCREW M6 X 1- 6G X 20MM	P976A033	4
VALVE BLOCK	P976A034	1
END CAP	P976A035	1
GASKET	P976A036	1
U CUP 3/16" X 1-5/8" O.D.	P976A037	1
U CUP 3/16" X 1-1/8" O.D.	P976A038	1
VALVE INSERT	P976A039	1
VALVE PLATE	P976A040	1
GASKET	P976A041	1
PILOT PISTON - WITH O-RING & U CUP	P976A042	1
O-RING 3/32" X 5/8" O.D.	P976A043	2
U CUP 1/8" X 7/8" O.D.	P976A044	1

SPRAY MASTER TANK TRAILER & SKID-MOUNTED

TR 575 – TR 750 – TR 1000 PRO-AIR & PRO-AIR EXTENDED DECK

SK 575 – SK 750 – SK 1000 PRO-AIR

NOTE: WITH **MAXX-AIR** SYSTEM - SEE OPTIONAL PARTS LIST

PARTS LIST FOR ARO 1-1/2" PUMP

DESCRIPTION	S/M PART #	QTY.
DIAPHRAGM MAT'L. PUMP 1-1/2" ARO	P640A061	
PISTON SLEEVE	P976A045	1
O-RING 3/32" X 1-1/8" O.D.	P976A046	1
O-RING 1/16" X 1-1/8" O.D.	P976A047	1
O-RING 3/32" X 1-3/8" O.D.	P976A048	2
O-RING 1/8" X 1/2" O.D.	P976A049	2
DIAPHRAGM CHECK VALVE	P976A050	2
ROLL PIN 5/32" O.D. X 1/2" LONG	P976A051	4
GASKET	P976A052	1
MUFFLER	P976A053	1
ADAPTER PLATE	P976A054	1
FML-2 GREASE	P976A055	1
GREASE PACKETS	P976A056	1
MAJOR VALVE ASSEMBLY	P976A057	1
AIR VALVE SERVICE KIT	P976A058	1
MATERIAL PUMP REBUILT KIT	P976A059	1
DIAPHRAGM	P976A060	2

SPRAY MASTER TANK TRAILER & SKID-MOUNTED

NOTE: WITH **MAXX-AIR** SYSTEM - **ARO 2" PUMP IS STANDARD**

TR 575 – TR 750 – TR 1000 PRO-AIR & PRO-AIR EXTENDED DECK AND

SK 575 – SK 750 – SK 1000 PRO-AIR **ARO 2" PUMP IS OPTIONAL**

PARTS LIST FOR ARO 2" PUMP

DESCRIPTION	S/M PART #	QTY.
DIAPHRAGM MAT'L. PUMP 2" ARO	P640A068	
ROD	P977A001	1
BACKUP WASHER	P977A002	2
DIAPHRAGM WASHER	P977A003	2
DIAPHRAGM	P977A004	2
WASHER	P977A005	2
SCREW 5/8"-18 X 2-1/2"	P977A006	2
FLUID CAP OUTER CHAMBER	P977A007	2
SEAT	P977A008	4
BALL	P977A009	4
SCREW M10 X 1.5-6G X 35MM	P977A010	8
SCREW M10 X 1.5-6G X 45MM	P977A011	16
NUT M10 X 1.5-6H	P977A012	16
GROUND LUG	P977A013	1
OUTLET MANIFOLD	P977A014	1
INLET MANIFOLD	P977A015	1
PIPE PLUG 2" N.P.T.	P977A016	2
AIR CAP INNER CHAMBER	P977A017	1
AIR CAP INNER CHAMBER	P977A018	1
GASKET	P977A019	2
SCREW M10 X 1.5-6G X 120MM	P977A020	4
U CUP 3/16" X 1-3/8" O.D.	P977A021	2
O-RING 3/32" X 1" O.D.	P977A022	2
WASHER .406 I.D. X .031" THICK	P977A023	4

SPRAY MASTER TANK TRAILER & SKID-MOUNTED

NOTE: WITH **MAXX-AIR** SYSTEM - **ARO 2" PUMP IS STANDARD**

TR 575 – TR 750 – TR 1000 PRO-AIR & PRO-AIR EXTENDED DECK AND

SK 575 – SK 750 – SK 1000 PRO-AIR ARO 2" PUMP IS **OPTIONAL**

PARTS LIST FOR ARO 2" PUMP

DESCRIPTION	S/M PART #	QTY.
DIAPHRAGM MAT'L. PUMP 2" ARO	P640A068	
CENTER BODY	P977A024	1
BUSHING	P977A025	1
INLET PLUG	P977A026	1
PISTON	P977A027	1
U CUP 1-3/8" O.D.	P977A028	1
SPOOL	P977A029	1
WASHER 1.556" O.D.	P977A030	5
O-RING 1/8" X 1-1/4" O.D.	P977A031	5
O-RING 3/32" X 1-9/16" O.D.	P977A032	7
SPACER	P977A033	4
SPACER	P977A034	1
ACTUATOR PIN .250 X 2.276 LONG	P977A035	2
SLEEVE	P977A036	2
90 DEG. ST. ELBOW 1-1/2-11-1/2 N.P.T.	P977A037	1
GASKET – VALVE BODY	P977A038	1
LOCK WASHER 1/4"	P977A039	3
SCREW M6 X 1.0-6G X 16MM	P977A040	4
VALVE BLOCK	P977A041	1
PISTON PLUG	P977A042	1
TRACK GASKET	P977A043	1
PILOT PISTON - WITH O-RING & U CUP	P977A044	1
O-RING 3/32" X 5/8" O.D.	P977A045	2
U CUP 1/8" X 7/8" O.D.	P977A046	1

SPRAY MASTER TANK TRAILER & SKID-MOUNTED

NOTE: WITH **MAXX-AIR** SYSTEM - **ARO 2" PUMP IS STANDARD**

TR 575 – TR 750 – TR 1000 PRO-AIR & PRO-AIR EXTENDED DECK AND

SK 575 – SK 750 – SK 1000 PRO-AIR ARO 2" PUMP IS **OPTIONAL**

PARTS LIST FOR ARO 2" PUMP

DESCRIPTION	S/M PART #	QTY.
DIAPHRAGM MAT'L. PUMP 2" ARO	P640A068	
PISTON SLEEVE	P977A047	1
O-RING 3/32" X 1-1/8" O.D.	P977A048	1
O-RING 1/16" X 1-1/8" O.D.	P977A049	1
O-RING 1/16" X 1-3/8" O.D.	P977A050	2
O-RING 1/8" X 1/2" O.D.	P977A051	2
DIAPHRAGM CHECK VALVE	P977A052	2
RETAINING RING	P977A053	1
MUFFLER	P977A054	1
FML-2 GREASE	P977A055	1
GREASE PACKETS	P977A056	1
MAJOR VALVE ASSEMBLY	P977A057	1
AIR VALVE SERVICE KIT – STYLE "A"	P977 A 058	1
MATERIAL PUMP REBUILD KIT	P977A059	1
MAJOR VALVE ASSEMBLY	P977B057	1
AIR VALVE SERVICE KIT – STYLE "B"	P977 B 058	1

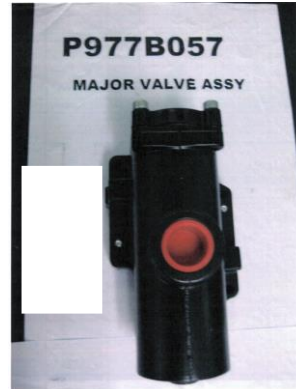
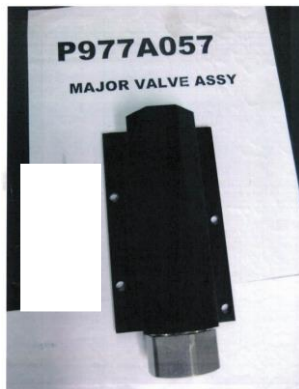

SPRAY MASTER TANK TRAILER WITH PRO-AIR SYSTEM

APPLIES TO ALL PRO-AIR TRAILER AND SKID VERSIONS

PARTS LIST

PARTS LIST FOR PRO-AIR COMPRESSOR ASSEMBLY

ITEM	DESCRIPTION	S/M PART #	QTY.
	AIR COMPRESSOR WITH ENGINE	P458A044	
1	13HP HONDA ENGINE	P458A087	1
2	PULLEY	P458C081	1
4	V-BELT	P458C083	1
5	BELT GUARD	P458C087	1
16	COMPRESSOR PUMP W/FLYWHEEL	P458C054	1
16	COMPRESSOR PUMP - ONLY	P458C055	1
15	COMPRESSOR FLYWHEEL - ONLY	P458C057	1
21A	AIR FILTER ASSEMBLY	P458C043	1
	AIR FILTER ELEMENT - ONLY	P458C044	1
26	26" FLEX DISCHARGE TUBE	P458C089	1
34	30 GALLON TANK	P458C088	1
36	SHUT OFF VALVE	P458C090	1
45	PILOT UNLOADER VALVE	P458C086	1
47	300 PSI PRESSURE GAUGE	P458C063	1
	BUSHING	P740A006	1
	DRAIN COCK	P458C085	1

ROLAIR
 SCHEMATIC FOR
 11GR30HK30
 13GR30HK30

Production starting 10/18

21A

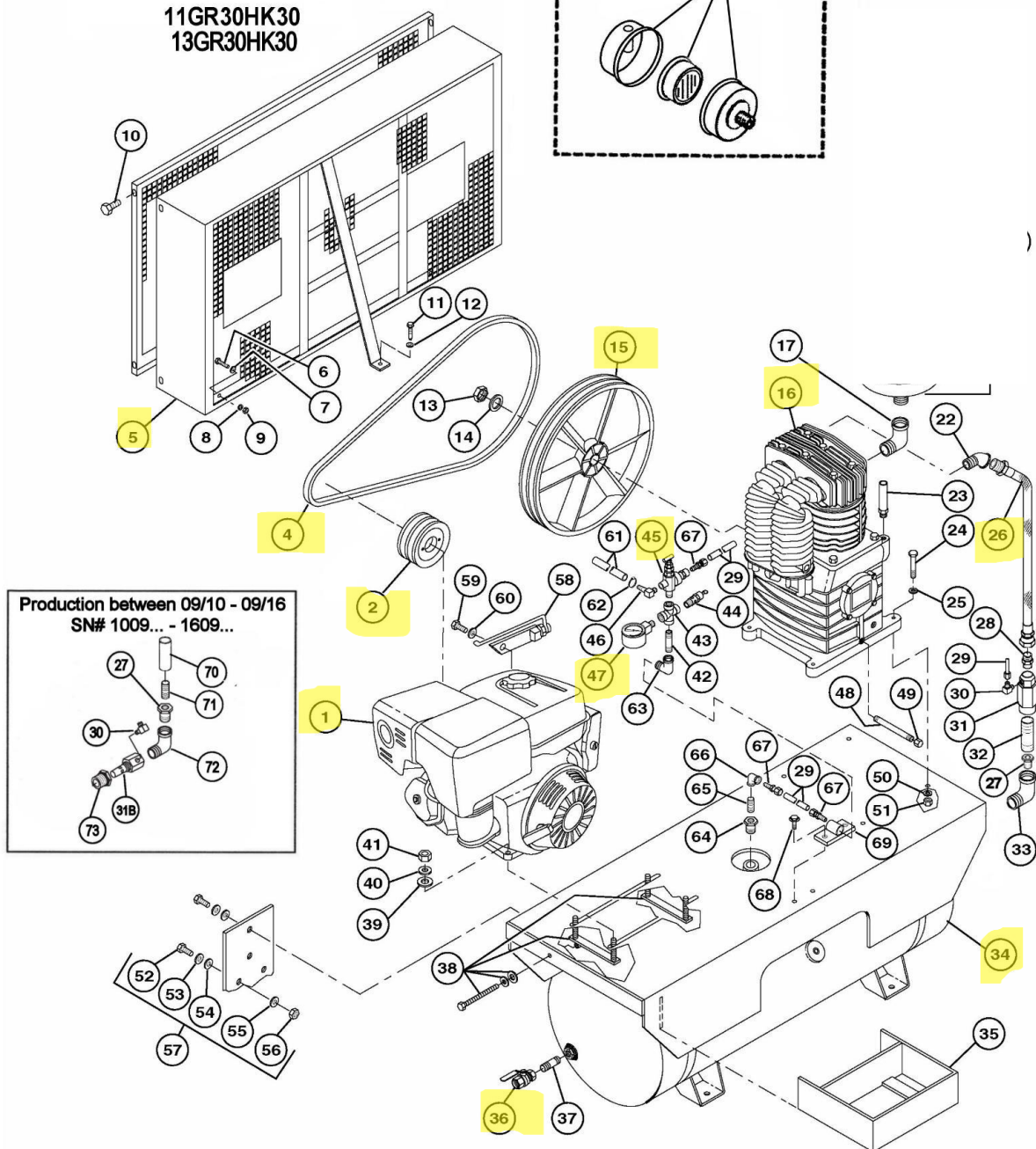

SPRAY MASTER TANK TRAILER WITH MAXX-AIR SYSTEM

APPLIES TO ALL MAXX-AIR TRAILER AND SKID VERSIONS

OPTIONAL - PARTS LIST

PARTS LIST FOR MAXX-AIR COMPRESSOR ASSEMBLY

ITEM	DESCRIPTION	S/M PART #	QTY.
	AIR COMPRESSOR WITH ENGINE	P458A047	
1	4-CYL. - II STAGE PUMP WITH SMALL FLYWHEEL	P458C091	1
2	AIR FILTER ASSEMBLY	P458C092	1
3	AIR FILTER ELEMENT	P458C093	1
4	60 GALLON TANK	P458C094	1
5	BELT GUARD	P458C095	1
6	PILOT UNLOADER VALVE	P458C086	1
7	DRAIN COCK	P458C085	1
8	SHUT OFF VALVE	P458C090	1
9	300 PSI PRESSURE GAUGE	P458C063	1
10	SHEAVE	P661A022	1
11	V-BELT	P660A024	1
12	20 HP KOHLER ENGINE	P458A013	1
13	BUSHING	P740A042	1

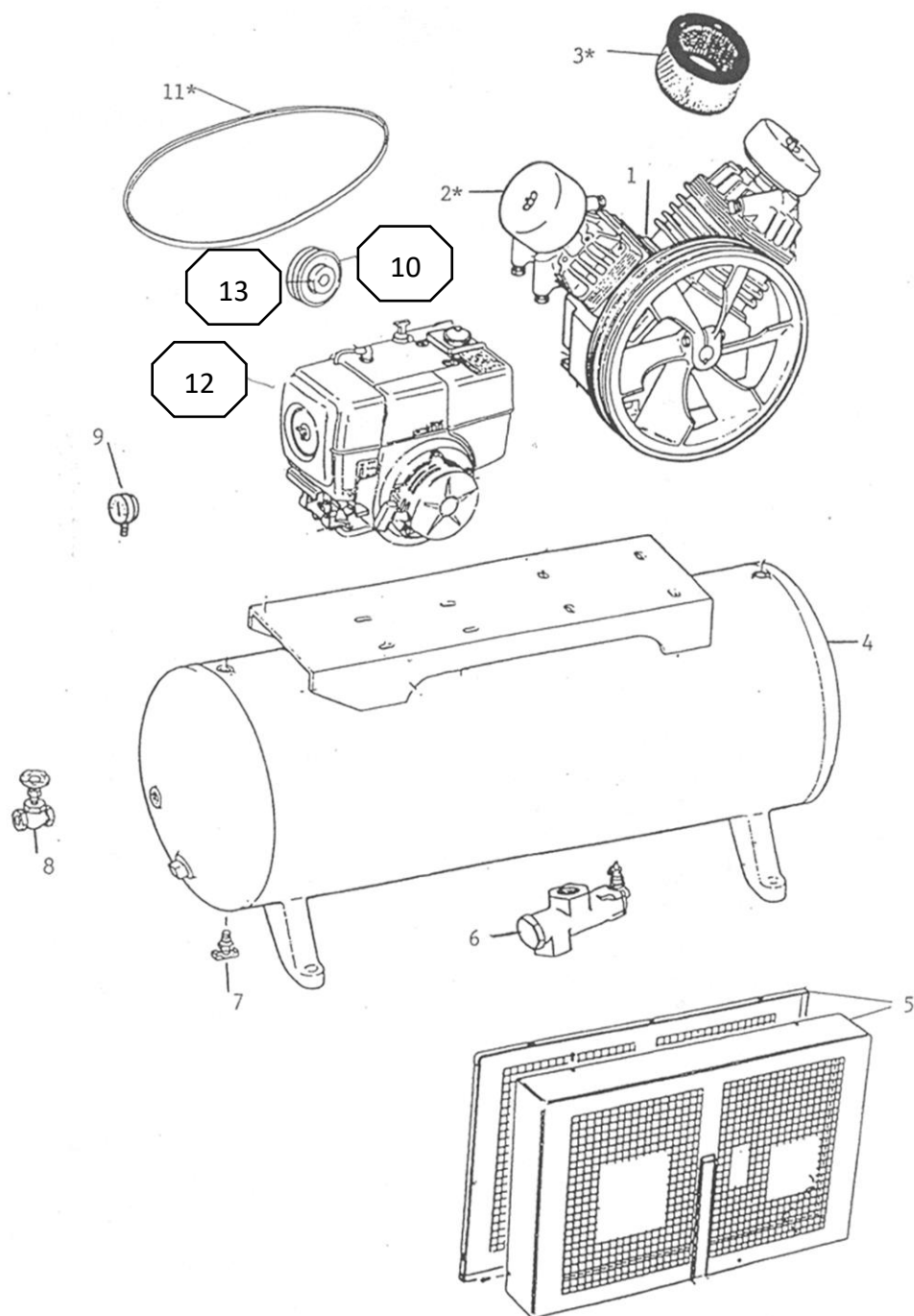

SPRAY MASTER TRAILER & SKID MOUNTED WITH PRO-AIR & PRO-AIR EXTENDED DECK SYSTEM & MAXX-AIR

APPLIES TO: **TR 575 & SK 575 TR 750 & SK 750 TR 1000 & SK 1000**

PARTS LIST: MATERIAL PUMP & COMPRESSOR/HYD. PUMP ASSEMBLY

ITEM #	PART#	QTY.	DESCRIPTION
1	P72000A001	1	AIR COMPRESSOR ASSEMBLY
	P458A044	1	AIR COMPRESSOR WITH ENGINE
	P458A087		ENGINE 13 HP ONLY
2	P601A041	1	SMALL HYDRAULIC PUMP
	P72000A004	1	AIR COMPRESSOR ASSEMBLY
	P458A044	1	AIR COMPRESSOR WITH ENGINE
	P458A087		ENGINE 13 HP ONLY
2	P601A014	1	LARGE HYDRAULIC PUMP
	P72000C002	1	MAXX AIR COMPRESSOR WITH ENGINE ASSEMBLY
	P458A047	1	AIR COMPRESSOR WITH ENGINE
	P458A013		ENGINE 20 HP ONLY
	P601A014	1	LARGE HYDRAULIC PUMP
3	P72000 T 002	1	TR-NON HOSE REEL 1-1/2" ARO PUMP ASSEMBLY
4	P640A061	1	1-1/2" ARO PUMP
	P72000 U 002	1	TR-NON HOSE REEL 2" ARO PUMP ASSEMBLY
4	P640A068	1	2" ARO PUMP
	P72000 A 002	1	SK-NON HOSE REEL 1-1/2" ARO PUMP ASSEMBLY
	P640A061	1	1-1/2" ARO PUMP
	P72000 D 002	1	SK-NON HOSE REEL 2" ARO PUMP ASSEMBLY
	P640A068	1	2" ARO PUMP
5	P72000 W 002	1	TR-WITH HOSE REEL 1-1/2" ARO PUMP ASSEMBLY
	P640A061	1	1-1/2" ARO PUMP
	P72000 Y 002	1	TR-WITH HOSE REEL 2" ARO PUMP ASSEMBLY
	P640A068	1	2" ARO PUMP
	P72000 X 002	1	SK-WITH HOSE REEL 1-1/2" ARO PUMP ASSEMBLY
	P640A061	1	1-1/2" ARO PUMP
	P72000 Z 002	1	SK-WITH HOSE REEL 2" ARO PUMP ASSEMBLY
	P640A068	1	2" ARO PUMP

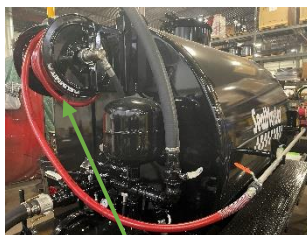

5 WITH HOSE REEL

4 ARO PUMP



3 NON HOSE REEL

**1 AIR COMPRESSOR WITH ENGINE
AND 2 HYD. PUMP**

MAINTENANCE AND STORAGE

MAINTENANCE

During the lubrication stop, inspect all operating parts. Should any damage or excessive wear be evident, replace parts immediately. Straighten any parts as soon as possible. Clean and re-paint all exposed parts using touch-up kit P3020B034 **yellow** paint or touch-up kit P3020B033 **black** paint.

STORAGE

Perform all required maintenance and lubrication procedures.

Coat all shafts with grease. Clean and re-paint all exposed parts using touch-up kit P3020B034 **yellow** paint or touch-up kit P3020B033 **black** paint.

Each touch-up kit includes:

1-pint paint can --- 1 pair of gloves --- 1 touch-up paintbrush