

Heated Asphalt Distributor

300 & 575

OWNERS MANUAL



SealMaster[®]

Pavement Products & Equipment

PO Box 2277 • Sandusky, Ohio 44870 • 419-626-4375

sealmaster.net

HEATED ASPHALT DISTRIBUTOR

Owner's Manual

Version 2.8

Issue Date: November 2023

Effective Date: January 2018

Version	Date	Changes	Approval
1.0		Original Issue	
2.0	4/19	New Format and Updates	DS
2.1	6/19	Updated Wiring Diagrams	EK
2.2	10/20	Item 49 was P601A014	JG
2.3	10/21	Item 47 was P474A029	JG
2.4	1/22	Winterize Sheet Added	JG
2.5	4/22	Added Paint Page	JG
2.6	5/22	Breakaway Kit Change	JG
2.7	7/23	Item P932A001 Removed	JG
2.8	11/23	Picture / List Sequence	JG

Table of Contents

CORRESPONDENCE	3
SealMaster® LIMITED WARRANTY	4
SAFETY PRECAUTIONS AND CAUTIONS	5
PRECAUTIONS.....	5
CAUTIONS.....	5
FIRST AID	6
STARTING THE ENGINE	7
OPERATING INSTRUCTIONS	8
HEATING THE MATERIAL.....	8
PUMPING MATERIAL	9
SPRAY BAR	9
DIESEL FLUSH.....	10
MAINTENANCE TIPS.....	10
PARTS LIST PICTURE – 1	11
PARTS LIST PICTURE – 2	12
PARTS LIST PICTURE – 3	14
PARTS LIST PICTURE – 4	16
PARTS LIST PICTURE – 5	18
CHECKLIST.....	19
BEFORE STARTING THE ENGINE	19
STARTING THE ENGINE	20
OPERATING INSTRUCTIONS WITH HYDRAULIC DRIVE	21
HEATING THE MATERIAL.....	21
PUMPING MATERIAL	22
SPRAY BAR	22
DIESEL FLUSH.....	23
MAINTENANCE TIPS.....	23

PARTS LIST PICTURE – 6	24
PARTS LIST PICTURE – 7	25
PARTS LIST PICTURE – 8	27
PARTS LIST PICTURE – 9	29
PARTS LIST PICTURE – 10	31
PARTS LIST PICTURE – 11	31
HEATED TACK TANK MACHINE MAINTENANCE	32
MAINTENANCE SCHEDULE	32
TROUBLESHOOTING GUIDE	33
HOW TO WINTERIZE YOUR EQUIPMENT	34
WIRING DIAGRAMS	35
ELECTRIC BRAKES AND RUNNING LIGHTS	35
TANK CAPACITY CHART	36
MATERIAL DEPTH AND GALLON VOLUME	36
ROPER 1-1/4" PUMP	37
PARTS LIST	37
PUMP DIAGRAM	38
ROPER 2" PUMP 3611 HZRV	39
PARTS LIST	39
PUMP DIAGRAM	40
MAINTENANCE AND STORAGE	41
MAINTENANCE	41
STORAGE	41

ThorWorks Industries, Inc.

Purchased by _____ Model NO. _____
Company Name _____ Serial NO. _____
Address _____ Acceptance Date _____
City _____ State _____ Zip _____

CORRESPONDENCE

All Correspondence regarding this equipment, as well as general correspondence should be addressed to:

ThorWorks Industries, Inc.

PO Box 2277

Sandusky, OH 44870

In referring to the equipment, kindly state the Model Number, Serial Number and any part number involved



SealMaster® LIMITED WARRANTY

SealMaster warrants that its products are of quality material and workmanship. SealMaster agrees to replace, within a period of one (1) year from date of delivery, or at its option, repair, without charge, any part of their manufacture which proved defective. The repair or replacement will be free of charge F.O.B. Sandusky, Ohio, providing the damaged part or parts are returned, freight prepaid, to SealMaster and investigation shows such repair or replacement is made necessary by an inherent defect of material or workmanship.

It is hereby understood that engines, motors, pumps, or other components purchased by SealMaster for use on its equipment are not warranted by SealMaster and are sold only with the standard warranty of the manufacturer of that component.

SealMaster will make no allowances for repairs or alterations completed by outside sources unless authorization is in writing and approved by an authorized SealMaster representative.

Any claims for defective material or workmanship must be made prior to the expiration of thirty (30) days from the date failure occurs, and in all cases prior to the expiration of the warranty period of one (1) year. It is the intent of this paragraph to limit SealMaster's liability solely to the cost of replacement parts, F.O.B. factory, or at the option of SealMaster to repair of the defective part or parts. No allowances for damages, lost time, or any other claim will be recognized.

This warranty is null and void if other than genuine SealMaster parts are used.

SealMaster is constantly striving to improve their products. Changes in design and improvement will be made whenever the manufacturer believes the efficiency of the product will be improved, without incurring any obligation to incorporate such improvements in any machines which have been shipped or are in service.

In an effort to continue to improve product quality, SealMaster reserves the right to change specifications without notice.

Any modification or alteration of this machine without prior approval of the manufacturer may void this warranty.

SAFETY PRECAUTIONS AND CAUTIONS

PRECAUTIONS

- The operator must be aware that he is working with a mechanical device that contains **HOT** materials, and must exercise caution at all times.
- **Always** wear **eye** and **ear** protection, **long sleeve shirt**, and **gloves**.



- Be aware of all **CAUTION, WARNING, and DANGER** signs on the machine.
- All employees should be trained in **Emergency Burn First Aid**.
- Read all Owners Manuals that come with this Machine.
- Make sure the operator is familiar with machine operation.
- Know the procedures for safe operation of propane-fired devices.
- Read and understand the MSDS Sheets for the material you are applying.
- Replace any hoses that show signs of wear, fraying or splitting.
- Be sure all fittings and joints are tight and leak proof.
- Do not operate the machine in the rain or closed building or confined area.
- Do not do maintenance work on the machine while in operation.
- The machine should not be left unattended when running.

CAUTIONS

- Never refuel engine while the burner is lit.
- Never expose the material to an open flame.
- Keep hands, feet, and clothing away from moving parts.
- Do not operate the machine without all guards in place.
- Do not point the spray nozzle at another person.
- Wear eye protection when operating the spray wand or spray bar.

SAFETY PRECAUTIONS AND CAUTIONS

FIRST AID

FIRST AID FOR MOLTEN ASPHALT CEMENT BURNS

In the event of a MOLTEN ASPHALT CEMENT BURN:

COOL the asphalt cement and affected parts of the body immediately.

Methods of cooling (in order of preference):

1. Completely submerge affected area in ice water;
2. Completely submerge affected area in tap water;
3. Place affected area under running water.

DO NOT DELAY

Use any available water, cooler than body temperature, while arranging for better cooling.

CAUTION: DO NOT apply ice directly to affected area.

LEAVE cooled asphalt cement on affected area.

Proceed with the following:

MINOR ASPHALT CEMENT BURNS— at first opportunity get victim to physician.

Includes:

Injury to small areas of fairly insensitive flesh involving a small quantity of asphalt cement.



SERIOUS ASPHALT CEMENT BURNS— as soon as possible get victim to:

Hospital _____
Clinic _____
Physician's Office _____

Includes:

Injury to the head, face or extremities;
Injury when large amounts of asphalt cement are involved;
Evidence of nausea or faintness.



TREATMENT FOR SHOCK

In the event shock occurs, do the following:

1. Keep victim lying down and quiet.
2. Keep victim covered with a blanket or something similar to keep body temperature at normal, 98°F (37°C).
3. Keep victim's head lower than feet to promote blood supply to head and chest.



DO NOT ATTEMPT TO REMOVE THE ASPHALT CEMENT

with products containing solvents or ammonia.

Natural separation will occur in about 48-72 hours.

If necessary, for early removal, soak bandage in mineral oil and place over affected area for 2 to 3 hours.

A Safety Information Service of the

NAPA

NATIONAL ASPHALT PAVEMENT ASSOCIATION

6811 Kenilworth Avenue • Riverdale, Maryland 20737 • (301) 779-4860 • FAX (301) 779-8617

HEATED ASPHALT DISTRIBUTOR

APPLIES TO ALL TRAILER AND SKID VERSIONS

OPERATING INSTRUCTIONS

STARTUP

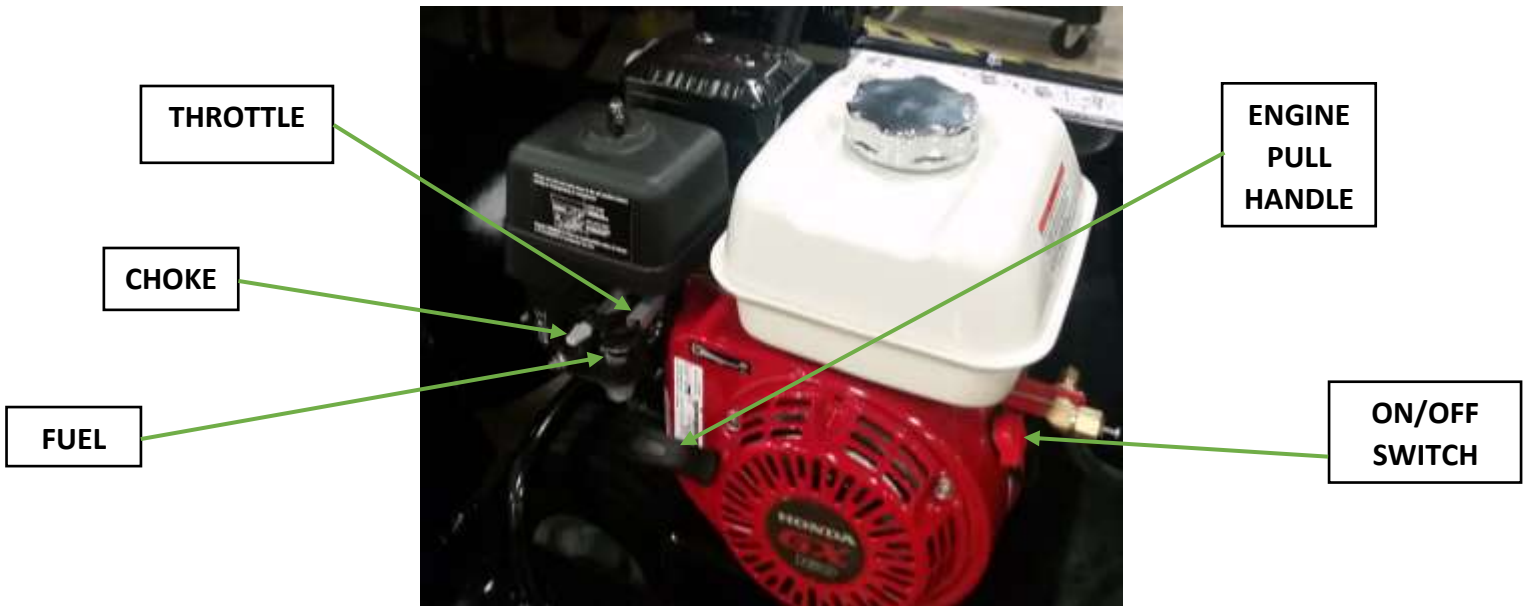

STARTING THE ENGINE

NOTE: If equipped with **optional** hydraulic drive upgrade refer to pages 18-26

- Set the **fuel** shutoff and **choke** levers to the **on** position.
- Set the throttle lever at ½ open.
- Set the engine **on/off** switch to **on** position.
- Pull start the **engine**.



- It is important that when you are done running the engine that the **fuel** shutoff lever is turned to the **off** position. This keeps gasoline from mixing with oil as you are driving.

Refer to the engine manual.

HEATED ASPHALT DISTRIBUTOR

APPLIES TO ALL TRAILER AND SKID VERSIONS

OPERATING INSTRUCTIONS

HEATING THE MATERIAL

1. Attach Nut & Nipple #1 to your LP Gas tank.

 **note** The burner uses vapor propane, **NOT** liquid.

2. Slowly open the valve on the LP Gas Tank. Opening too fast can cause a check valve to slam closed, reducing the available flow of gas.
3. Regulator #3 is pre-set for 30 psi. Turn the knob counter-clockwise to lower the pressure. The burner #11, is rated for maximum heat output at 30 psi. Open gas shut-off valve #7 slightly, depress the red push on gas pilot valve #8. This allows gas to flow thru the burner, at the same time use the striker flint #10 to produce a spark. Strike repeatedly until the gas ignites.

 **note** If the gas does not light within 5 seconds, release the red push button and wait 10 minutes before trying again.

Once you have ignition, you must continue to depress the red push button on gas pilot valve #8 for at least 10 seconds. This allows the thermocouple #9 to heat up, allowing the gas valve to continue the gas flow. If the flame stays on, then open gas shut-off valve #7 all the way to get maximum heat from the burner.

 **note** If the flame goes out, you will need to start over with the lighting process.

Anytime you want to decrease the flame intensity, slightly close gas shut-off valve #7.

4. The thermocouple #9 also acts as a safety. Should the flame go out because of wind, the thermocouple immediately starts to cool off and stops the signal to the gas valve, which then stops the flow of gas. This may take up to 30 seconds.

 **note** **WAIT 10 MINUTES BEFORE TRYING TO RE-LIGHT THE BURNER.**

5. Monitor material temperature on thermometer #13. As the material reaches the desired temperature you can slightly close gas shut-off valve #7 to decrease the flame, or just shut off the valve completely.



NEVER DRIVE WITH THE BURNER LIT!!

HEATED ASPHALT DISTRIBUTOR

APPLIES TO ALL TRAILER AND SKID VERSIONS

OPERATING INSTRUCTIONS

PUMPING MATERIAL

6. Open main tank valve #16 and recirculation valve #24. Close all other valves.
7. Start engine #23 only after reading the engine manual, provided with your machine. Engine speed will determine the gallons per minute pumped.
8. Start by recirculating material. The material pump #22 draws material from the tank, thru the basket strainer #17, thru the recirculation valve #24 and into the top of the tank.
9. Uncoil the spray hose from the side hangars on the tank. Open spray hose feed valve #25 and spray wand valve #27. Slowly start to close recirculation valve #24. This will send some product down the spray hose and out the wand spray tip 80/20 #28. Partially closing this valve allows you to adjust the desired spray pressure.

NEVER CLOSE RECIRCULATION VALVE #24 COMPLETELY

SPRAY BAR

10. When using the spray bar #31, spray hose feed valve #25 and spray wand valve #27 remain closed. Once you have recirculated product, slowly close recirculation valve #24. Open spray tip valves #32 on the spray bar #31. Position the machine, motion for the driver to start forward at approx. 4mph, open spray bar feed valve #38, and also the #55 spray bar lever, to start spraying. This opens all of the spray tip valves #32 at the same time. Once again, recirculation valve #24 determines spray pressure, adjust accordingly.
11. The throttle on the engine #23 needs to be set to 3/4 or full position to ensure there is enough speed is available for the material pump #22.
12. Run the pump pressure and speed at the lowest acceptable application pressure to help reduce overspray.
13. You can control pressure by using the recirculation valve #24.

14. Close spray bar feed valve #38 or the #55 spray bar lever when you reach the end of your pass, leave all the pump controls set. The spray will continue when you open the spray bar feed valve #38 or the #55 spray bar lever.
15. Position the tires right next to the previous pass, this will give you the proper overlap.
16. When finished, turn off the engine and close all valves and follow flushing instructions below.

DIESEL FLUSH

17. Close main tank valve #16 and recirculation valve #24. Start engine #23.
18. Open diesel flush valve #15 on the bottom of the diesel tank #12.
19. Open spray hose feed valve #25 and spray wand valve #27 to flush the spray hose and wand. To flush the spray bar open spray bar feed valve #38 or the #55 spray bar lever on the spray bar #31 to the open position. When done, turn off the engine and close all open valves.
20. Use only *diesel fuel* for flushing purposes.
21. Remove the lid from the basket strainer #17 and clean the basket.

note

Anytime you notice the spray pressure is decreasing, the basket strainer **#17** probably needs to be cleaned. Make sure you close main tank valve #16 before you remove the lid.

MAINTENANCE TIPS

22. Adjust the V-belt #20 tension, by going halfway between the center of the two pulleys and moving the belt up and down. It should move about $\frac{1}{2}$ ".
23. The material pump #22 has a mechanical seal, some leakage is normal. When the seal plate cannot be tightened any more, the seal must be replaced.
24. The orifice is inside burner **#11**, needs to be cleaned occasionally. Soot and spider webs can cause blockage of the flow of gas.

note

25. Always leave the LP gas hose #6 connected to a tank. If left disconnected, insects will make their nest inside of it and block the flow of gas.

HEATED ASPHALT DISTRIBUTOR

APPLIES TO ALL TRAILER AND SKID VERSIONS

PARTS LIST

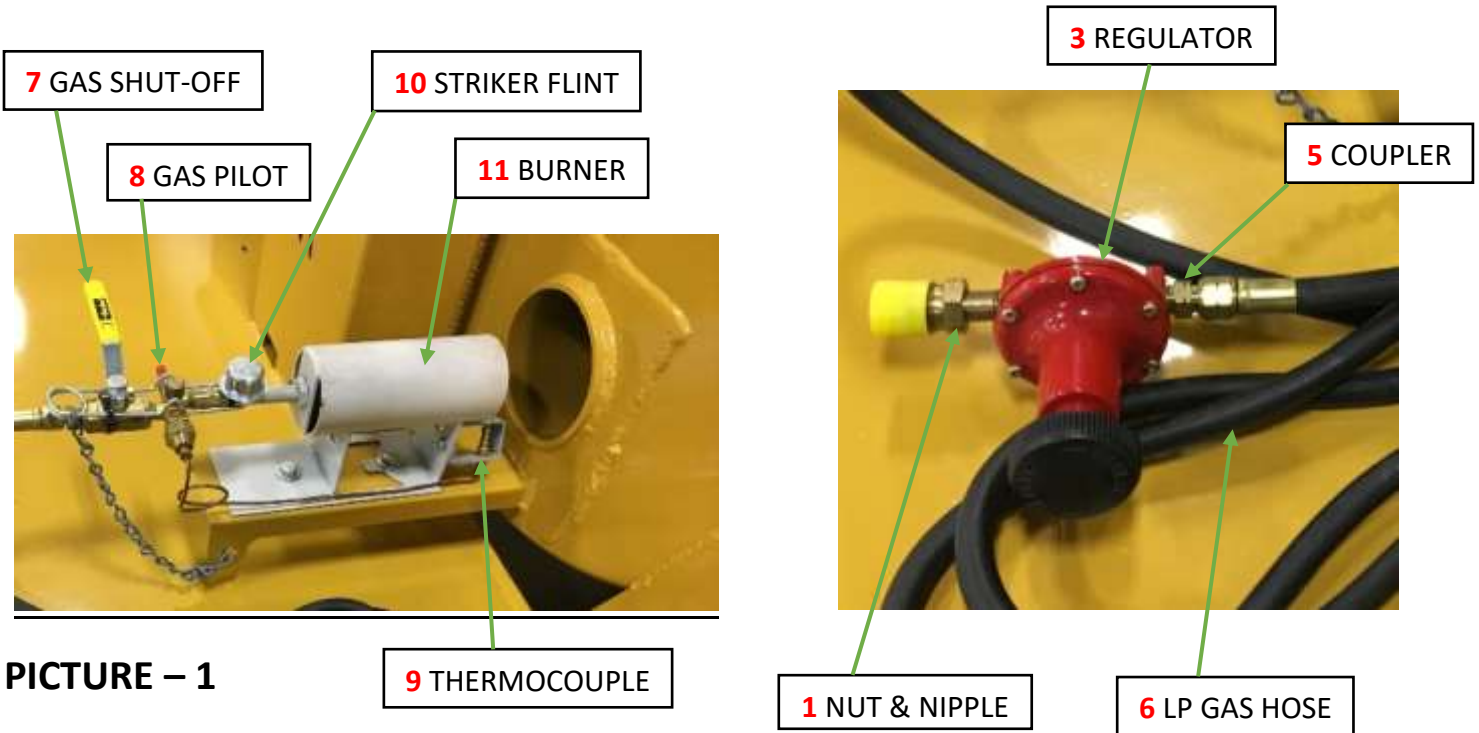

PICTURE – 1

PARTS LIST PICTURE – 1

ITEM #	PART#	QTY.	DESCRIPTION
1	P933A001	1	NUT AND NIPPLE
3	P735A015	1	REGULATOR
5	P935A001	2	COUPLER
6	P669A005	1	LP GAS HOSE – 10 FT.
7	P397A011	1	GAS SHUT-OFF VALVE
8	P735A016	1	GAS PILOT VALVE
9	P679A003	1	THERMOCOUPLE 24"
10	SS107A1	1	STRIKER FLINT
11	P662A003	1	BURNER COMPLETE

HEATED ASPHALT DISTRIBUTOR

APPLIES TO ALL TRAILER AND SKID VERSIONS

PARTS LIST

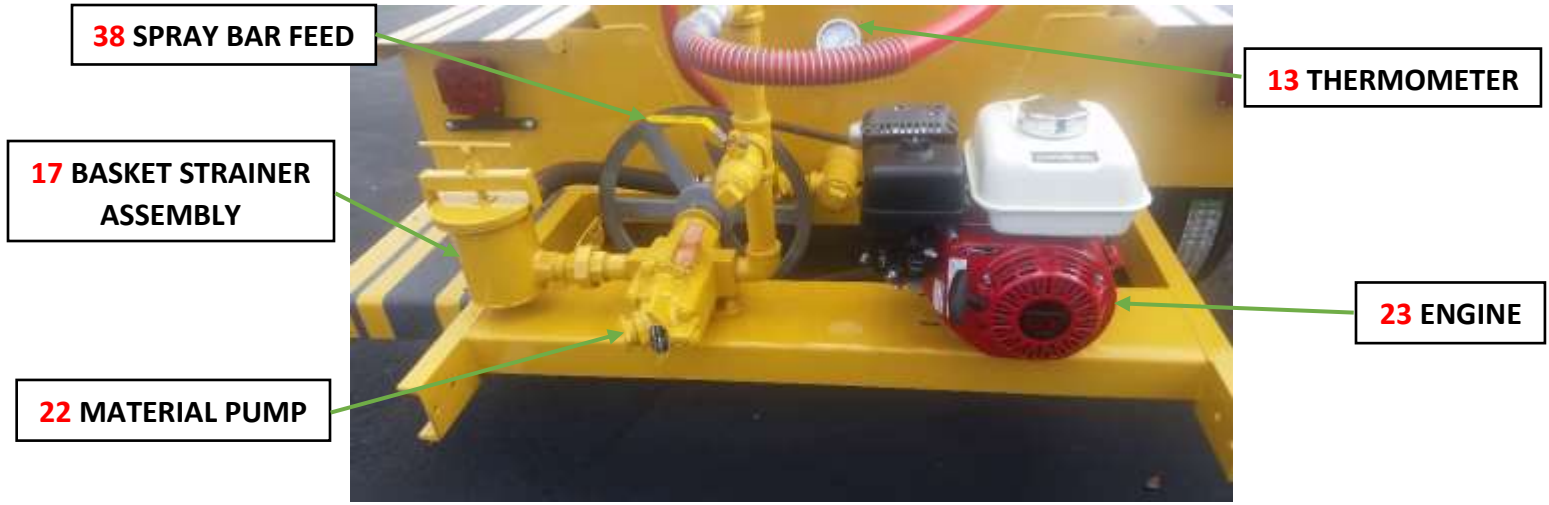

PICTURE - 2

PARTS LIST PICTURE – 2

ITEM #	PART#	QTY.	DESCRIPTION
13	P659A002	1	THERMOMETER
17	P50147B007	1	BASKET STRAINER COMPLETE
	P50147B010	1	BASKET STRAINER COMPLETE - OPTIONAL
22	P640A029	1	1-1/4" ROPER MATERIAL PUMP
	P640A084	1	2" ROPER MATERIAL PUMP - OPTIONAL
23	P458A022	1	ENGINE – HONDA 5HP
	P458A050	1	ENGINE – HONDA 8HP - OPTIONAL
38	P397A012	1	SPRAY BAR FEED VALVE-1-1/4" BALL
	P397A002	1	SPRAY BAR FEED VALVE-2" BALL - OPTIONAL

HEATED ASPHALT DISTRIBUTOR

APPLIES TO ALL TRAILER AND SKID VERSIONS

PARTS LIST

PICTURE - 3

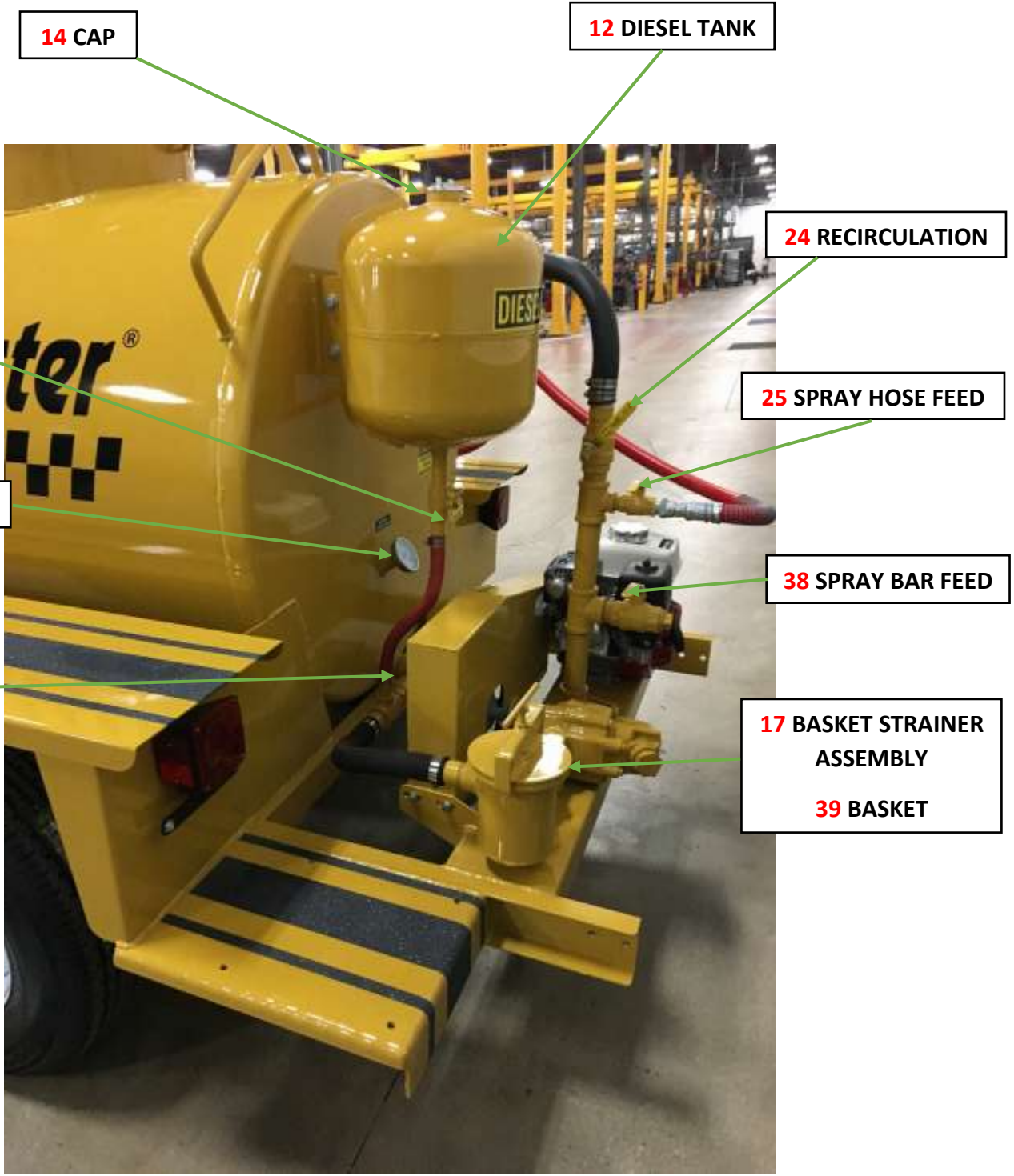

HEATED ASPHALT DISTRIBUTOR

APPLIES TO ALL TRAILER AND SKID VERSIONS

PARTS LIST

PARTS LIST PICTURE – 3

ITEM #	PART#	QTY.	DESCRIPTION
12	P50400B003	1	DIESEL TANK
13	P659A002	1	THERMOMETER
14	P464A002	1	TWIST CAP
15	P397A001	1	DIESEL FLUSH VALVE-3/4" BALL
16	P397A012	1	MAIN TANK VALVE-1-1/4" BALL BRASS
	P397A002	1	MAIN TANK VALVE- 2" BALL BRASS - OPTIONAL
	P397A002	1	GRAVITY VALVE- 2" BALL BRASS - OPTIONAL
17	P50147B007	1	BASKET STRAINER COMPLETE
	P50147B010	1	BASKET STRAINER COMPLETE - OPTIONAL
24	P397A012	1	RECIRCULATION VALVE-1-1/4" BALL
	P397A002		RECIRCULATION VALVE-2" BALL – OPTIONAL
25	P397A001	1	SPRAY HOSE FEED VALVE-3/4" BALL BRASS
38	P397A012	1	SPRAY BAR FEED VALVE-1-1/4" BALL
	P397A002	1	SPRAY BAR FEED VALVE-2" BALL - OPTIONAL
39	P50313B	1	STRAINER BASKET
	P50313A	1	STRAINER BASKET - OPTIONAL

HEATED ASPHALT DISTRIBUTOR

APPLIES TO ALL TRAILER AND SKID VERSIONS

OPERATING INSTRUCTIONS

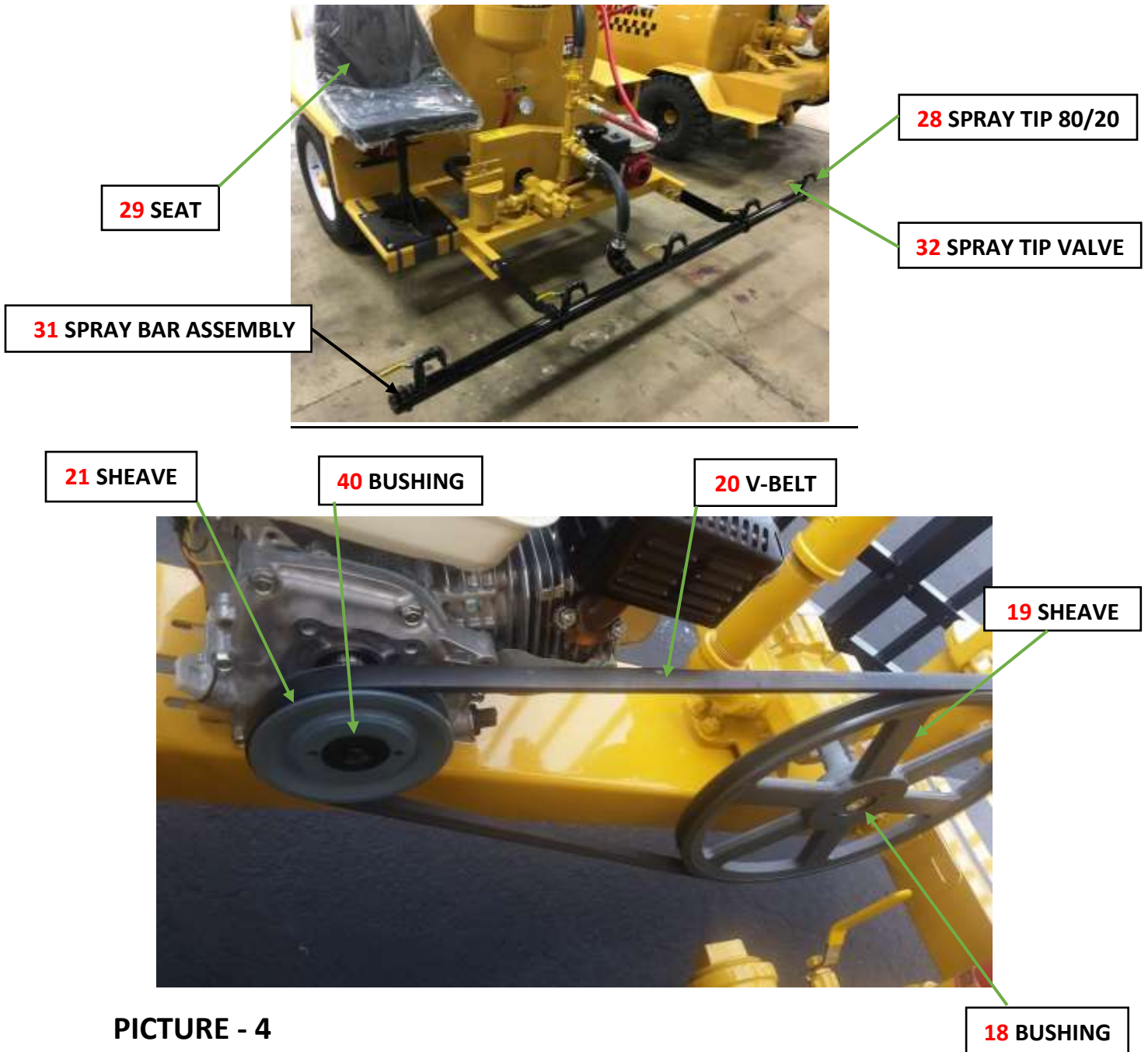

PICTURE - 4

HEATED ASPHALT DISTRIBUTOR

APPLIES TO ALL TRAILER AND SKID VERSIONS

PARTS LIST

PARTS LIST PICTURE – 4

ITEM #	PART#	QTY.	DESCRIPTION
18	P740A006	1	BUSHING 1" BORE
19	P661A033	1	SHEAVE 14-3/4" O.D.
20	P660A030	1	V-BELT B70
21	P661A034	1	SHEAVE 4-3/4" O.D.
28	P449A011	6	SPRAY TIP 80/20 1/4" NPT STEEL
29	P602A003	1	SEAT - OPTIONAL
31	P50246TAW	1	SPRAY BAR ASSEMBLY - OPTIONAL
32	P397A009	5	SPRAY TIP VALVE-1/2" BALL BRASS
40	P740A043	1	BUSHING 3/4" BORE

HEATED ASPHALT DISTRIBUTOR

APPLIES TO ALL TRAILER AND SKID VERSIONS

PARTS LIST



27 SPRAY WAND VALVE

28 SPRAY TIP 80/20

PICTURE - 5

41 SPRAY WAND ASSEMBLY

37 COUPLERS

26 SPRAY HOSE

35 SAFETY BREAK-AWAY

55 SPRAY BAR
LEVER-KIT

45 TRAILER
PLUG

44 HOOK

36 JACK

43 SAFETY CHAIN

33 AXLE

34 TIRE



HEATED ASPHALT DISTRIBUTOR

APPLIES TO ALL TRAILER AND SKID VERSIONS

PARTS LIST

PARTS LIST PICTURE – 5

ITEM #	PART#	QTY.	DESCRIPTION
26	P754B025	1	SPRAY HOSE – 50 FT.
27	P397A010	1	SPRAY WAND VALVE-3/4" BALL CARBON STEEL
28	P449A011	6	SPRAY TIP 80/20 1/4" NPT STEEL
33	P511A013	1	TR 300 AXLE
33	P511A013	2	TR 575 AXLE
34	P514A017	2	TR 300 TIRE ASSEMBLY
34	P514A017	4	TR 575 TIRE ASSEMBLY
35	P518A008	1	BREAKAWAY KIT – 4 BOLTS
	P518A004	1	BREAKAWAY KIT BEFORE 10/2019
36	P551A008	1	JACK ASSEMBLY
37	P553A008	*	2-5/16" BALL COUPLER
37	P646A003	*	PINTLE EYE COUPLER
41	P50273E	1	SPRAY WAND ASSEMBLY
43	P531A004	2	SAFETY CHAIN
44	P517A002	2	HOOK (PART OF SAFETY CHAIN)
45	P51PA007	1	TRAILER PLUG
55	P50247LK	1	SPRAY BAR LEVER KIT

HEATED ASPHALT DISTRIBUTOR

APPLIES TO OPTIONAL HYDRAULIC DRIVE VERSIONS

OPERATING INSTRUCTIONS WITH HYDRAULIC DRIVE

STARTUP

CHECKLIST

- Check engine oil level. Follow manufacturer's guidelines as to type and frequency of changes.
- Check hydraulic oil level. Use grade AW68 hydraulic oil.
- Fill fuel tank with gasoline for the engine.

BEFORE STARTING THE ENGINE

Make sure the material pump control valve #46 is in the neutral position.

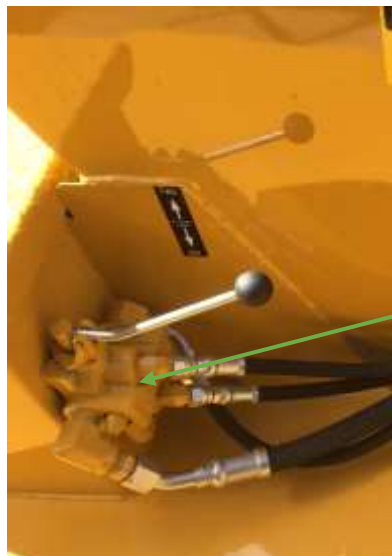

**46 MATERIAL PUMP
CONTROL VALVE**

HEATED ASPHALT DISTRIBUTOR

APPLIES TO OPTIONAL HYDRAULIC DRIVE VERSIONS

OPERATING INSTRUCTIONS WITH HYDRAULIC DRIVE

STARTUP



STARTING THE ENGINE

- Set the **fuel** shutoff and **choke** levers to the **on** position.
- Set the throttle lever at ½ open.
- Turn the **engine** switch to the start position.



- It is important that when you are done running the engine that the **fuel** shutoff lever is turned to the **off** position. This keeps gasoline from mixing with oil as you are driving.

Refer to the engine manual.

HEATED ASPHALT DISTRIBUTOR

APPLIES TO OPTIONAL HYDRAULIC DRIVE VERSIONS

OPERATING INSTRUCTIONS WITH HYDRAULIC DRIVE

HEATING THE MATERIAL

1. Attach Nut & Nipple #1 to your LP Gas tank.



The burner uses vapor propane, **NOT** liquid.

2. Slowly open the valve on the LP Gas Tank. Opening too fast can cause a check valve to slam closed, reducing the available flow of gas.
3. Regulator #3 is pre-set for 30 psi. Turn the knob counter-clockwise to lower the pressure. The burner #11, is rated for maximum heat output at 30 psi. Open gas shut-off valve #7 slightly, depress the red push on gas pilot valve #8. This allows gas to flow thru the burner, at the same time use the striker flint #10 to produce a spark. Strike repeatedly until the gas ignites.



If the gas does not light within 5 seconds, release the red push button and wait 10 minutes before trying again.

Once you have ignition, you must continue to depress the red push button on gas pilot valve #8 for at least 10 seconds. This allows the thermocouple #9 to heat up, allowing the gas valve to continue the gas flow. If the flame stays on, then open gas shut-off valve #7 all the way to get maximum heat from the burner.



If the flame goes out, you will need to start over with the lighting process. Anytime you want to decrease the flame intensity, slightly close gas shut-off valve #7.

4. The thermocouple #9 also acts as a safety. Should the flame go out because of wind, the thermocouple immediately starts to cool off and stops the signal to the gas valve, which then stops the flow of gas. This may take up to 30 seconds.



WAIT 10 MINUTES BEFORE TRYING TO RE-LIGHT THE BURNER.

5. Monitor material temperature on thermometer #13. As the material reaches the desired temperature you can slightly close gas shut-off valve #7 to decrease the flame, or just shut off the valve completely.



NEVER DRIVE WITH THE BURNER LIT!!

PUMPING MATERIAL

6. Open main tank valve #16 and recirculation valve #24. Close all other valves.
7. Start engine #23 only after reading the engine manual, provided with your machine. Engine speed will determine the gallons per minute pumped.
8. Start by recirculating material. The material pump #22 draws material from the tank, thru the basket strainer #17, thru the recirculation valve #24 and into the top of the tank.
9. Uncoil the spray hose from the side hangars on the tank. Open spray hose feed valve #25 and spray wand valve #27. Slowly start to close recirculation valve #24. This will send some product down the spray hose and out the wand spray tip 80/20 #28. Partially closing this valve allows you to adjust the desired spray pressure.

NEVER CLOSE RECIRCULATION VALVE #24 COMPLETELY

SPRAY BAR

10. When using the spray bar #31, spray hose feed valve #25 and spray wand valve #27 remain closed. Once you have recirculated product, slowly close recirculation valve #24. Open spray tip valves #32 on the spray bar #31. Position the machine, motion for the driver to start forward at approx. 4mph, open spray bar feed valve #38, and also the #55 spray bar lever, to start spraying. This opens all of the spray tip valves #32 at the same time. Once again, recirculation valve #24 determines spray pressure, adjust accordingly.
11. The throttle on the engine #23 needs to be set to 3/4 or full position to ensure there is enough speed is available for the material pump #22.
12. Run the pump pressure and speed at the lowest acceptable application pressure to help reduce overspray.
13. You can control pressure by using the recirculation valve #24.
14. Close spray bar feed valve #38 or the #55 spray bar lever when you reach the end of your pass, leave all the pump controls set. The spray will continue when you open the spray bar feed valve #38 or the #55 spray bar lever.
15. Position the tires right next to the previous pass, this will give you the proper overlap.

16. When finished spraying, move the material pump control valve #46 to the reverse position and close the recirculation valve #24. This suctions back the material left in the spray hose. Close main tank valve #16 and return the material pump control valve #46 to the neutral position.
17. Begin the diesel flush.

 **note** Do the same procedure when using the spray bar #31.

DIESEL FLUSH

18. Close main tank valve #16 and recirculation valve #24. Start engine #23.
19. Open diesel flush valve #15 on the bottom of the diesel tank #12.
20. Open spray hose feed valve #25 and spray wand valve #27 to flush the spray hose and wand. To flush the spray bar open spray bar feed valve #38 or the #55 spray bar lever on the spray bar #31 to the open position. When done, turn off the engine and close all open valves.
21. Use only *diesel fuel* for flushing purposes.
22. Remove the lid from the basket strainer #17 and clean the basket.

 **note** Anytime you notice the spray pressure is decreasing, the basket strainer #17 probably needs to be cleaned. Make sure you close main tank valve #16 before you remove the lid.

MAINTENANCE TIPS

23. The material pump #22 has a mechanical seal, some leakage is normal. When the seal plate cannot be tightened any more, the seal must be replaced.
24. The orifice is inside burner #11, needs to be cleaned occasionally. Soot and spider webs can cause blockage of the flow of gas.
25.  **note** Always leave the LP gas hose #6 connected to a tank. If left disconnected, insects will make their nest inside of it and block the flow of gas.

HEATED ASPHALT DISTRIBUTOR

APPLIES TO OPTIONAL HYDRAULIC DRIVE VERSIONS

PARTS LIST

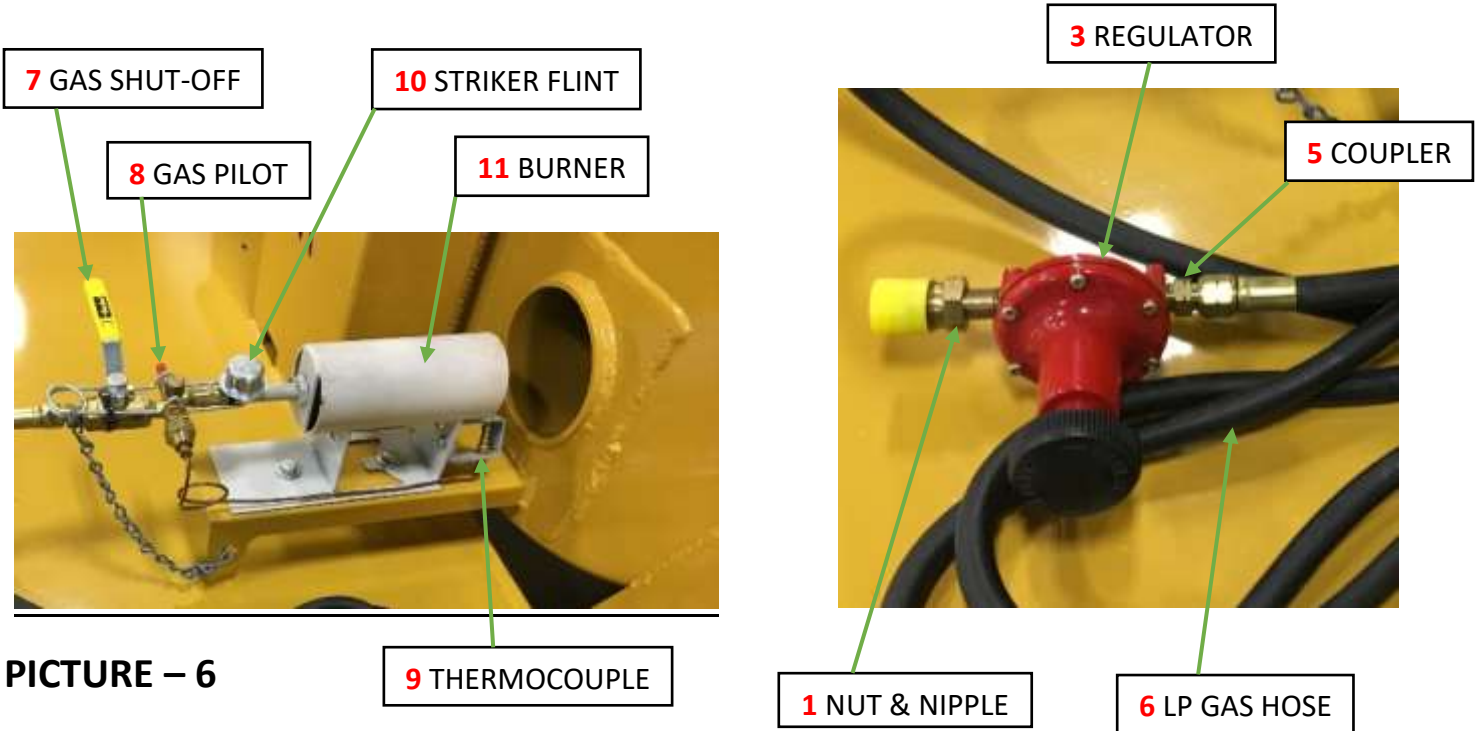

PICTURE – 6

PARTS LIST PICTURE – 6

ITEM #	PART#	QTY.	DESCRIPTION
1	P933A001	1	NUT AND NIPPLE
3	P735A015	1	REGULATOR
5	P935A001	2	COUPLER
6	P669A005	1	LP GAS HOSE – 10 FT.
7	P397A011	1	GAS SHUT-OFF VALVE
8	P735A016	1	GAS PILOT VALVE
9	P679A003	1	THERMOCOUPLE 24"
10	SS107A1	1	STRIKER FLINT
11	P662A003	1	BURNER COMPLETE

HEATED ASPHALT DISTRIBUTOR

APPLIES TO OPTIONAL HYDRAULIC DRIVE VERSIONS

PARTS LIST



PICTURE - 7

PARTS LIST PICTURE – 7

ITEM #	PART#	QTY.	DESCRIPTION
23	P458A022	1	ENGINE – HONDA 5HP
	P458A050	1	ENGINE – HONDA 8HP - OPTIONAL
49	P601A041	1	HYDRAULIC PUMP - OPTIONAL
50	P630A032	1	JAW COUPLER - OPTIONAL
	P630A045	1	JAW COUPLER - OPTIONAL
	P631A005	1	COUPLER INSERT FOR JAW COUPLER - OPTIONAL
	P604A004	1	ACCESS COVER - OPTIONAL
	P604A003	1	PUMP MOUNTING BRACKET - OPTIONAL
53	P909A002	1	FILTER HEAD (SMALL) - OPTIONAL
54	P908A003	1	FILTER – OIL - OPTIONAL

HEATED ASPHALT DISTRIBUTOR

APPLIES TO OPTIONAL HYDRAULIC DRIVE VERSIONS

PARTS LIST

PICTURE - 8

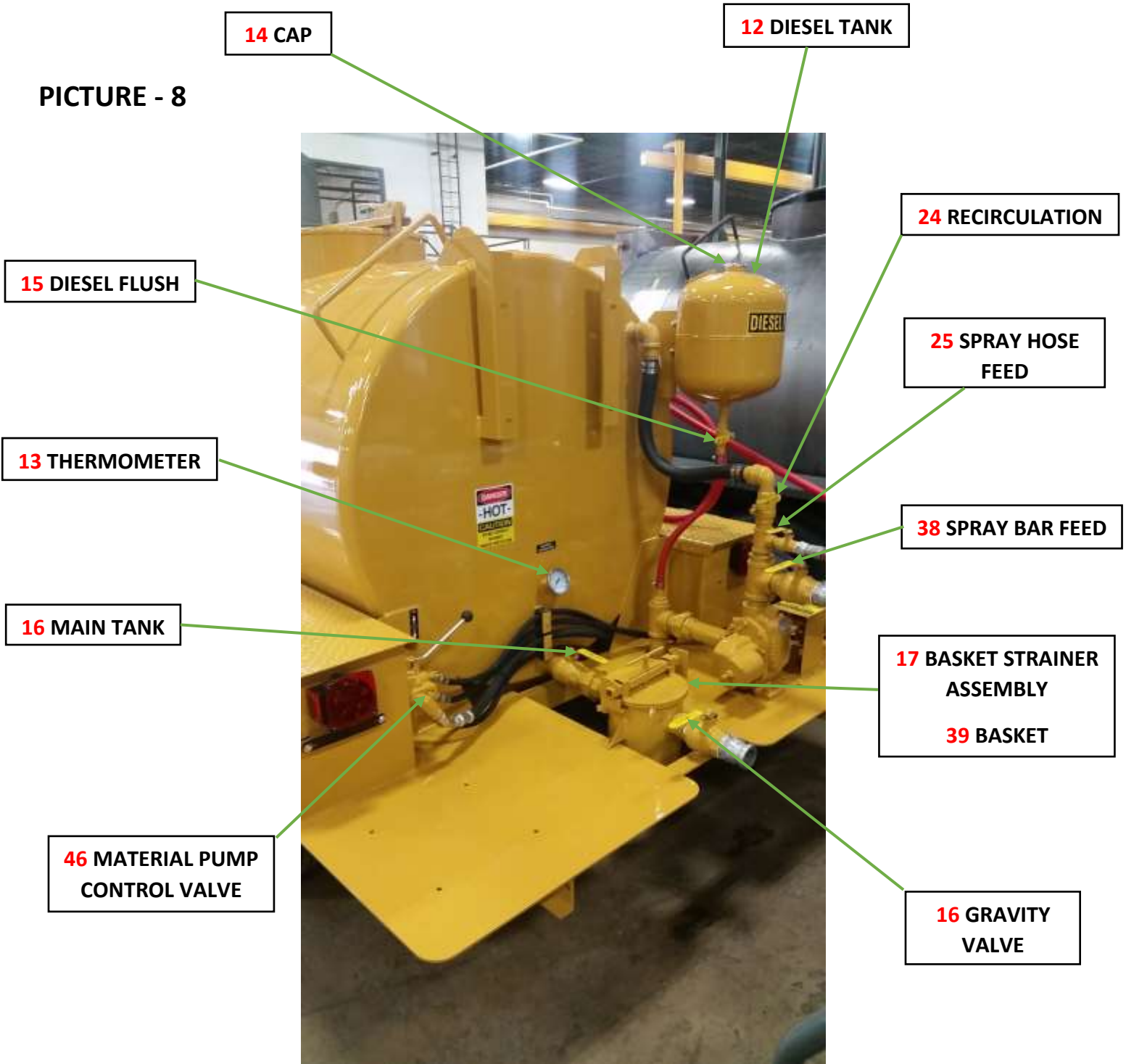

HEATED ASPHALT DISTRIBUTOR

APPLIES TO OPTIONAL HYDRAULIC DRIVE VERSIONS

PARTS LIST

PARTS LIST PICTURE – 8

ITEM #	PART#	QTY.	DESCRIPTION
12	P50400B003	1	DIESEL TANK
13	P659A002	1	THERMOMETER
14	P464A002	1	TWIST CAP
15	P397A001	1	DIESEL FLUSH VALVE-3/4" BALL
16	P397A012	1	MAIN TANK VALVE-1-1/4" BALL BRASS
	P397A002	1	MAIN TANK VALVE- 2" BALL BRASS - OPTIONAL
	P397A002	1	GRAVITY VALVE- 2" BALL BRASS - OPTIONAL
17	P50147B007	1	BASKET STRAINER COMPLETE
	P50147B010	1	BASKET STRAINER COMPLETE - OPTIONAL
24	P397A012	1	RECIRCULATION VALVE-1-1/4" BALL
	P397A002		RECIRCULATION VALVE-2" BALL – OPTIONAL
25	P397A001	1	SPRAY HOSE FEED VALVE-3/4" BALL BRASS
38	P397A012	1	SPRAY BAR FEED VALVE-1-1/4" BALL
	P397A002	1	SPRAY BAR FEED VALVE-2" BALL - OPTIONAL
39	P50313B	1	STRAINER BASKET
	P50313A	1	STRAINER BASKET - OPTIONAL
46	P472A016	1	MATERIAL PUMP CONTROL VALVE - OPTIONAL
	P939A025	1	HYD. VALVE – SEAL KIT (Brand M)

HEATED ASPHALT DISTRIBUTOR

APPLIES TO OPTIONAL HYDRAULIC DRIVE VERSIONS

PARTS LIST

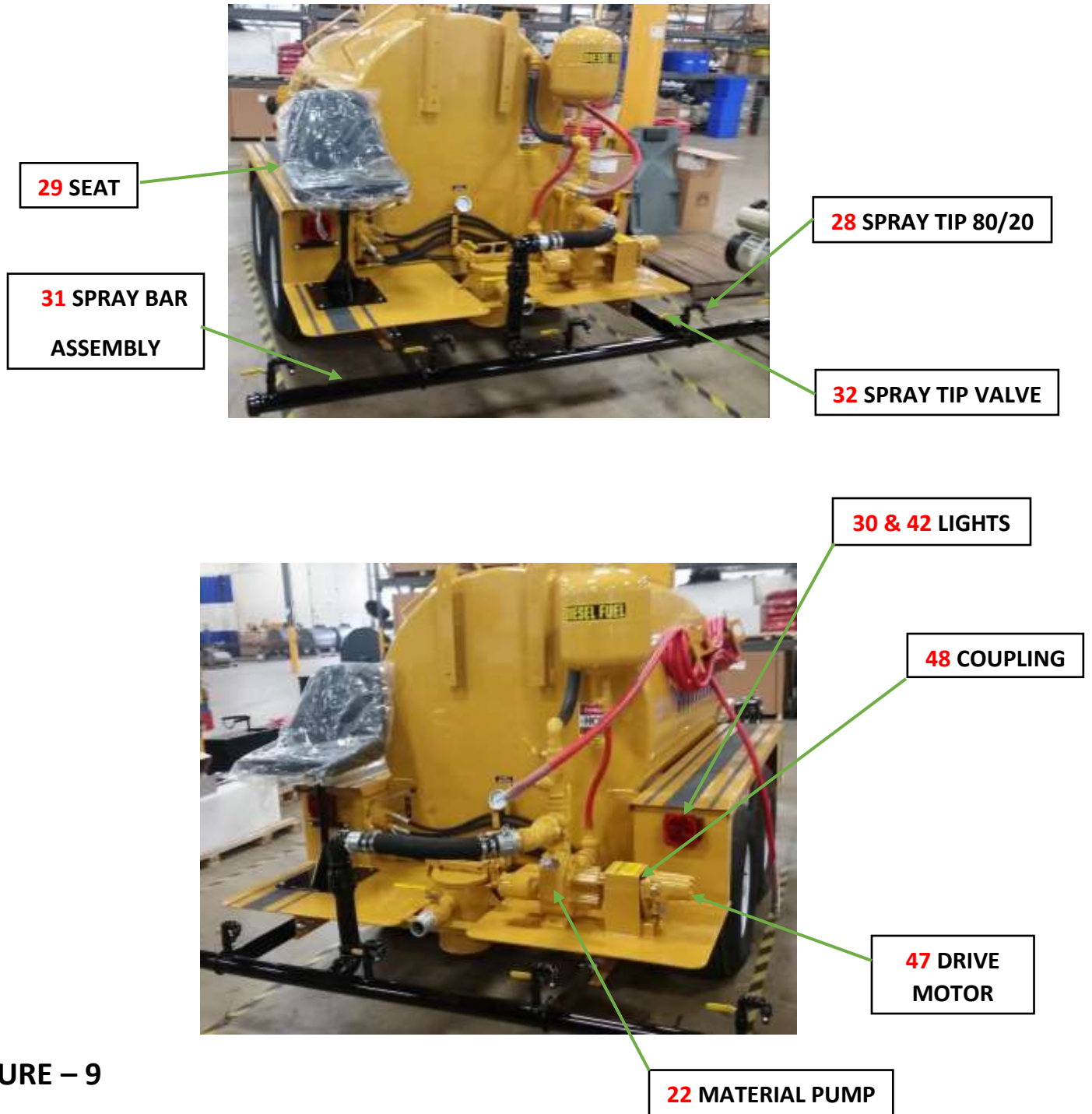

PICTURE – 9

HEATED ASPHALT DISTRIBUTOR

APPLIES TO OPTIONAL HYDRAULIC DRIVE VERSIONS

PARTS LIST

PARTS LIST PICTURE – 9

ITEM #	PART#	QTY.	DESCRIPTION
22	P640A029	1	1-1/4" ROPER MATERIAL PUMP
	P640A084	1	2" ROPER MATERIAL PUMP - OPTIONAL
28	P449A011	6	SPRAY TIP 80/20 1/4" NPT STEEL
29	P602A003	1	SEAT - OPTIONAL
30	P516A025	1	LEFT SIDE TAIL LIGHT
31	P50246TAW	1	SPRAY BAR ASSEMBLY - OPTIONAL
32	P397A009	5	SPRAY TIP VALVE-1/2" BALL BRASS
42	P516A024	1	RIGHT SIDE TAIL LIGHT
47	P474A087	1	HYDRAULIC DRIVE MOTOR - OPTIONAL
48	P498A002	1	COUPLING - OPTIONAL

HEATED ASPHALT DISTRIBUTOR

APPLIES TO OPTIONAL HYDRAULIC DRIVE VERSIONS

PARTS LIST

PICTURE -10



27 SPRAY WAND VALVE

28 SPRAY TIP 80/20

55 SPRAY BAR LEVER-KIT



26 SPRAY HOSE

41 SPRAY WAND ASSEMBLY

37 COUPLER

35 SAFETY BREAK-AWAY

52 RATCHET TIE DOWN

PICTURE -11



45 TRAILER PLUG

36 JACK

51 LIGHTS

33 AXLE

34 TIRE

44 HOOK

43 SAFETY CHAIN

HEATED ASPHALT DISTRIBUTOR

APPLIES TO OPTIONAL HYDRAULIC DRIVE VERSIONS

PARTS LIST

PARTS LIST PICTURE – 10

ITEM #	PART#	QTY.	DESCRIPTION
26	P754B025	1	SPRAY HOSE – 50 FT.
27	P397A010	1	SPRAY WAND VALVE-3/4" BALL CARBON STEEL
28	P449A011	6	SPRAY TIP 80/20 1/4" NPT STEEL
41	P50273E	1	SPRAY WAND ASSEMBLY
55	P50247LK	1	SPRAY BAR LEVER KIT

PARTS LIST – **TRAILERS ONLY** * DENOTES YOUR CHOICE

PARTS LIST PICTURE – 11

ITEM #	PART#	QTY.	DESCRIPTION
33	P511A013	1	TR 300 AXLE
34	P514A017	2	TR 300 TIRE ASSEMBLY
33	P511A013	2	TR 575 AXLE
34	P514A017	4	TR 575 TIRE ASSEMBLY
35	P518A008	1	BREAKAWAY KIT – 4 BOLTS
	P518A004	1	BREAKAWAY KIT BEFORE 10/2019
36	P551A008	1	JACK ASSEMBLY
37	P553A008	*	2-5/16" BALL COUPLER
37	P646A003	*	PINTLE EYE COUPLER
43	P531A004	2	SAFETY CHAIN
44	P517A002	2	HOOK (PART OF SAFETY CHAIN)
45	P51PA007	1	TRAILER PLUG
51	P467A016	2	AMBER MARKER LIGHT
52	P422A003	1	RATCHET TIE DOWN

HEATED ASPHALT DISTRIBUTOR

APPLIES TO ALL TRAILER AND SKID VERSIONS

HEATED TACK TANK MACHINE MAINTENANCE MAINTENANCE SCHEDULE

MAINTAIN	8 HRS	25 HRS	1 WEEK	1 MONTH	1 YEAR
TIGHTEN V-BELT	✓		✓	✓	
REPLACE V-BELT					✓
TIGHTEN PUMP PACKING		✓		✓	
TORQUE WHEEL NUTS	✓				✓
GREASE WHEEL BEARINGS					✓
INSPECT BRAKE LININGS					✓
REPLACE SPRAY HOSE					✓
REPLACE BURNER THERMOCOUPLE					✓
CLEAN BURNER ORIFICE					✓
CLEAN OUTSIDE OF BURNER TUBE					✓
CHANGE ENGINE OIL*					
CHECK TIRE PRESSURE	✓			✓	
CHECK BREAKAWAY BOX	✓				
CLEAN STRAINER BASKET	✓				

CHANGE ENGINE **OIL*** OIL SPECIFICATIONS / REFER TO ENGINE MANUAL

Honda Recommends 20hrs Initial Start / every 100hrs or 6 mons. After

HEATED ASPHALT DISTRIBUTOR

APPLIES TO ALL TRAILER AND SKID VERSIONS

HEATED TACK TANK MACHINE MAINTENANCE

TROUBLESHOOTING GUIDE

PROBLEM	POSSIBLE CAUSES/SOLUTIONS
ENGINE SPECIFICATIONS	OIL SPECIFICATIONS / REFER TO ENGINE MANUAL
	OPERATING INSTRUCTIONS / REFER TO ENGINE MANUAL
ENGINE WILL NOT START	FUEL IN OIL CRANKCASE / CLEAN CRANKCASE, KEEP FUEL SHUT-OFF VALVE IN OFF POSITION WHEN FINISHED
MATERIAL PUMP MATERIAL FLOW IS REDUCED	BASKET STRAINER IS PLUGGED / CLEAN THE BASKET
	PLUMBING LEADING TO PUMP IS PLUGGED / UNPLUG
	PUMP WORN / NEEDS NEW GEARS OR REPLACED
	BELT IS SLIPPING / TIGHTEN
	RELIEF VALVE STUCK OPEN / CLEAN THE SEAT
MATERIAL PUMP MATERIAL LEAKS FROM AROUND THE PUMP SHAFT	PACKING AROUND THE PUMP SHAFT / REMOVE THE PACKING GLAND, ADD NEW PACKING RINGS AND RE-INSTALL THE GLAND
LP GAS BURNER BURNER WILL NOT STAY LIT	THERMOCOUPLE / NEEDS REPLACED
LP GAS BURNER FLAME IS SMALLER	OBSTRUCTION IN HOSE / CLEAN OUT HOSE
	BURNER ORIFICE BLOCKED/ CLEAN ORIFICE

HEATED ASPHALT DISTRIBUTOR

APPLIES TO ALL TRAILER AND SKID VERSIONS

HEATED TACK TANK MACHINE MAINTENANCE

HOW TO WINTERIZE YOUR EQUIPMENT

1. Turn on the Material Pump and open the Spray Wand and Spray Bar until the Tank is empty. Open the recirculation valve for a brief moment, then close it.
2. Run Diesel Fuel through Material Pump.
3. Disconnect the Battery and take it inside. Charging the battery will maintain it to last thru the offseason.
4. Cover the Engine with a plastic bag.
5. Cover the Cap on top of the hydraulic tank.
6. Clean Basket Strainer and line leading to the Tank.

In the winter, when the temperature is below freezing, get inside of the tank with proper hearing protection and an air chipping gun with a 1" spade bit and chip off all remaining sealer from the walls and heater pipe.

NOTE: If you do not do this, the dried material will come off all during the season causing the basket strainer and spray tips to plug.

WIRING DIAGRAMS

ELECTRIC BRAKES AND RUNNING LIGHTS

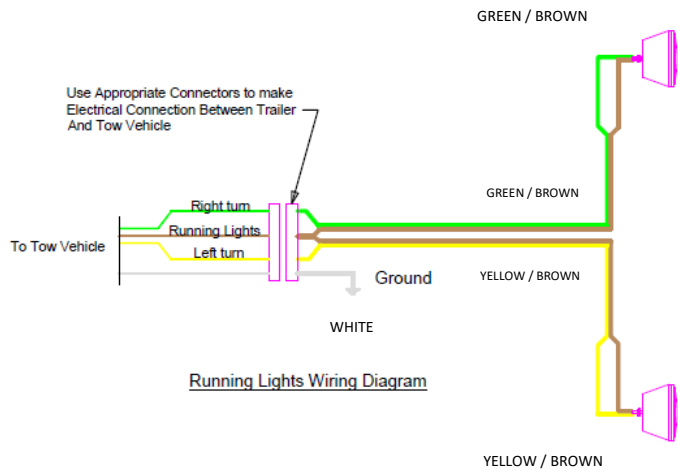
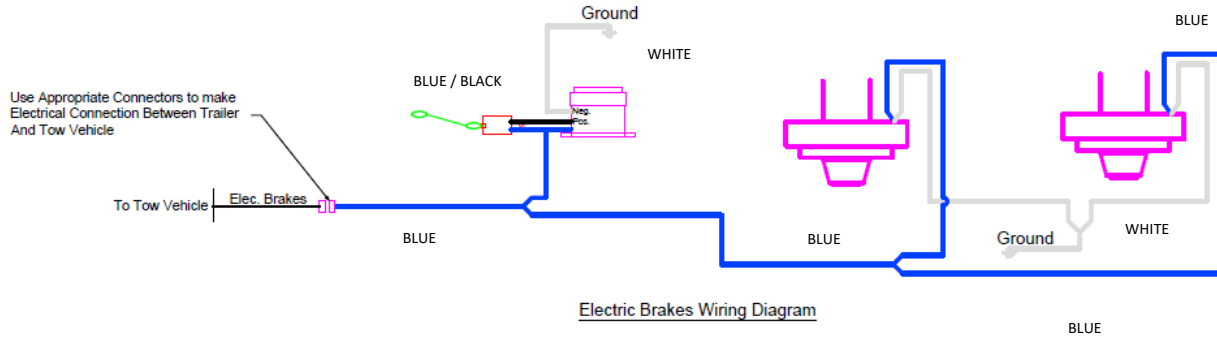

TANK CAPACITY CHART					
GALLONS ARE APPROXIMATE AND MAY VARY SLIGHTLY TANK TO TANK					
MATERIAL DEPTH AND GALLON VOLUME					
MATERIAL DEPTH	300 GALLONS 41"x54"	575 GALLONS 48"x74"	MATERIAL DEPTH	300 GALLONS 41"x54"	575 GALLONS 48"x74"
INCHES	GALLONS	GALLONS	INCHES	GALLONS	GALLONS
1	2	3	25	197	305
2	6	8	26	206	321
3	10	15	27	216	336
4	15	23	28	225	351
5	21	32	29	233	366
6	28	42	30	242	381
7	35	52	31	250	396
8	42	64	32	258	411
9	50	75	33	266	425
10	58	87	34	274	439
11	67	100	35	281	453
12	75	113	36	287	466
13	84	127	37	293	479
14	93	141	38	298	492
15	102	155	39	303	504
16	112	169	40	307	516
17	121	184	41	309	527
18	130	199	42		538
19	140	214	43		548
20	150	229	44		557
21	159	244	45		565
22	169	259	46		571
23	178	274	47		577
24	188	290	48		580

HEATED ASPHALT DISTRIBUTOR

APPLIES TO **TR 300 & SK 300** AND **TR 575** HOT TACK

ROPER 1-1/4" PUMP

PARTS LIST

ITEM	DESCRIPTION	S/M PART #	QTY.
	PUMP - ROPER 1-1/4"	P640A029	1
1	HEX HD. CAP SCREW	P899A022	2
2	PACKING PLATE	P899A001	1
3	PACKING BUSHING	P899A002	1
4	PACKING SET	P899A003	1
5	PACKING WASHER	P899A004	1
6	BACKPLATE ASSEMBLY	P899A005	1
	BUSHING	P899A012	2
7	DOWEL PIN	P899A023	4
8	GASKET	P899A006	3
9	RETAINING RING	P899A007	2
10	KEY	P899A024	1
11	KEY	P899A024	1
12	DRIVE SHAFT	P899A008	1
13	DRIVE GEAR	P899A009	1
14	IDLER GEAR & SHAFT	P899A010	1
15	CASE	P899A013	1
16	RELIEF VALVE ASSEMBLY	P899A027	1
17	FACEPLATE ASSEMBLY R.V.	P899A014	1
18	POPPET	P899A015	1
19	SPRING	P899A016	1
20	NUT, LOCK & SEAL	P899A017	1
21	HEX HD. CAP SCREW	P899A019	2
22	HEX HD. CAP SCREW	P899A021	2
23	HEX HD. CAP SCREW	P899A020	4
24	NAMEPLATE	P899A028	1
25	DRIVE SCREW	P899A029	2
26	ADJUSTMENT SCREW	P899A018	1

WEARABLE PARTS –HIGH LIGHTED IN YELLOW

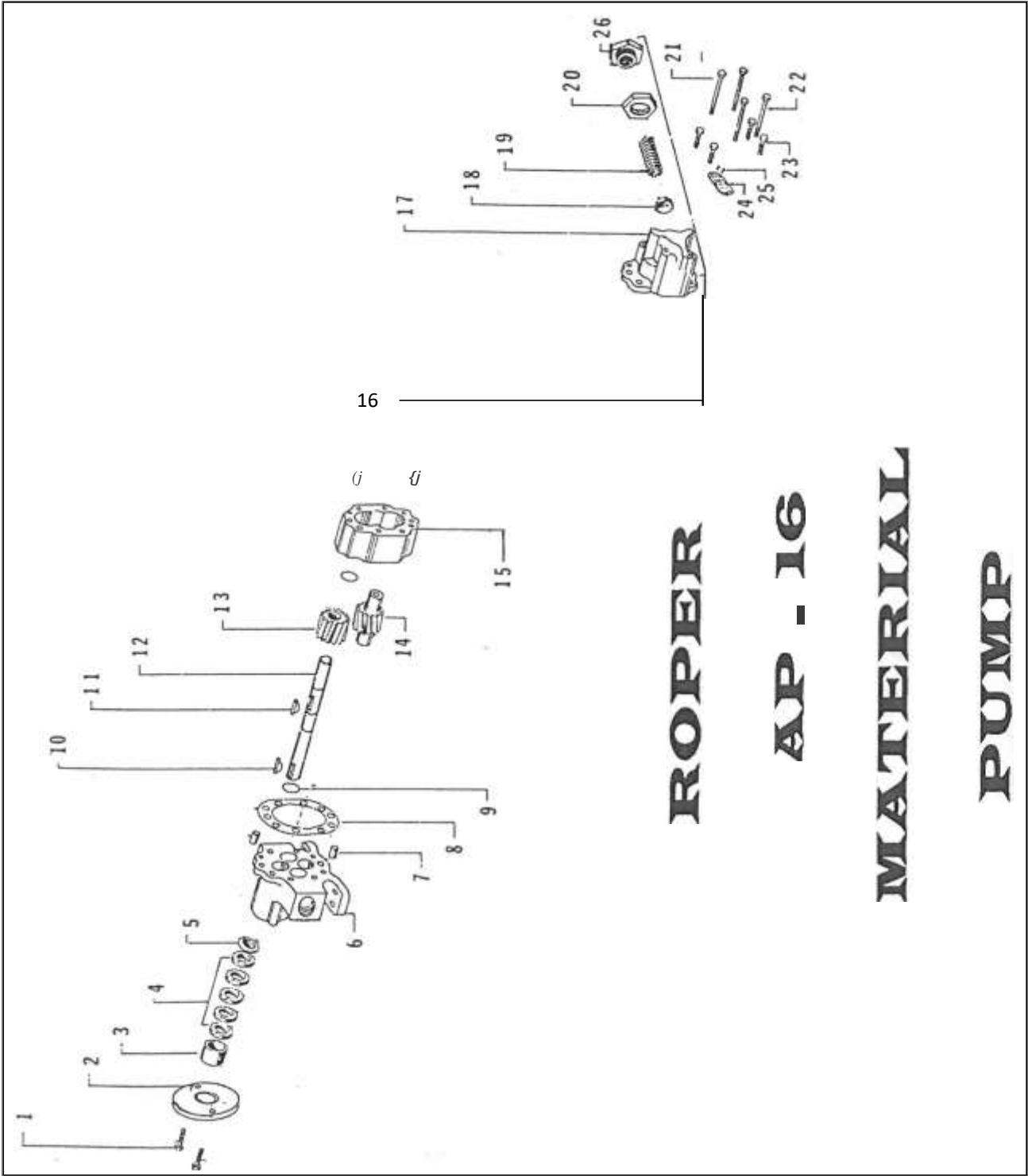

ROPER
AP - 16
MATERIAL
PUMP

PUMP DIAGRAM

HEATED ASPHALT DISTRIBUTOR

APPLIES TO **TR 300 & SK 300** AND **TR 575** HOT TACK

WITH **OPTIONAL HYDRAULIC DRIVE** VERSIONS

ROPER 2" PUMP 3611 HZRV

PARTS LIST

ITEM	DESCRIPTION	S/M PART #	QTY.
	PUMP - ROPER 2"	P640A084	1
1	WASH. HD. CAP SCREW	P904A013	4
2	HEX HD. CAP SCREW	P904A014	16
7	GASKET, CASE	P904A004	2
8	DOWEL PIN, HOLLOW	P904A016	4
9	LOCK NUT	P904A017	2
10	CLIP, PACKING GLAND	P905A005	2
11	PACKING GLAND	P904A002	1
12	SQ. HEAD BOLT	P904A018	2
13	CLIP, SPRING	P906A018	1
14	PACKING SET	P904A001	1
15	WASHER – PACKING	P905A008	1
20	DRIVE SCREW	P904A019	2
21	NAMEPLATE	P904A031	1
22	PIPE PLUG	P904A020	4
23	CASE	P905A009	1
29	IDLER SHAFT	P904A007	1
30	KEY	P904A021	3
31	DRIVE SHAFT	P905A011	1
32	GEAR LEFT HAND	P905A013	1
33	GEAR RIGHT HAND	P904A009	1
35	FACEPLATE ASSEMBLY	P904A010	1
	BRG. LONG BRONZE	P904A003	2
36	POPPET	P904A022	1
37	POPPET ADAPTER	P904A023	1
38	SPRING -STANDARD	P904A024	1
39	GUIDE - SPRING	P904A026	1
40	GASKET - CAP	P904A027	1
41	PLUG CAP	P904A028	1
42	NUT – LOCK AND SEAL	P904A029	1
43	ADJUSTING SCREW	P904A030	1

WEARABLE PARTS –HIGH LIGHTED IN **YELLOW**

HEATED ASPHALT DISTRIBUTOR

APPLIES TO **TR 300 & SK 300** AND **TR 575** HOT TACK

WITH **OPTIONAL HYDRAULIC DRIVE** VERSIONS

ROPER 2" PUMP 3611 HZRV

PUMP DIAGRAM

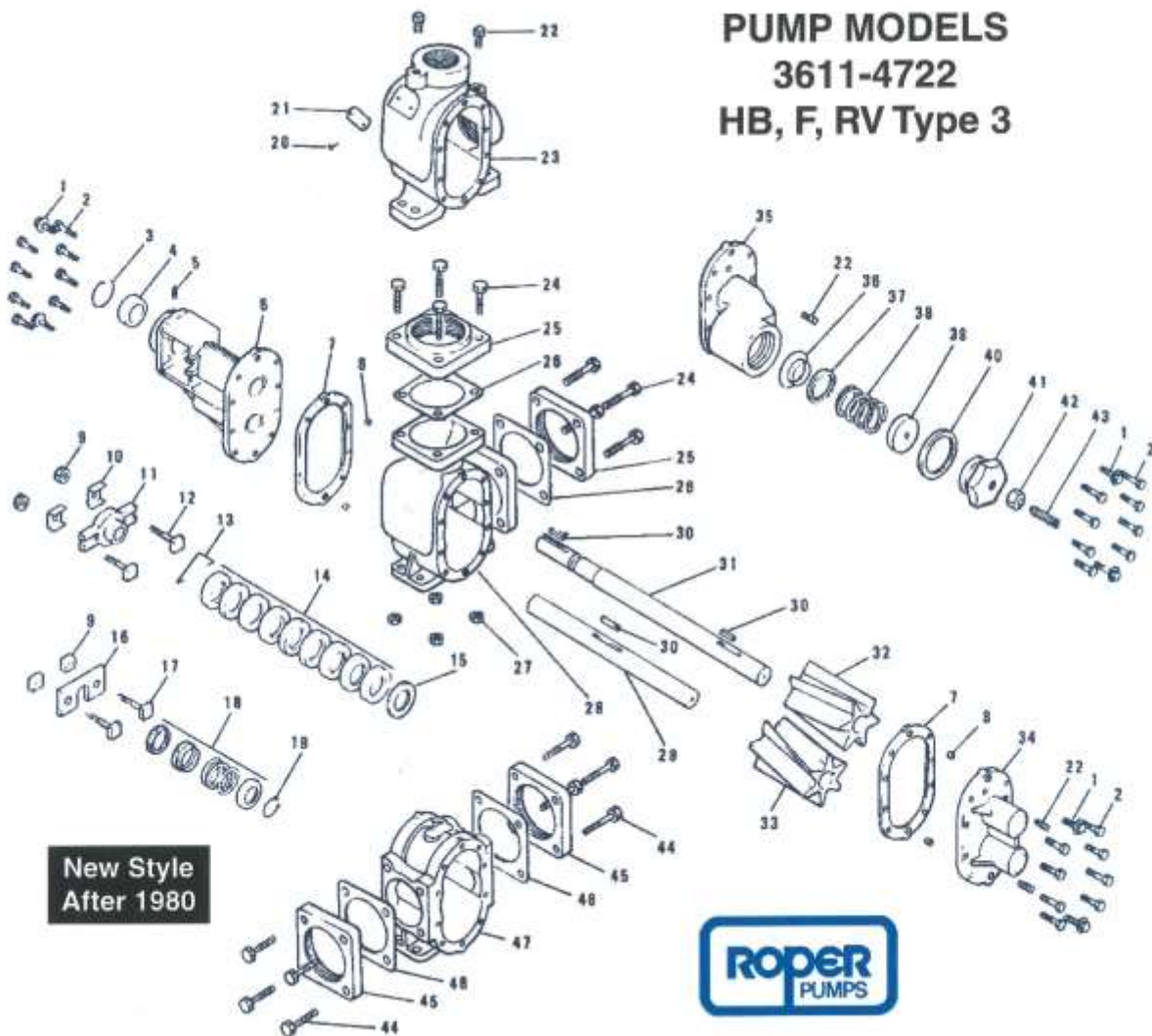

MAINTENANCE AND STORAGE

MAINTENANCE

During the lubrication stop, inspect all operating parts. Should any damage or excessive wear be evident, replace parts immediately. Straighten any parts as soon as possible.

Clean and re-paint all exposed parts using touch-up kit P3020B034 **yellow** paint or touch-up kit P3020B033 **black** paint.

STORAGE

Perform all required maintenance and lubrication procedures. Coat all shafts with grease.

Clean and re-paint all exposed parts using touch-up kit P3020B034 **yellow** paint or touch-up kit P3020B033 **black** paint.

Each touch-up kit includes:

1-pint paint can --- 1 pair of gloves --- 1 touch-up paintbrush

