

CRACK PRO 2500 & TEXTURED SPRAY UNIT

Owner's Manual



SealMaster®



Pavement Products & Equipment

PO Box 2277 • Sandusky, Ohio 44870 • 419-626-4375

SealMaster®



ThorWorks Industries Inc. Limited Warranty for Equipment

ThorWorks warrants that its products are of quality material and workmanship. ThorWorks agrees to replace, within a one (1) year period from date of delivery, or at its option, repair without charge, any part of their manufacture which proved defective. The repair or replacement will be free of charge F.O.B. Sandusky Ohio, providing the damaged part or parts are returned freight prepaid to ThorWorks and investigation show such repair or replacement is made necessary by inherent defect of material or workmanship. Obvious damage by misuse or abuse voids any liability on ThorWorks part. Should you request the replacement part or parts be sent via 'next day air', you will be charged the difference between ground service and 'next day air'.

It is hereby understood that engines, motors, pumps, or other components purchased by ThorWorks for use on its equipment are not warranted by ThorWorks and are sold only with the standard warranty of the manufacturer of that component. ThorWorks will send the returned component back to the respective manufacturer for evaluation. Should the manufacturer deny the warranty claim, then ThorWorks will not honor any warranty and you will be required to pay ThorWorks for the replacement item that was shipped to you.

Any claims for defective material or workmanship must be made prior to the expiration of thirty (30) days from the date the failure occurs, and in all cases prior to the expiration of the warranty period of one (1) year. It is the intent of this paragraph to limit ThorWorks liability solely to the cost of replacement parts, F.O.B. factory, or at the option of ThorWorks, to repair of the defective part or parts. No allowances for damages, lost revenues or lost time will be recognized.

This warranty is null and void if other than genuine ThorWorks parts are used. ThorWorks is constantly striving to improve their products. Changes in design and improvement will be made whenever the manufacturer believes the efficiency of the product will be improved, without incurring any obligation to incorporate such improvements in any machines which have been shipped or are in service.

In an effort to continue to improve product quality, ThorWorks reserves the right to change specifications without notice. Any modification or alteration of this machine without prior approval of the manufacturer may void the warranty.

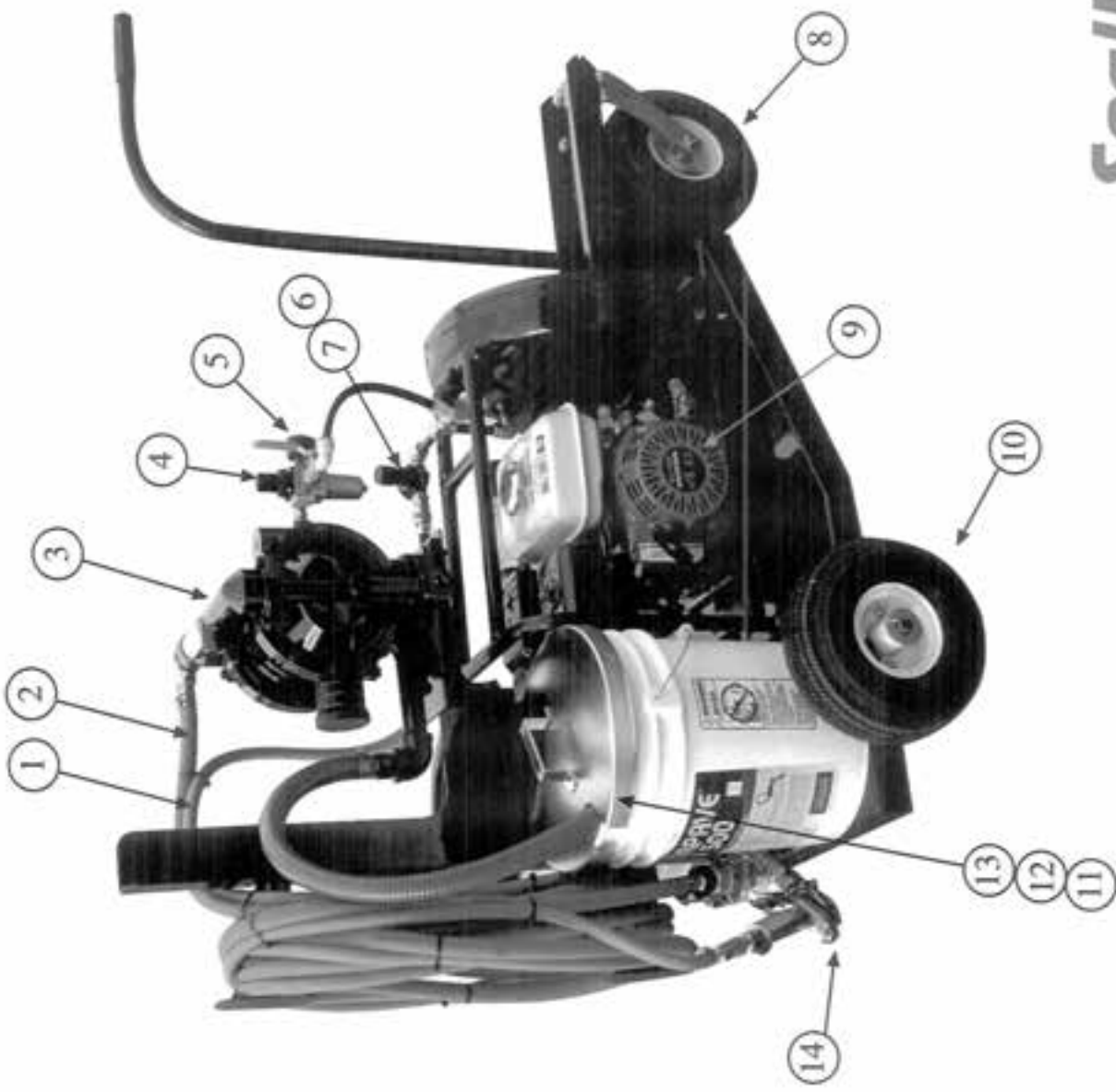

SealMaster[®] Texture Spray Unit

Texture Spray Unit

READ ALL MANUALS THAT COME WITH THIS MACHINE

CHECK THE ENGINE AND COMPRESSOR OILS DAILY

REFER TO OWNERS MANUALS FOR OIL TYPE

1. Open bucket and completely mix in liquid tint. Place on cart and insert suction hose assembly 11, put metal lid on bucket 13.
2. Start compressor engine 9 and wait for compressor to fill air receiver tank.
3. Pressure regulator 6 should be set for 80 psi. Turn knob clockwise to increase pressure, counter-clockwise to decrease.
4. Pressure regulator 4 should be set for 40 psi, lower the valve handle located next to the regulator, this will allow the pump to start.
5. Uncoil as much hose 1 and 2 as you want to use, place the applicator gun 14 about 18-30 inches from the surface and pull the trigger, spraying just enough product to coat. Overlap by half. Follow with a soft bristle broom to work it evenly into the asphalt.
6. On the end of the applicator gun 14 is an air adjustment valve which is used to fine tune the intensity of the spray. Use this control to achieve a uniform round spray pattern. Behind the trigger is an adjustment wheel, this controls the flow rate of the product. Adjustment can only be achieved with the trigger released.
7. Use the 8-12mm tip. Always keep a small amount of air flowing thru the gun. This prevents material from backing up the needle.
8. Flush the system completely with water when finished. Remove the suction hose assembly 11 from the bucket. Engage the trigger lock on the applicator gun 14 so it can not be actuated. Remove the gun's nozzle and hold gun over product bucket. Release the trigger lock and spray material into bucket, stopping when it is obvious air is starting to come out. Place the suction hose assembly into a bucket of water and continue pumping until the water stream is clear.
9. For long life of the applicator gun 14, dismantle gun, completely clean and lightly oil the needle assembly.

Texture Spray Unit Parts List

<u>Ref.#</u>	<u>Description</u>	<u>Part #</u>	<u>Qty</u>
1	3/8" air hose	P717A000	25 ft.
2	5/8" material hose	P712A000	25 ft.
3	1" material pump	P640A060	1
4	air pressure regulator	P735A046	1
5	air pressure gauge	P735A048	1
6	air pressure regulator	P735A023	1
7	air pressure gauge	P735A026	1
8	swivel wheel	P579A004	1
9	air compressor	P458A051	1
10	wheel	P514A005	2
11	suction hose assembly	P71000C001	1
12	strainer	P159A477	1
13	bucket cover	P159A151	1
14	applicator gun	P159A465	1