

# Crack Pro Turbo

OWNERS MANUAL



**SealMaster®**



**Pavement Products & Equipment**

PO Box 2277 • Sandusky, Ohio 44870 • 419-626-4375

[sealmaster.net](http://sealmaster.net)

# CRACK PRO TURBO

## Owner's Manual

Version 2.4

Issue Date: November 2022

Effective Date: April 2019

Version	Date	Changes	Approval
1.0		Original Issue	
2.0	4/19	New Format and Updates	DS
2.1	2/20	Descriptions for 7 & 12,13	JG
2.2	1/22	Change Engine Oil - Note	JG
2.3	4/22	Added Paint Page	JG
2.4	11/22	Added P81000B002	JG

# Table of Contents

CORRESPONDENCE .....	2
SealMaster® LIMITED WARRANTY .....	3
SAFETY PRECAUTIONS AND CAUTIONS .....	4
PRECAUTIONS .....	4
CAUTIONS .....	4
STARTUP.....	5
1-STARTING THE ENGINE .....	5
2-REGULATOR .....	6
3-TORCH HEAD.....	7
MACHINE OPERATION .....	8
4-TORCH WAND .....	8
PARTS LIST.....	9
PICTURE 1.....	10
MACHINE MAINTENANCE .....	11
MAINTENANCE SCHEDULE.....	11
TROUBLESHOOTING GUIDE .....	12
MAINTENANCE AND STORAGE .....	13
MAINTENANCE.....	13
STORAGE .....	13

# ThorWorks Industries, Inc.

Purchased by \_\_\_\_\_ Model NO. \_\_\_\_\_  
Company Name \_\_\_\_\_ Serial NO. \_\_\_\_\_  
Address \_\_\_\_\_ Acceptance Date \_\_\_\_\_  
City \_\_\_\_\_ State \_\_\_\_\_ Zip \_\_\_\_\_

## CORRESPONDENCE

All Correspondence regarding this equipment, as well as general correspondence should be addressed to:

ThorWorks Industries, Inc.

PO Box 2277

Sandusky, OH 44870

In referring to the equipment, kindly state the Model Number, Serial Number and any part number involved



## SealMaster® LIMITED WARRANTY

SealMaster warrants that its products are of quality material and workmanship. SealMaster agrees to replace, within a period of one (1) year from date of delivery, or at its option, repair, without charge, any part of their manufacture which proved defective. The repair or replacement will be free of charge F.O.B. Sandusky, Ohio, providing the damaged part or parts are returned, freight prepaid, to SealMaster and investigation shows such repair or replacement is made necessary by an inherent defect of material or workmanship.

It is hereby understood that engines, motors, pumps, or other components purchased by SealMaster for use on its equipment are not warranted by SealMaster and are sold only with the standard warranty of the manufacturer of that component.

SealMaster will make no allowances for repairs or alterations completed by outside sources unless authorization is in writing and approved by an authorized SealMaster representative.

Any claims for defective material or workmanship must be made prior to the expiration of thirty (30) days from the date failure occurs, and in all cases prior to the expiration of the warranty period of one (1) year. It is the intent of this paragraph to limit SealMaster's liability solely to the cost of replacement parts, F.O.B. factory, or at the option of SealMaster to repair of the defective part or parts. No allowances for damages, lost time, or any other claim will be recognized.

This warranty is null and void if other than genuine SealMaster parts are used.

SealMaster is constantly striving to improve their products. Changes in design and improvement will be made whenever the manufacturer believes the efficiency of the product will be improved, without incurring any obligation to incorporate such improvements in any machines which have been shipped or are in service.

In an effort to continue to improve product quality, SealMaster reserves the right to change specifications without notice.

Any modification or alteration of this machine without prior approval of the manufacturer may void this warranty.

## SAFETY PRECAUTIONS AND CAUTIONS

### PRECAUTIONS

- You are operating a machine that combines propane with compressed air.
- **Always** wear **eye** and **ear** protection, and **gloves**.



- Be aware of all **CAUTION, WARNING, and DANGER** signs on the unit.
- All employees should be trained in **Emergency Burn First Aid**.
- Read all Owners Manuals that come with this unit.
- Make sure the operator is familiar with units' operation.
- Know the procedures for safe operation of propane-fired devices.
- Replace any hoses that show signs of wear, fraying or splitting.
- Be sure all fittings and joints are tight and leak proof.
- Do not operate this unit in the rain or enclosed building or confined area.
- Do not do maintenance work on the machine while in operation.
- The machine should not be left unattended when running.

### CAUTIONS

- Never refuel engine while the burner is lit.
- Keep hands, feet, and clothing away from moving parts.
- Do not operate the machine without all guards in place.
- Do not point the torch head at another person.

# CRACK PRO® TURBO OPERATING INSTRUCTIONS

## STARTUP



### 1-STARTING THE ENGINE

- Set the **fuel** shutoff and **choke** levers to the **on** position.
- Set the engine **on/off** switch to **on** position.
- Pull start the **engine**.
- The engine operates at a fixed RPM, let it run for five minutes before opening Propane Tank.

# CRACK PRO® TURBO OPERATING INSTRUCTIONS

## STARTUP



### 2-REGULATOR

- Regulator #4 should be 6 to 6-1/2 turns open from completely closed for best lighting. During very hot humid conditions, 6 turns maybe too much, 3-4 turns may be better.
- **Slightly** turn the Regulator knob #4 in or out to fine tune the mixture. After adjustment, wait several seconds for the mixture to blend for Ignition.

### PARTS LIST

ITEM #	PART#	QTY.	DESCRIPTION
2	P81000B001	1	TORCH WAND <b>ASSEMBLY</b>
3	P678A011	1	BATTERY IGNITION DEVICE
4	P735A052	1	LP REGULATOR
12	P667A005	2	MALE CONNECTOR - LP HOSE FITTING
14	P933A001	1	LP TANK CONNECTOR



# CRACK PRO® TURBO OPERATING INSTRUCTIONS

## STARTUP

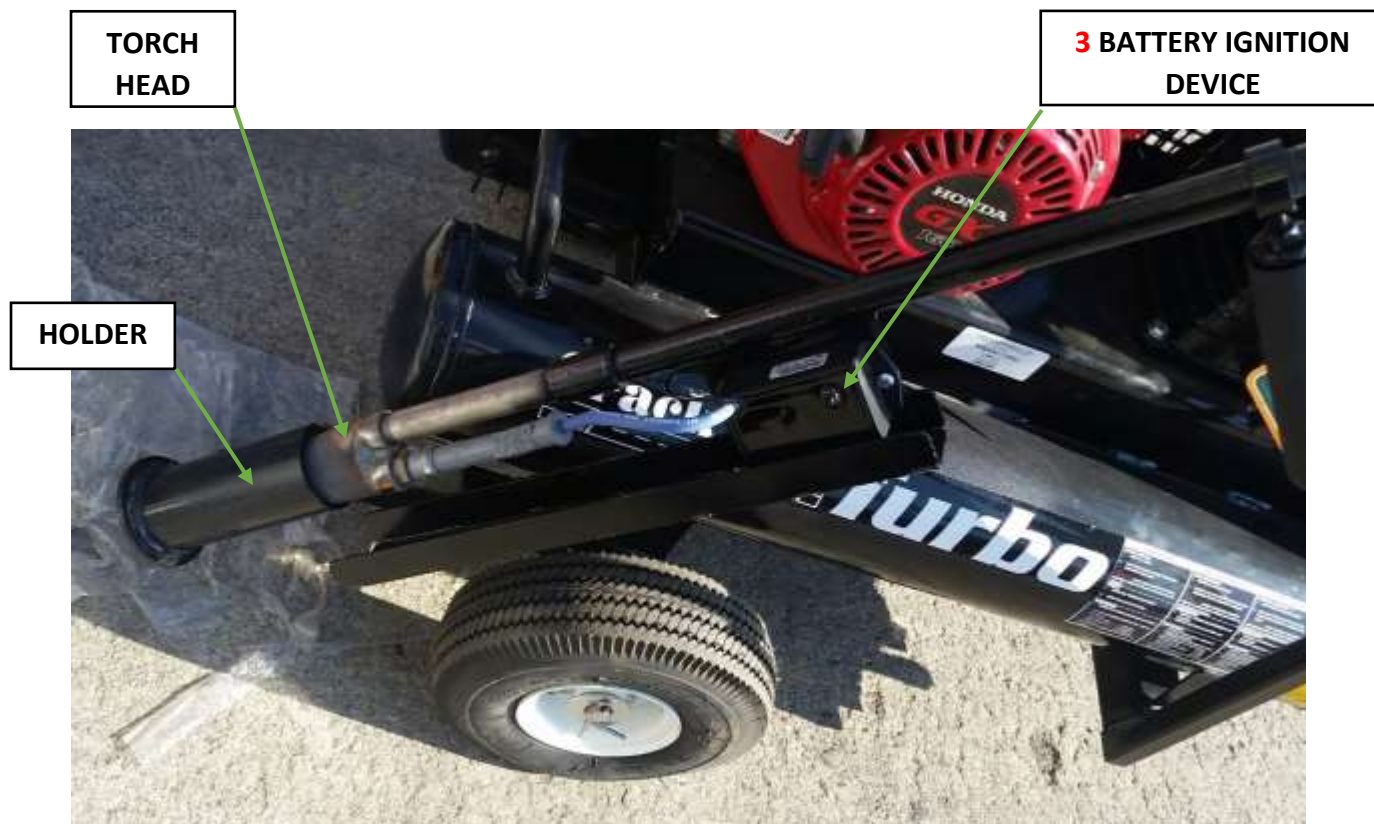

### 3-TORCH HEAD

- Remove the Torch Head from its holder.
- Open the Propane Tank valve. It takes anywhere from 30 seconds or more for propane and air mix in the torch head chamber.
- Depress the Battery Ignition Device #3 and keep it pressed until you hear the torch ignite.



- When finished, **DO NOT TOUCH THE REGULATOR**, turn off the Propane Tank valve. Let the compressor continue to run for a couple of minutes to cool down the Torch Head.

# CRACK PRO® TURBO OPERATING INSTRUCTIONS

## MACHINE OPERATION



**2 TORCH WAND  
ASSEMBLY**

### 4-TORCH WAND

- Once Lit, cradle the Torch Wand Assembly #2 in your arm and follow the cracks, **WARNING** moving too slowly can result in burning the asphalt.
- You can also put it in the angled holder and push the cart.

# CRACK PRO® TURBO OPERATING INSTRUCTIONS

## MACHINE OPERATION

### PARTS LIST – PICTURE 1

ITEM #	PART#	QTY.	DESCRIPTION
1	P458A045	1	4.8 HP ENGINE WITH COMPRESSOR
2	P81000B001	1	TORCH WAND <b>ASSEMBLY</b>
3	P678A011	1	BATTERY IGNITION DEVICE
4	P735A052	1	LP REGULATOR
5	P669A007	1	LP HOSE 25 FEET
6	P933A003	1	FEMALE QUICK CONNECT
7	P81000B002	1	TORCH HEAD <b>ASSEMBLY</b>
8	P579A001	1	SWIVEL TIRE
9	P514A005	2	TIRE <b>ASSEMBLY</b>
10	P409A013	1	IGNITOR SPARK PLUG
11	P933A004	1	MALE QUICK CONNECT
12	P667A005	2	MALE CONNECTOR - LP HOSE FITTING
13	P669B007	1	LP HOSE 3 FEET ASSEMBLY
14	P933A001	1	LP TANK CONNECTOR
15	P81000B003	1	ORIFICE NIPPLE
16	P81000B017	1	ARM SUPPORT
17	P81000B023	1	HANDLE GRIP

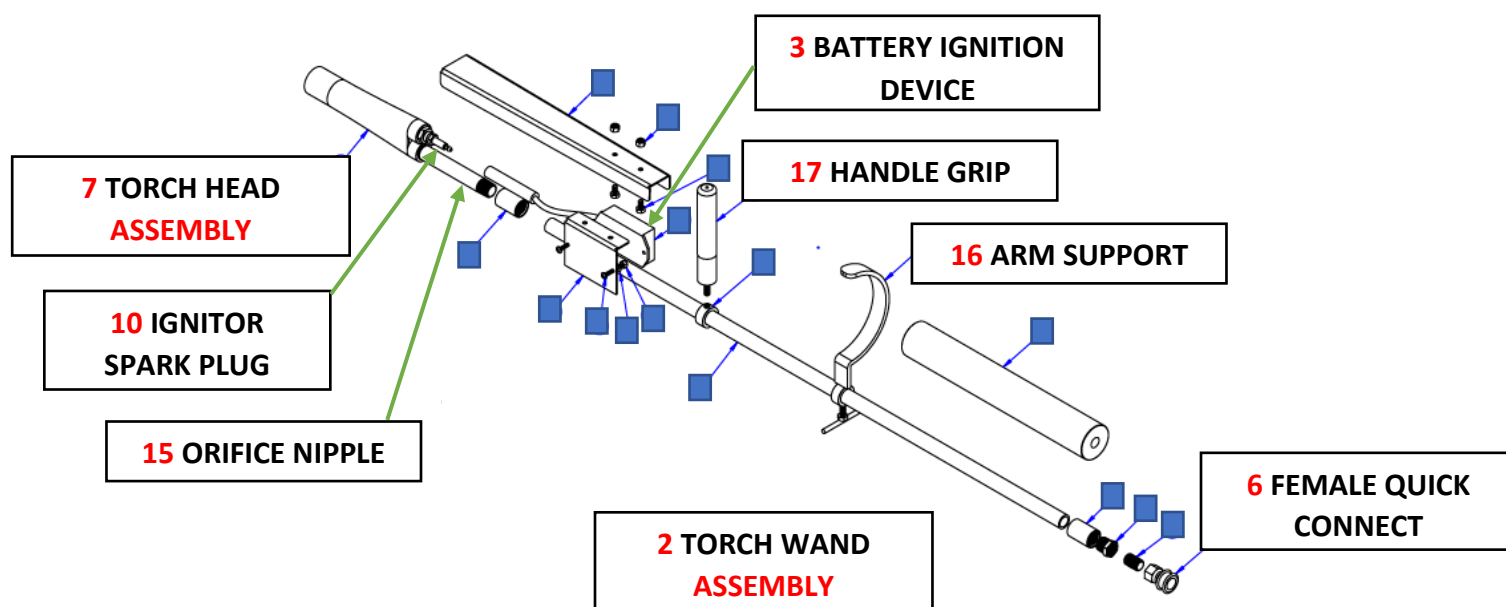

# CRACK PRO® TURBO OPERATING INSTRUCTIONS

## MACHINE OPERATION

PICTURE 1

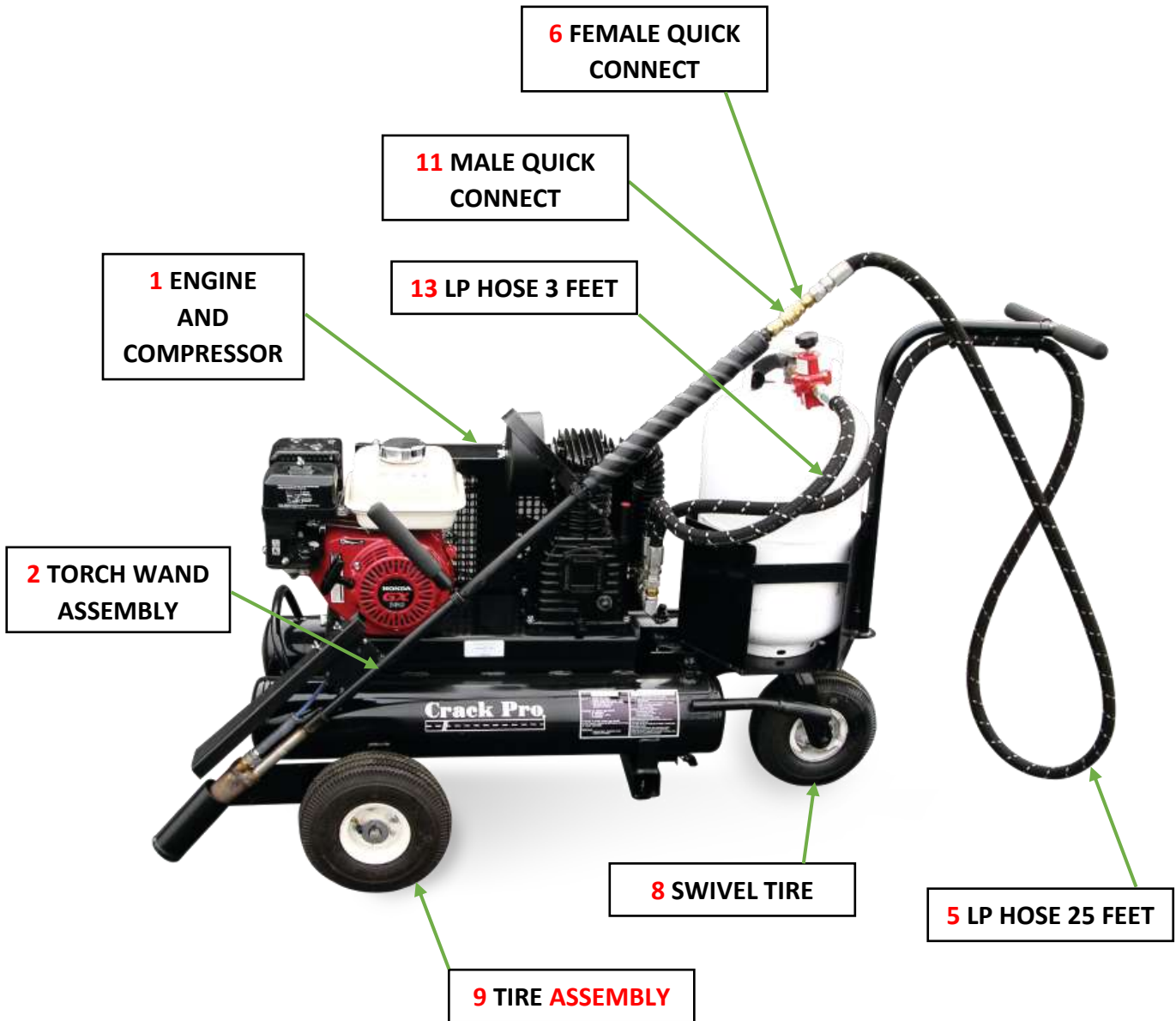

# CRACK PRO® TURBO OPERATING INSTRUCTIONS

## MACHINE MAINTENANCE

### MAINTENANCE SCHEDULE

Follow maintenance procedures listed in the engine and compressor manuals.

MAINTAIN	8 HRS	1 WEEK	1 MONTH	6 MONTHS	1 YEAR
CHECK ENGINE OIL LEVEL	✓				
CHANGE ENGINE OIL *					
CHECK COMPRESSOR OIL LEVELS	✓				
CHANGE COMPRESSOR OIL			✓		
INSPECT COMPRESSOR AIR FILTER	✓				
CHANGE COMPRESSOR AIR FILTER			✓		
TIGHTEN V-BELT		✓			
REPLACE V-BELT					✓
INSPECT ALL HOSES	✓				

\*CHANGE ENGINE OIL - OIL SPECIFICATIONS / REFER TO ENGINE MANUAL

Honda Recommends **20hrs Initial Start** / every 100hrs or 6 mons. After

# CRACK PRO® TURBO OPERATING INSTRUCTIONS

## MACHINE MAINTENANCE

### TROUBLESHOOTING GUIDE

PROBLEM	POSSIBLE CAUSES/SOLUTIONS
<b>AIR COMPRESSOR</b> NOT PRODUCING ENOUGH AIR OR PRESSURE	<b>BELT LOOSE / TIGHTEN THE BELT</b>
<b>ENGINE</b>	<b>OIL SPECIFICATIONS / REFER TO OWNER'S MANUAL</b>
	<b>OPERATING INSTRUCTIONS / REFER TO OWNER'S MANUAL</b>
	<b>FUEL IN OIL CRANKCASE / FUEL SHUT-OFF VALVE IN OFF POSITION WHEN FINISHED</b>
<b>TORCH</b> WILL NOT LIGHT	<b>SPARK PLUG IS DIRTY / CLEAN OR GAP AND REPLACE*</b>
	<b>IGNITOR CHARGE LOW / REPLACE IGNITOR</b>
	<b>TORCH ORIFICE PLUGGED/ UNPLUG</b>
	<b>REGULATOR SETTING INCORRECT / RE-SET TO 6 TURNS OPEN</b>
	<b>COLD START VALVE OPEN / CLOSE VALVE*</b>



SPARK PLUG GAP 1/8 INCH\*

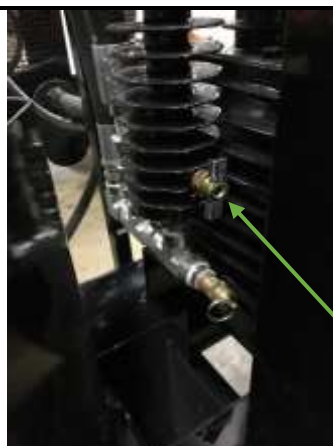

COLD START VALVE\*

## MAINTENANCE AND STORAGE

### MAINTENANCE

During the lubrication stop, inspect all operating parts. Should any damage or excessive wear be evident, replace parts immediately. Straighten any parts as soon as possible. Clean and re-paint all exposed parts using touch-up kit P3020B034 **yellow** paint or touch-up kit P3020B033 **black** paint.

### STORAGE

Perform all required maintenance and lubrication procedures. Coat all shafts with grease. Clean and re-paint all exposed parts using touch-up kit P3020B034 **yellow** paint or touch-up kit P3020B033 **black** paint.

### Each touch-up kit includes:

1-pint paint can --- 1 pair of gloves --- 1 touch-up paintbrush

