

# Hand Agitated Mixing Tanks

SK300, SK575 & TR300

OWNERS MANUAL



**SealMaster**<sup>®</sup>  
  
Pavement Products & Equipment

PO Box 2277 • Sandusky, Ohio 44870 • 419-626-4375

[sealmaster.net](http://sealmaster.net)

# HAND AGITATED MIXING TANK

## Owner's Manual

Version 2.4

Issue Date: October 2022

Effective Date: April 2019

Version	Date	Changes	Approval
1.0		Original Issue	
2.0	6/19	New Format and Updates	DS
2.1	1/22	Change Engine Oil – Note	JG
2.2	4/22	Added Paint Page	JG
2.3	5/22	Breakaway Kit Change	JG
2.4	10/22	Added Site Gauge & Ramp	JG
	10/22	P474A095 Added	JG

## Table of Contents

<b>CORRESPONDENCE .....</b>	<b>2</b>
<b>SealMaster® LIMITED WARRANTY .....</b>	<b>3</b>
<b>SAFETY PRECAUTIONS AND CAUTIONS .....</b>	<b>4</b>
PRECAUTIONS .....	4
CAUTIONS .....	4
<b>MANUAL COVERAGE.....</b>	<b>5</b>
HAND AGITATED MIXING TANK SKID AND TRAILER MOUNTED .....	5
<b>OPERATING INSTRUCTIONS .....</b>	<b>6</b>
CHECKLIST .....	6
BEFORE STARTING THE ENGINE.....	6
STARTING THE ENGINE .....	7
ADDING MATERIAL .....	8
POURING MATERIAL .....	8
<b>MACHINE MAINTENANCE .....</b>	<b>9</b>
MAINTENANCE SCHEDULE.....	9
TROUBLE SHOOTING.....	10
<b>WIRING DIAGRAMS .....</b>	<b>11</b>
ELECTRIC BRAKES AND RUNNING LIGHTS.....	11
<b>TANK CAPACITY CHART .....</b>	<b>12</b>
MATERIAL DEPTH AND GALLON VOLUME .....	12
<b>MACHINE PICTURES AND PARTS LIST .....</b>	<b>13</b>
PARTS LIST PICTURE-1 .....	14
PARTS LIST PICTURE-2 .....	15
PARTS LIST PICTURE-3 .....	17
PARTS LIST PICTURE-4.....	19
PARTS LIST PICTURE-5.....	20
<b>MAINTENANCE AND STORAGE.....</b>	<b>21</b>
MAINTENANCE.....	21
STORAGE .....	21

# ThorWorks Industries, Inc.

Purchased by \_\_\_\_\_ Model NO. \_\_\_\_\_  
Company Name \_\_\_\_\_ Serial NO. \_\_\_\_\_  
Address \_\_\_\_\_ Acceptance Date \_\_\_\_\_  
City \_\_\_\_\_ State \_\_\_\_\_ Zip \_\_\_\_\_

## CORRESPONDENCE

All Correspondence regarding this equipment, as well as general correspondence should be addressed to:

ThorWorks Industries, Inc.

PO Box 2277

Sandusky, OH 44870

In referring to the equipment, kindly state the Model Number, Serial Number and any part number involved



## SealMaster® LIMITED WARRANTY

SealMaster warrants that its products are of quality material and workmanship. SealMaster agrees to replace, within a period of one (1) year from date of delivery, or at its option, repair, without charge, any part of their manufacture which proved defective. The repair or replacement will be free of charge F.O.B. Sandusky, Ohio, providing the damaged part or parts are returned, freight prepaid, to SealMaster and investigation shows such repair or replacement is made necessary by an inherent defect of material or workmanship.

It is hereby understood that engines, motors, pumps, or other components purchased by SealMaster for use on its equipment are not warranted by SealMaster and are sold only with the standard warranty of the manufacturer of that component.

SealMaster will make no allowances for repairs or alterations completed by outside sources unless authorization is in writing and approved by an authorized SealMaster representative.

Any claims for defective material or workmanship must be made prior to the expiration of thirty (30) days from the date failure occurs, and in all cases prior to the expiration of the warranty period of one (1) year. It is the intent of this paragraph to limit SealMaster's liability solely to the cost of replacement parts, F.O.B. factory, or at the option of SealMaster to repair of the defective part or parts. No allowances for damages, lost time, or any other claim will be recognized.

This warranty is null and void if other than genuine SealMaster parts are used.

SealMaster is constantly striving to improve their products. Changes in design and improvement will be made whenever the manufacturer believes the efficiency of the product will be improved, without incurring any obligation to incorporate such improvements in any machines which have been shipped or are in service.

In an effort to continue to improve product quality, SealMaster reserves the right to change specifications without notice.

Any modification or alteration of this machine without prior approval of the manufacturer may void this warranty.

## SAFETY PRECAUTIONS AND CAUTIONS

### PRECAUTIONS

- **Always** wear **eye** and **ear** protection, and **gloves**.



- Be aware of all **CAUTION, WARNING, DANGER** signs on the unit.
- Read all Owners Manuals that come with this unit.
- Make sure the operator is familiar with the units' operation.

### CAUTIONS

- Keep hands, feet, and clothing away from moving parts.
- Do not operate the machine without all guards in place.
- Stop the Agitator when opening the lid for any reason.

# **HAND AGITATED MIXING TANK**

**APPLIES TO ALL SK300, SK575 & TR300**

## **MANUAL COVERAGE**

### **HAND AGITATED MIXING TANK SKID AND TRAILER MOUNTED**

This manual cover model sizes 300 and 575 gallon tanks.

SealMaster® Hand-Agitated Sealcoat Mixing Tanks set the industry standard for skid mount and trailer mount hand-agitated sealcoat mix tanks.

SealMaster Hand-Agitated Sealcoating Mixing tanks are available in several sizes and configurations. SealMaster Hand-Agitated Mixing Tank can be carried in the back of a truck (skid mounted) or towed behind (trailer mounted).

Ideal for gravity flow sealcoat applications or a pump can be attached for spray applications. SealMaster sealcoating equipment has set the sealcoating equipment industry standards for quality, performance and durability for over 40 years.

# HAND AGITATED MIXING TANK

**APPLIES TO ALL SK300, SK575 & TR300**

**WITH OPTIONAL HYDRAULIC AGITATION**

## OPERATING INSTRUCTIONS

### STARTUP

#### CHECKLIST

- Check engine oil level. Follow manufacturer's guidelines as to type and frequency of changes.
- Check hydraulic oil level. Use grade AW68 hydraulic oil.
- Fill fuel tank with gasoline for engine.

#### BEFORE STARTING THE ENGINE

Make sure the agitator control valve #6 is in the neutral position.

**6** AGITATOR  
CONTROL VALVE





# HAND AGITATED MIXING TANK

APPLIES TO ALL SK300, SK575 & TR300

WITH OPTIONAL HYDRAULIC AGITATION

## OPERATING INSTRUCTIONS

### STARTUP

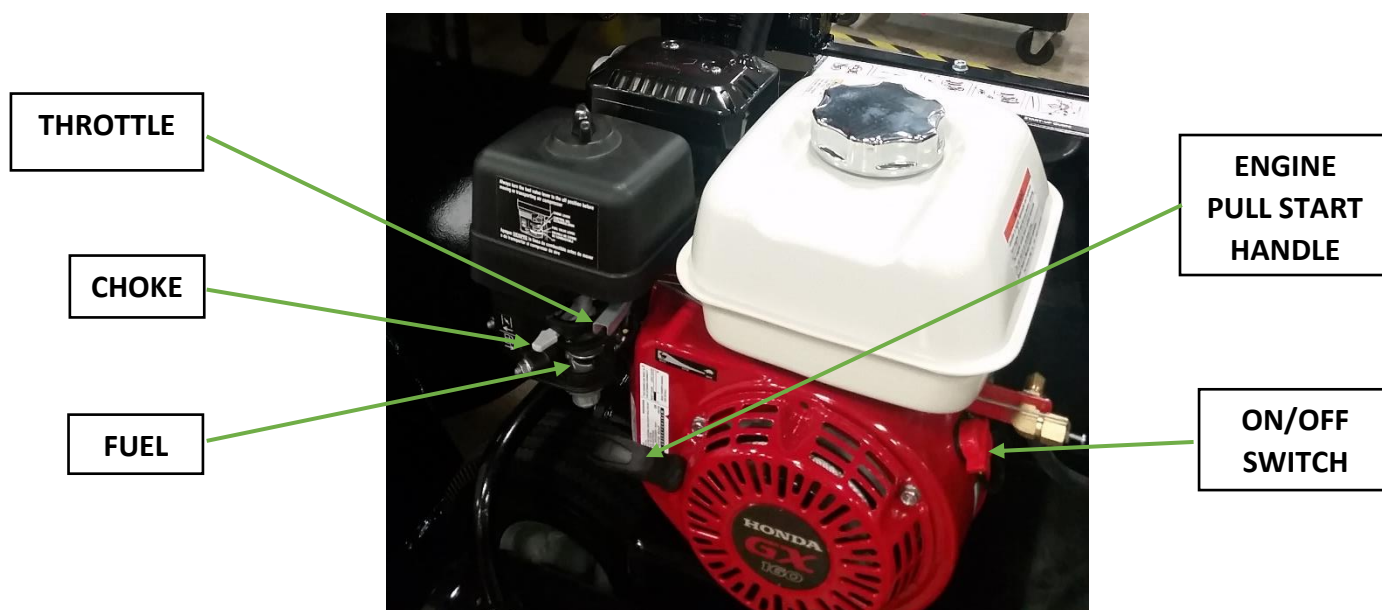

### STARTING THE ENGINE

- Set the **fuel** shutoff and **choke** levers to the **on** position.
- Set the throttle lever at ½ open.
- Set the engine **on/off** switch to **on** position.
- Pull start the **engine**.



- It is important that when you are done running the engine that the **fuel** shutoff lever is turned to the **off** position. This keeps gasoline from mixing with oil as you are driving.

Refer to the engine manual.

# OPERATING INSTRUCTIONS

**APPLIES TO ALL SK300, SK575 & TR300**

**WITH OR WITHOUT OPTIONAL HYDRAULIC AGITATION**

## ADDING MATERIAL

1. Open the material tank lid and add pavement sealer with or without sand. Close the lid.
2. Turn the hand crank lever #25, or engage the hydraulic agitator, until the sealer is mixed thoroughly.
3. Mix periodically during the day, to keep material consistent.

## POURING MATERIAL

4. Open valve #21 to pour out sealer.
5. Apply Sealer with a squeegee or brush.

**21 VALVE 2"**



**25 HAND  
CRANK**

# HAND AGITATED MIXING TANK

**APPLIES TO ALL SK300, SK575 & TR300**

## MACHINE MAINTENANCE

### MAINTENANCE SCHEDULE

Follow maintenance procedures listed on the **engine** manual.

Maintenance Schedule on **OPTIONAL** Hydraulic Agitation when applied.

MAINTAIN	8 HRS	1 WEEK	1 MONTH	6 MONTHS	1 YEAR	2 YEARS
CHECK <b>ENGINE OIL</b> LEVELS	✓					
CHECK <b>HYDRAULIC OIL</b> LEVELS	✓					
CHANGE <b>ENGINE OIL</b> *						
CHANGE <b>HYDRAULIC OIL</b> *						✓
CHANGE <b>HYDRAULIC OIL FILTER</b>					✓	
CLEAN <b>HYDRAULIC SUCTION STRAINER</b>					✓	
CHECK <b>BREAKAWAY BOX BATTERY</b>	✓					
CHECK <b>TIRE PRESSURE</b>			✓			
INSPECT ALL <b>HOSES</b>	✓					

\* Use a good quality AW68 hydraulic oil with a rating of 352 SUS @100 F. Do not use a 150 rated hydraulic oil as it is too light.

\*CHANGE **ENGINE OIL** - OIL SPECIFICATIONS / REFER TO ENGINE MANUAL

Honda Recommends **20hrs Initial Start** / every 100hrs or 6 mons. After

# HAND AGITATED MIXING TANK

**APPLIES TO ALL SK300, SK575 & TR300**

## MACHINE MAINTENANCE

### TROUBLE SHOOTING

PROBLEM	POSSIBLE CAUSES/SOLUTIONS
ENGINE ISSUES	OIL SPECIFICATIONS / REFER TO OWNER'S MANUAL
	OPERATING INSTRUCTIONS / REFER TO OWNER'S MANUAL
	FUEL IN OIL CRANKCASE / FUEL SHUT-OFF VALVE IN OFF POSITION WHEN FINISHED
CHAINS NOT CONTACTING SPROCKETS PROPERLY	CHAIN TENSION IMPROPERLY ADJUSTED / ADJUST CHAIN TIGHTENER
	SPROCKET TEETH BROKEN / REPLACE SPROCKET
OPTIONAL HYDRAULIC AGITATION DOES NOT ROTATE	SHUTOFF VALVE IS CLOSED / OPEN VALVE
	HYDRAULIC OIL LOW / FILL OIL LEVEL 4" FROM TOP OF TANK
	HYDRAULIC AGITATOR MOTOR NOT WORKING / REPLACE AGITATOR MOTOR
	COUPLER KEY / REPLACE THE SHEARED KEY
	CHAIN BROKEN / REPLACE THE CHAIN
	HYDRAULIC PUMP NOT WORKING / HAVE TESTED OR REPLACED

# WIRING DIAGRAMS

## ELECTRIC BRAKES AND RUNNING LIGHTS

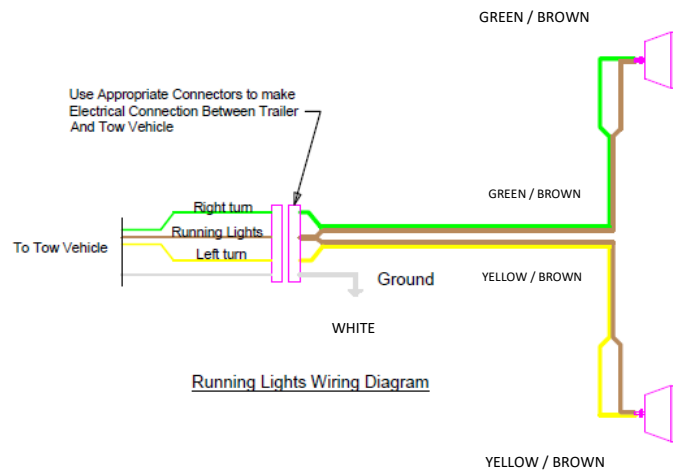
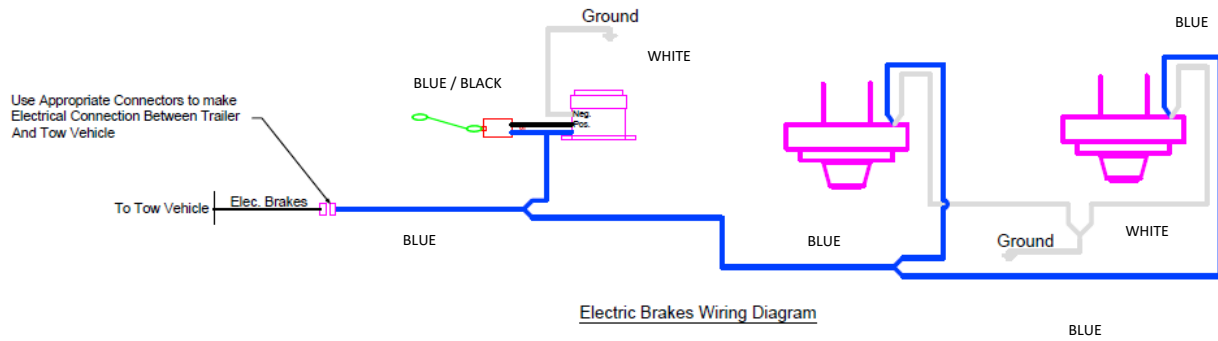

<b>TANK CAPACITY CHART</b>					
GALLONS ARE APPROXIMATE AND MAY VARY SLIGHTLY TANK TO TANK					
<b>MATERIAL DEPTH AND GALLON VOLUME</b>					
MATERIAL DEPTH	300 GALLONS 41"x54"	575 GALLONS 48"x74"	MATERIAL DEPTH	300 GALLONS 41"x54"	575 GALLONS 48"x74"
INCHES	GALLONS	GALLONS	INCHES	GALLONS	GALLONS
1	2	3	25	197	305
2	6	8	26	206	321
3	10	15	27	216	336
4	15	23	28	225	351
5	21	32	29	233	366
6	28	42	30	242	381
7	35	52	31	250	396
8	42	64	32	258	411
9	50	75	33	266	425
10	58	87	34	274	439
11	67	100	35	281	453
12	75	113	36	287	466
13	84	127	37	293	479
14	93	141	38	298	492
15	102	155	39	303	504
16	112	169	40	307	516
17	121	184	41	309	527
18	130	199	42		538
19	140	214	43		548
20	150	229	44		557
21	159	244	45		565
22	169	259	46		571
23	178	274	47		577
24	188	290	48		580

# HAND AGITATED MIXING TANK

## MODEL TR300

### MACHINE PICTURES AND PARTS LIST

PICTURE-1

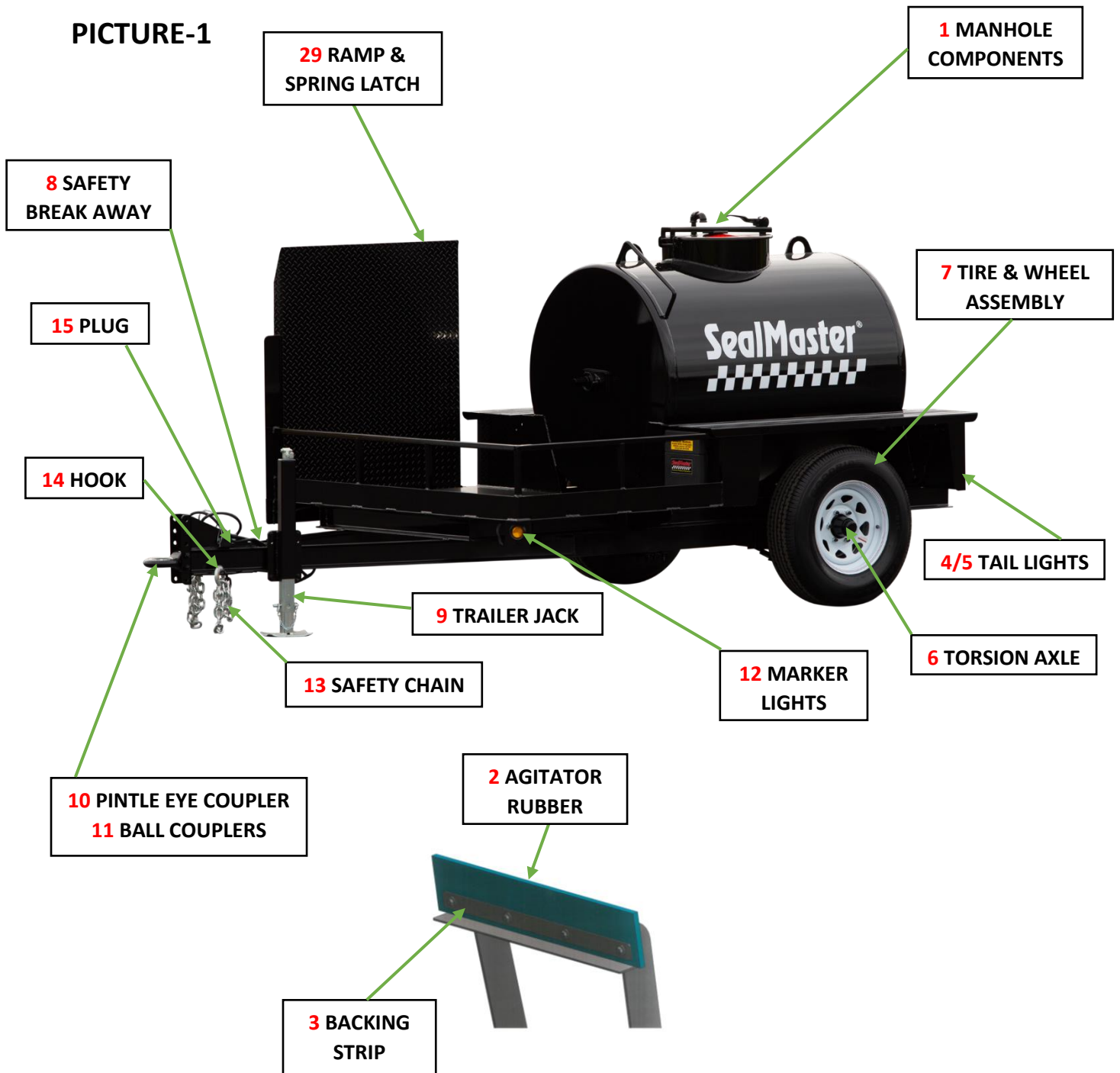

# HAND AGITATED MIXING TANK

**APPLIES TO ALL SK300, SK575 & TR300**

## PARTS LIST

### PARTS LIST PICTURE-1

ITEM #	PART#	QTY.	DESCRIPTION
			<b>MANHOLE COMPONENTS</b>
<b>1</b>	<b>P639B004</b>	<b>1</b>	<b>RETAINING RING WITH SPLASH GUARD</b>
	<b>P639B005</b>	<b>1</b>	<b>LID MANHOLE WITH VENT – DRIP EDGE</b>
	<b>P639A009</b>	<b>1</b>	<b>GASKET-MANHOLE LOW TEMPERATURE</b>
	<b>P639A006</b>	<b>1</b>	<b>LATCH &amp; HARDWARE</b>
<b>2</b>	<b>P459A013</b>	<b>3</b>	<b>SK 575 AGITATOR RUBBER</b>
	<b>P459A013</b>	<b>2</b>	<b>SK 300 AGITATOR RUBBER</b>
<b>3</b>	<b>P72000B012</b>	<b>2/3</b>	<b>BACKING STRIP</b>

### PARTS LIST – TRAILERS ONLY

\* DENOTES YOUR CHOICE

ITEM #	PART#	QTY.	DESCRIPTION
<b>4</b>	<b>P516A025</b>	<b>1</b>	<b>LEFT SIDE TAIL LIGHT</b>
<b>5</b>	<b>P516A024</b>	<b>1</b>	<b>RIGHT SIDE TAIL LIGHT</b>
<b>6</b>	<b>P511A013</b>	<b>1</b>	<b>TORSION AXLE</b>
<b>7</b>	<b>P514A017</b>	<b>2</b>	<b>TIRE AND WHEEL ASSEMBLY</b>
<b>8</b>	<b>P518A008</b>	<b>1</b>	<b>BREAK AWAY KIT – 4BOLT</b>
	<b>P518A004</b>	<b>1</b>	<b>BREAK AWAY KIT BEFORE 10/2019</b>
<b>9</b>	<b>P551A008</b>	<b>1</b>	<b>JACK SCREW ASSEMBLY</b>
<b>10</b>	<b>P646A003</b>	<b>*</b>	<b>PINTLE EYE COUPLER</b>
<b>11</b>	<b>P553A008</b>	<b>*</b>	<b>2-5/16" BALL COUPLER</b>
<b>12</b>	<b>P467A016</b>	<b>2</b>	<b>AMBER MARKER LIGHTS</b>
<b>13</b>	<b>P531A004</b>	<b>2</b>	<b>SAFETY CHAIN</b>
<b>14</b>	<b>P517A002</b>	<b>2</b>	<b>HOOK (PART OF SAFETY CHAIN)</b>
<b>15</b>	<b>P519A007</b>	<b>1</b>	<b>TRAILER PLUG</b>
<b>29</b>	<b>P72000D073</b>	<b>1</b>	<b>RAMP</b>
	<b>P953A008</b>	<b>1</b>	<b>SPRING LATCH</b>



# HAND AGITATED MIXING TANK

**MODEL SK 575**

## MACHINE PICTURES AND PARTS LIST

### PARTS LIST PICTURE-2

ITEM #	PART#	QTY.	DESCRIPTION
16	P432A002	2	FLANGE BEARING 1" BORE
17	P426A001	1	SPROCKET 1" BORE
18	P1038A000	1	#40 CHAIN ROLLER (SOLD PER FOOT)
	P1035A001	1	#40 MASTER LINK
19	P426A011	1	SPROCKET 1-1/2" BORE WITH 1/2" KEY
20	P50000A004	1	HAND CRANK ASSEMBLY (SPROCKET)

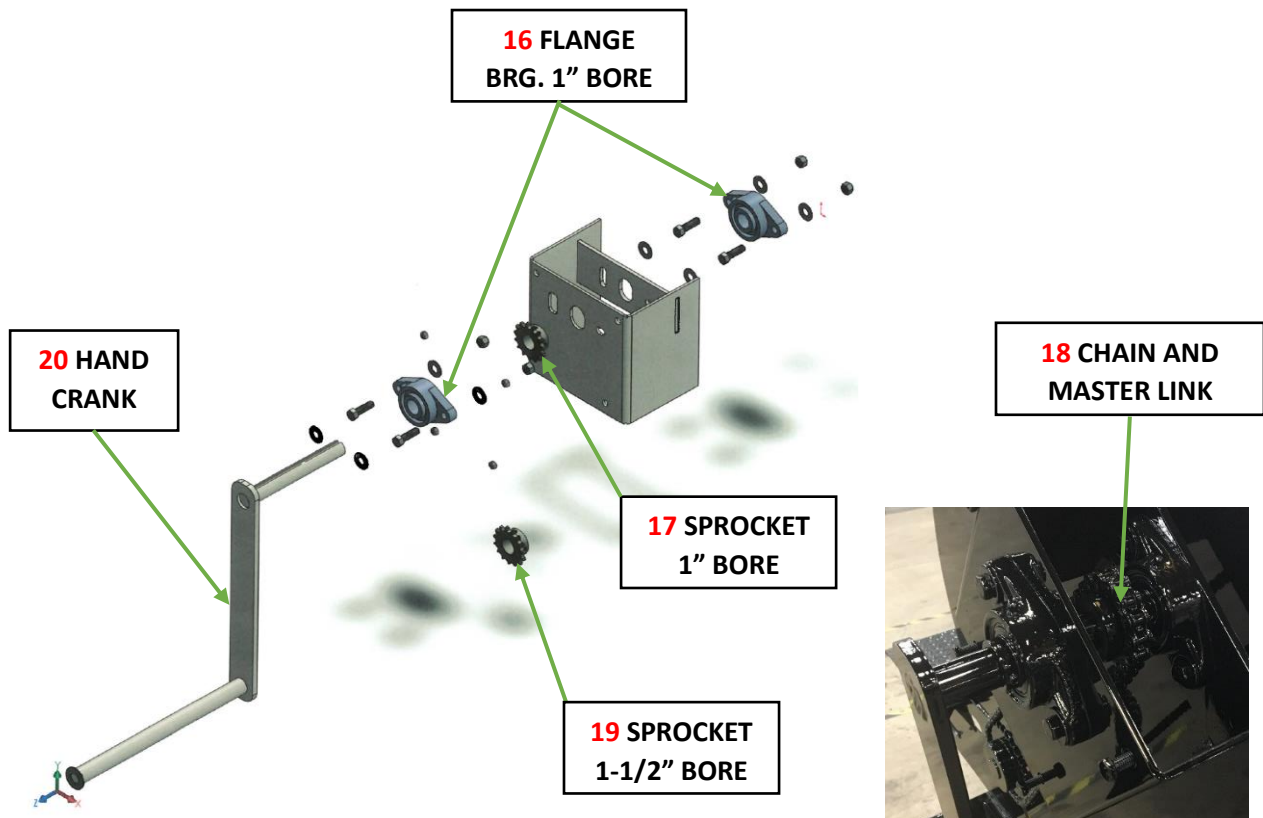

# HAND AGITATED MIXING TANK

**MODEL SK 575**

## PARTS LIST

### PARTS LIST PICTURE-2

ITEM #	PART#	QTY.	DESCRIPTION
21	P397A002	1	2" VALVE
22	P50137B003	1	BEARING PLATE
23	P50137B002	1	BEARING SEAL
24	P434A003	2	4-HOLE FLANGE BEARING 1-1/2" BORE

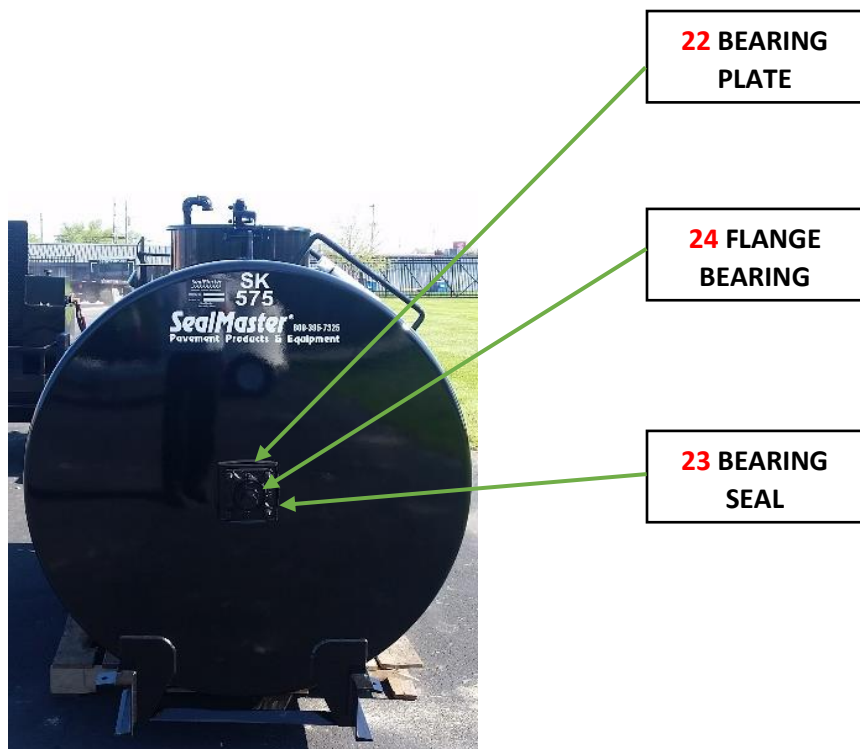

# HAND AGITATED MIXING TANK

**MODEL SK 300 & TR 300**

## MACHINE PICTURES AND PARTS LIST

**PICTURE-3 SHOWN WITH DIRECT HAND CRANK**

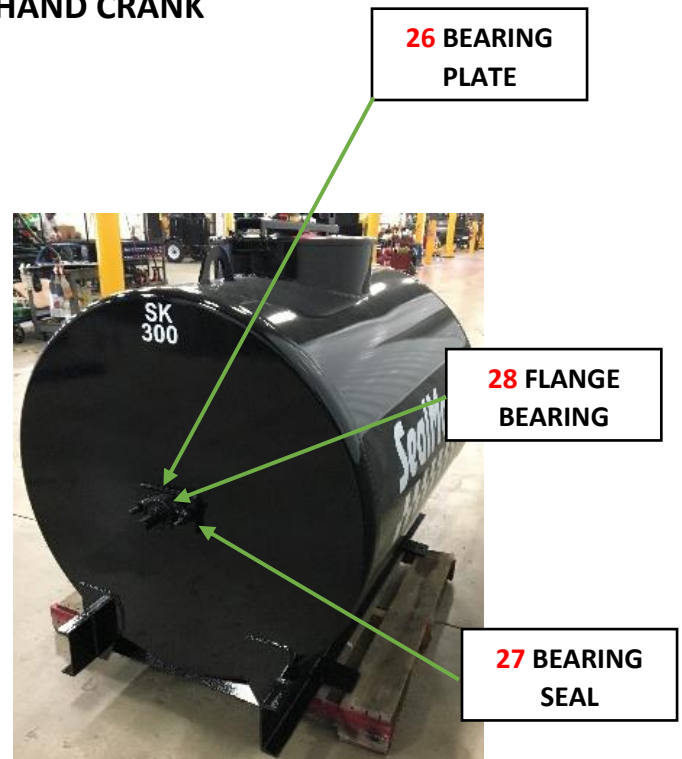

### PARTS LIST PICTURE-3

ITEM #	PART#	QTY.	DESCRIPTION
25	P50000D001	1	HAND CRANK (DIRECT)
26	P50137B008	1	BEARING PLATE
27	P50137B009	1	BEARING SEAL
28	P432A003	2	2-HOLE FLANGE BEARING 1-1/4" BORE

# HAND AGITATED MIXING TANK

APPLIES TO ALL SK300, SK575 & TR300

## MACHINE PICTURES AND PARTS LIST

WITH **OPTIONAL** HYDRAULIC AGITATION

PICTURE-4

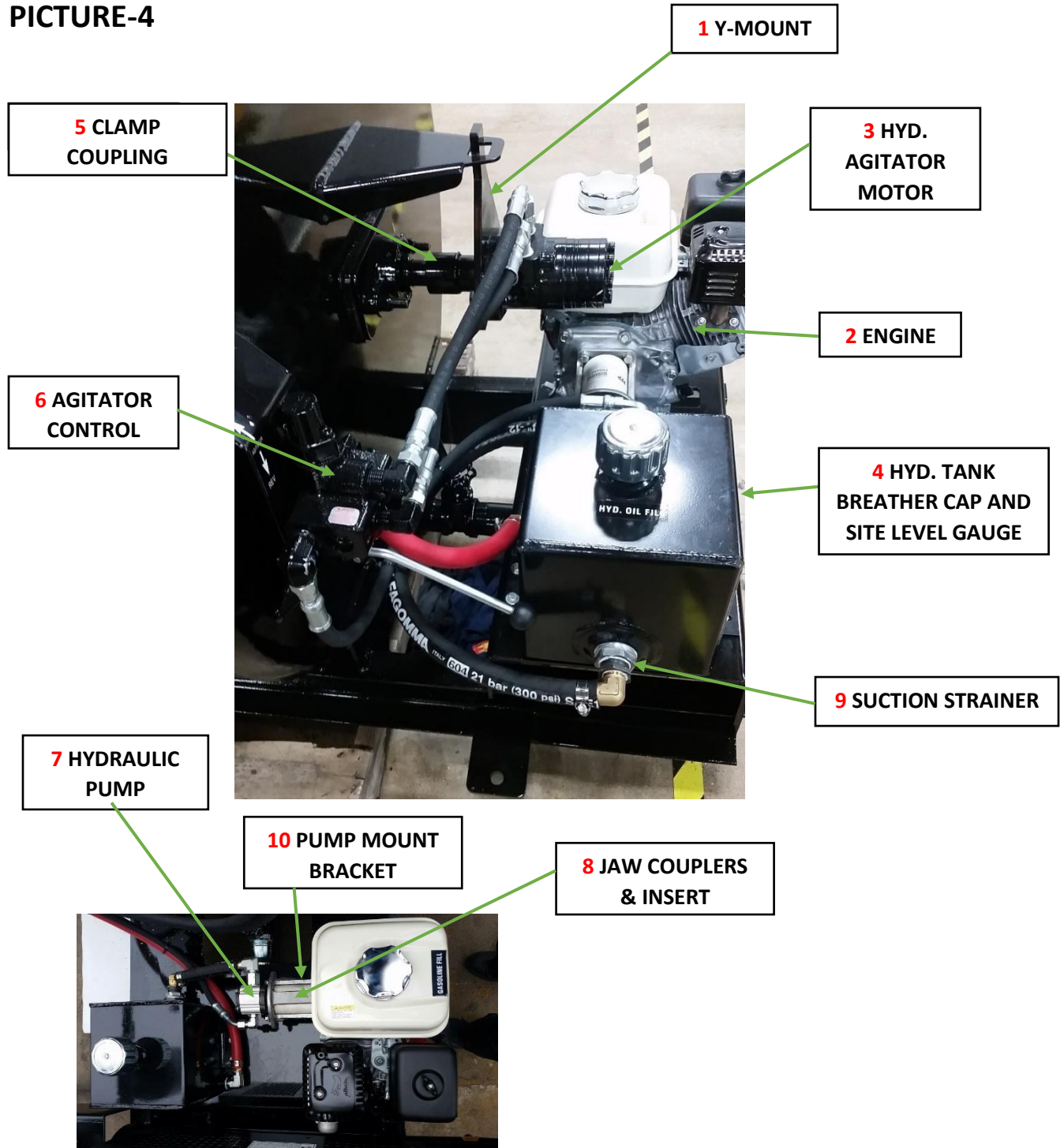

1 Y-MOUNT

5 CLAMP COUPLING

3 HYD. AGITATOR MOTOR

2 ENGINE

6 AGITATOR CONTROL

4 HYD. TANK BREATHER CAP AND SITE LEVEL GAUGE

9 SUCTION STRAINER

7 HYDRAULIC PUMP

10 PUMP MOUNT BRACKET

8 JAW COUPLERS & INSERT

# HAND AGITATED MIXING TANK

**APPLIES TO ALL SK300, SK575 & TR300**

**WITH OPTIONAL HYDRAULIC AGITATION**

## PARTS LIST

### PARTS LIST PICTURE-4

ITEM #	PART#	QTY.	DESCRIPTION
	P50340	1	HYDRAULIC AGITATION ASSEMBLY
1	P72000B027	1	Y-MOUNT
2	P458A022	1	HONDA ENGINE GX160
3	P474A088	1	HYDRAULIC AGITATOR MOTOR <b>SK300</b>
	P474A095	1	HYDRAULIC AGITATOR MOTOR <b>SK575 – TR575</b>
4	P599A003	1	HYDRAULIC OIL TANK
	P599C001	1	BREATHER CAP
	P599C002	1	SITE LEVEL GAUGE
5	P498A008	1	<b>SK 575</b> COUPLING 1-1/2" BORE WITH 1/2" KEY COUPLING 1" BORE WITH 1/4" KEY
	P498A004	1	<b>SK 300</b> COUPLING 1-1/4" BORE WITH 3/8" KEY COUPLING 1" BORE WITH 1/4" KEY
6	P472A016	1	AGITATOR CONTROL VALVE
	P939A025	1	HYD. VALVE – SEAL KIT (Brand M)
7	P601A041	1	HYDRAULIC PUMP
8	P630A035	1	JAW COUPLER 3/4" BORE WITH 3/16" KEY
	P630A045	1	JAW COUPLER 1/2" BORE WITH 1/8" KEY
	P631A005	1	COUPLER INSERT FOR JAW COUPLER
9	P408A004	1	SUCTION STRAINER (HYD. TANK)
10	P604A018	1	PUMP MOUNT BRACKET

### NOTE:

HYDRAULIC AGITATION KIT P50340C – FIELD **OPTION**

**AVAILABLE ON WEB SITE: [sealmaster.net](http://sealmaster.net)**

# HAND AGITATED MIXING TANK

**MODEL SK 300 & TR 300**

## PARTS LIST

WITH **OPTIONAL** GEAR REDUCTION

### PARTS LIST PICTURE-5

ITEM #	PART#	QTY.	DESCRIPTION
1	P462A002	2	FLANGE BEARING 1" BORE
2	P426A001	1	SPROCKET 1" BORE
3	P1038A000	1	#40 CHAIN ROLLER (SOLD PER FOOT)
	P1035A001	1	#40 MASTER LINK
4	P426A014	1	SPROCKET 1-1/4" BORE WITH 3/8" KEY
5	P50000A004	1	HAND CRANK ASSEMBLY (SPROCKET)

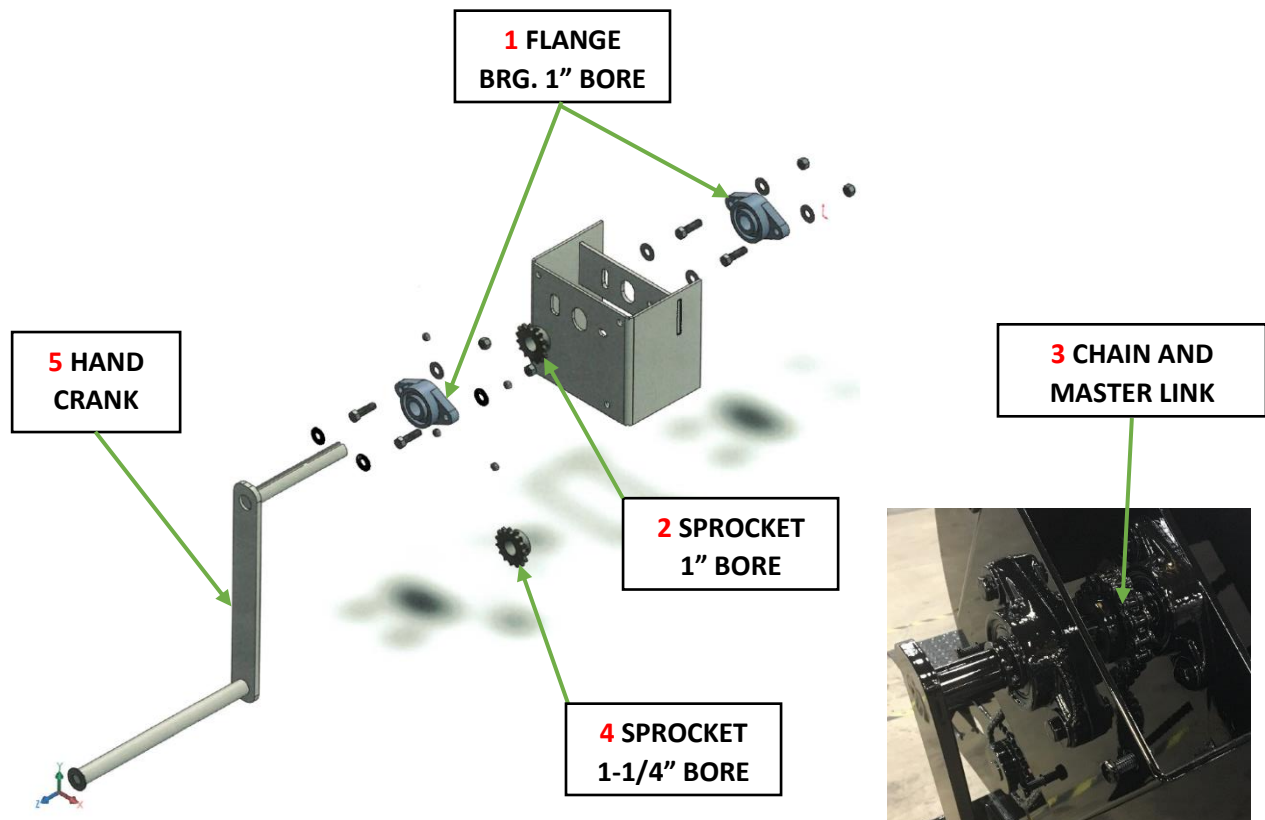

## MAINTENANCE AND STORAGE

### MAINTENANCE

During the lubrication stop, inspect all operating parts. Should any damage or excessive wear be evident, replace parts immediately. Straighten any parts as soon as possible. Clean and re-paint all exposed parts using touch-up kit P3020B034 **yellow** paint or touch-up kit P3020B033 **black** paint.

### STORAGE

Perform all required maintenance and lubrication procedures. Coat all shafts with grease. Clean and re-paint all exposed parts using touch-up kit P3020B034 **yellow** paint or touch-up kit P3020B033 **black** paint.

### Each touch-up kit includes:

1-pint paint can --- 1 pair of gloves --- 1 touch-up paintbrush

